



## Priory Heights Buckingham Avenue, Slough

Guide Price £260,000

**SAB**  
ESTATES





## Priory Heights

Buckingham Avenue, Slough

- Leasehold: 170 unexpired years
- Ground Rent: £0 pa
- Service Charge: £248 pcm
- Allocated Parking Space
- Private Balcony
- 5th Floor - Lift Available
- 1-min Walk from Burnham Station
- 732 sq ft / 68 sq m

Council Tax band: C

Tenure: Leasehold

EPC Energy Efficiency Rating: B

EPC Environmental Impact Rating: C



SAB Estates



SAB Estates



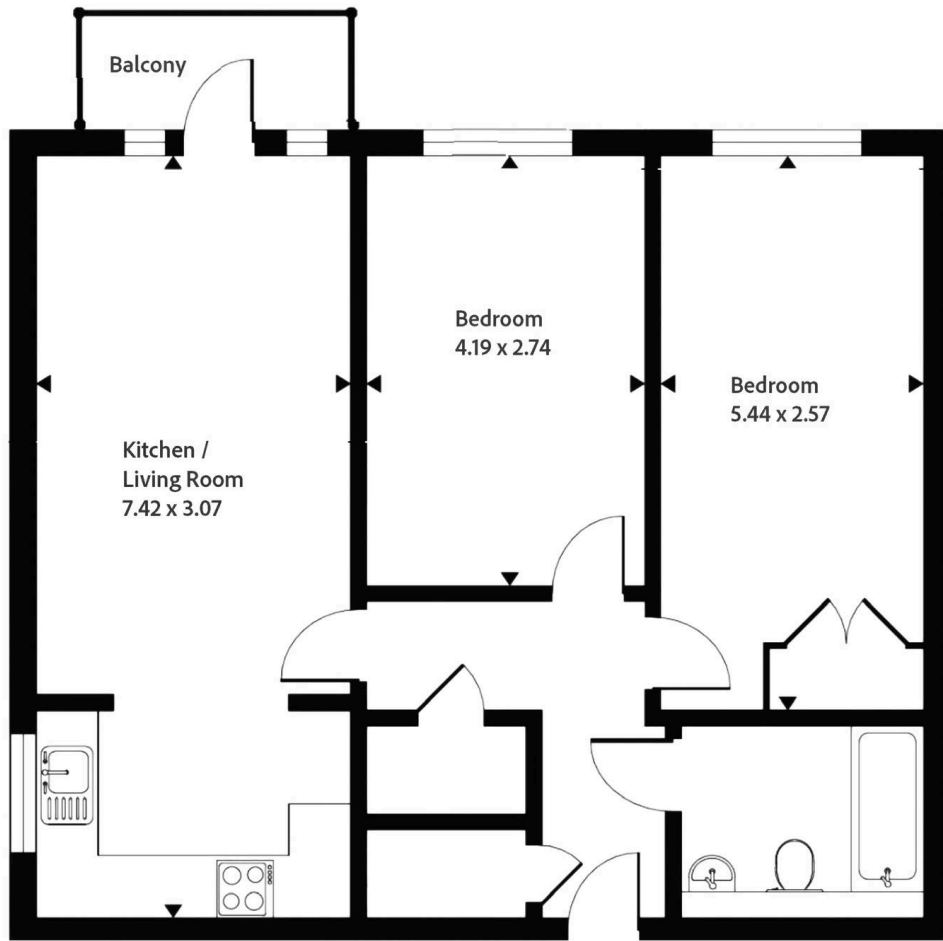





## SAB Estates

236-238 Ruislip Road, Greenford - UB6 9RS

020 8575 2929 • [info@sabestates.com](mailto:info@sabestates.com) • [www.sabestates.com/](http://www.sabestates.com/)