



## 12 Wentworth Road | Jump | Barnsley | S74 0JY

£150,000

Bell & Co Estates are excited to present this charming Three-Bedroom Semi-Detached Home, ideally situated in the heart of Jump, Barnsley, and offered with no onward chain. This property is perfect for those seeking a move-in-ready home with a versatile layout and modern touches. Welcoming entrance with an understairs storage cupboard. A contemporary kitchen featuring ample worktop and cupboard space, perfect for culinary enthusiasts or family meal prep. A versatile space that can be used as a dining room, playroom, or home office to suit your needs. A spacious lounge with a cozy fire and surround, plus French doors that open directly onto the rear patio—ideal for indoor-outdoor living. Three Double Bedrooms, each bedroom is generously sized, offering comfortable living for family members or guests. A modern bathroom suite complete with a shower over the bath, wash basin, and WC, designed with style and convenience in mind. The property has been refreshed with new floor coverings throughout, providing a blank canvas ready for personalization. To the rear of the property is a spacious garden benefitting from a patio area accessible from the lounge, perfect for outdoor dining, relaxation, or hosting gatherings with artificial grass and spacious shed perfect for storage. To the side of the property is a gate which provides you access to the front of the property which benefits from a paved driveway. Located close to local amenities, transport links, and schools, this home is in a prime location for convenience and connectivity.



GROUND FLOOR  
426 sq.ft. (39.6 sq.m.) approx.

1ST FLOOR  
429 sq.ft. (39.9 sq.m.) approx.

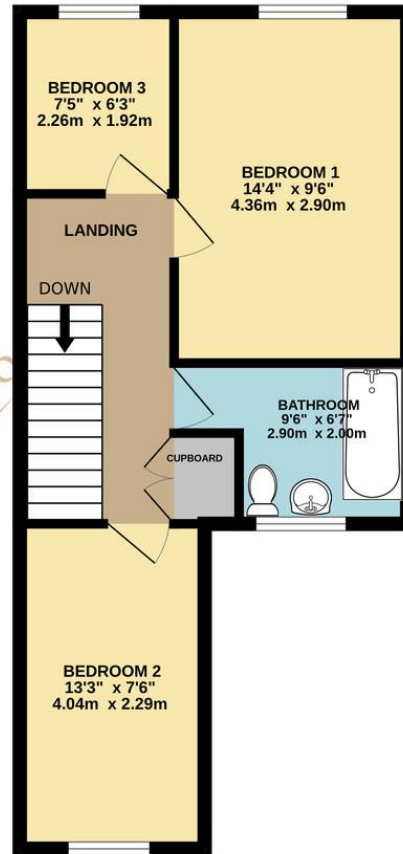

## Contact Details

79 Wales Road  
Kiveton Park  
Sheffield  
South Yorkshire  
S26 6RA

www.bellcoestates.com  
info@bellcoestates.com  
03333 580590

12, Wentworth Road  
Jump  
BARNSLEY  
S74 0JY

Energy rating

D

Valid until  
**9 March 2025**

Certificate number  
**0538-2830-7770-9995-7525**

**Property type** Semi-detached house

**Total floor area** 84 square metres

Agents Note: Whilst every care has been taken to prepare these sales particulars, they are for guidance purposes only. All measurements are approximate and for general guidance purposes only and whilst every care has been taken to ensure their accuracy, they should not be relied upon and potential buyers are advised to recheck the measurements