



12 Redwood Road, Loughborough

£225,000 Freehold

Newly available to the sales market, this two-bedroom home on Redwood Road is ideal for families and working professionals alike!

Newly available to the sales market, this two-bedroom home on Redwood Road is ideal for families and working professionals alike!

The property benefits from a handy entrance hallway, perfect for coats and shoes, which is brightened by a generously-sized window. The feeling of comfort provided by this delightfully characterful property only grows as you continue into the well-proportioned, light-filled living room, which features upgraded electrics, as well as glazed doors opening into the hallway and the kitchen.

The kitchen is well laid out, benefitting from U-shaped cabinetry with generous cupboard space, whilst featuring space for a freestanding washing machine, oven and fridge/freezer. This fantastic room also acts as a dining space, with enough space to comfortably house a six-seater table.

The upper floor of the property is home to two well-sized bedrooms, both measuring over three metres in length, as well as an upstairs bathroom, which features a bathtub with shower over, a large wash basin and a W/C.

Externally, the property is served by a two-car driveway, as well as gardens to the front and rear. The rear garden in particular is a highlight, with a recently upgraded patio area and generous lawn. The property is sited in a well-regarded residential location, with unbeatable access to Outwoods Edge Primary School, as well as local amenities including Tesco Extra and transport links such as the A6.

To view this special property in person, please contact Clare, Katie, Dominique or Ryan at the Edwards office to arrange your viewing.

Any fixtures, fittings or appliances mentioned in these details have not been tested and can not be assumed to be in full efficient working order. It should not be assumed that items shown in our photographs are included in the sale of the property. Although we have taken every care to ensure the dimensions for the property are true, they should be treated as approximate and for general guidance only. Where an offer is accepted, the prospective purchaser will be required to confirm their identity to us by law. We will need to see a passport or driving license along with a recent utility bill to confirm residence. These details and floor plans, although believed to be accurate, are for guidance only and prospective purchasers should satisfy themselves by inspection or otherwise to their accuracy. No individual within this estate agency has the authority to make or give any warranty in respect to the property. We believe you may benefit from using the services of Simpson Jones, Taylor Rose Solicitors, Idyll Mortgages, Near and Far and Jex Surveyors, the Provider(s), who are conveyancers, mortgage adviser, removals and surveyor respectively. We recommend sellers and/or potential buyers use the services of the Provider(s). Should you decide to use the services of the Provider(s) you should know that we would expect to receive a referral fee of between £50 and £144 from them for recommending you to them. You are not under any obligation to use the services of any of the recommended providers, though should you accept our recommendation the provider is expected to pay us the corresponding Referral Fee.

Council Tax band: B

Tenure: Freehold

EPC Energy Efficiency Rating: C

EPC Environmental Impact Rating: D



Hallway

Living Room

13' 4" x 9' 7" (4.07m x 2.92m)

Kitchen/Dining Room

8' 10" x 13' 0" (2.69m x 3.97m)

Landing

Bedroom One

10' 1" x 13' 0" (3.07m x 3.96m)

Bedroom Two

12' 4" x 6' 6" (3.76m x 1.99m)

Bathroom

6' 3" x 6' 3" (1.90m x 1.90m)



GROUND FLOOR
294 sq.ft. (27.3 sq.m.) approx.

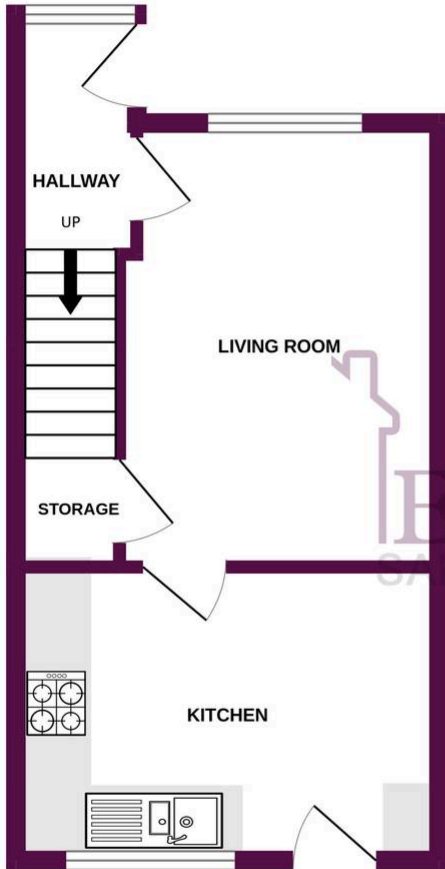

1ST FLOOR
282 sq.ft. (26.2 sq.m.) approx.

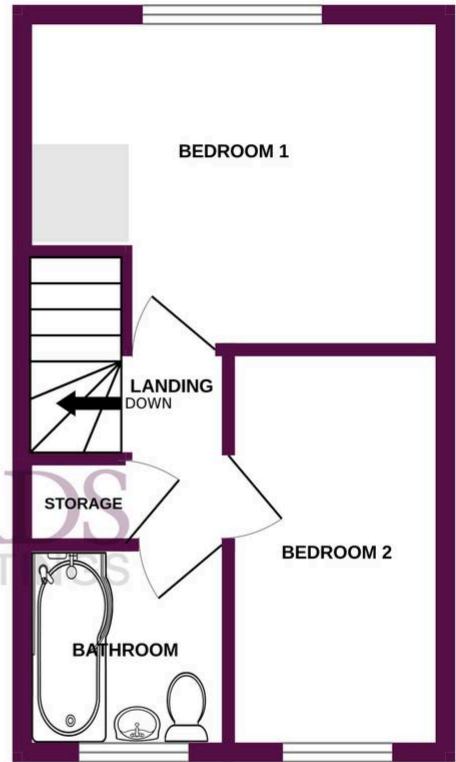

TOTAL FLOOR AREA : 576 sq.ft. (53.5 sq.m.) approx.

Whilst every attempt has been made to ensure the accuracy of the floorplan contained here, measurements of doors, windows, rooms and any other items are approximate and no responsibility is taken for any error, omission or mis-statement. This plan is for illustrative purposes only and should be used as such by any prospective purchaser. The services, systems and appliances shown have not been tested and no guarantee as to their operability or efficiency can be given.
Made with Metropix ©2024