

Crucible

Homes



Sheffield Road
Barnsley, S74 0DQ

Guide Price
£165,000

Overview

BEAUTIFULLY PRESENTED

Three bedrooms

Close to local amenities

Modern kitchen

Fully refurbished throughout

Excellent transport links



Description

SUMMARY DESCRIPTION

GUIDE PRICE £165,000-£175,000

Presenting this beautifully finished three bedroom mid terraced home in Hoyland, Barnsley.

Ideally located for commuting to Barnsley, Sheffield or even Rotherham. Less than a 5 minute drive to the M1 motorway and situated close to many shops and local amenities.

The accomodation breifley comprises; living room with storage/coat cupboard, newly fitted kitchen/diner, to the first floor two bedrooms and house bathroom with three piece white suite, and to the second floor master bedroom with storage cupboard. To the rear of the property is a low maintenance shared yard area.

This home would suit a wide range of buyers, including first time buyers and investors alike, and won't be around for long.

Contact the office today for a viewing.



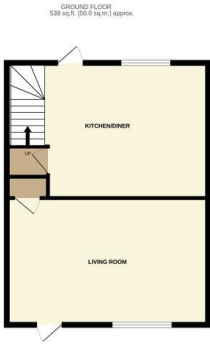

TOTAL FLOOR AREA: 1376 sq.ft. (127.8 sq.m.) approx.
Whilst every attempt has been made to ensure the accuracy of the floorplan contained here, measurements of doors, windows, stairs and any other items are approximate and no responsibility is taken for any error, omission or mis-statement. This plan is for illustrative purposes only and should be used as such by any prospective purchaser. The services, systems and appliances shown have not been fitted and no guarantee as to their operability or efficiency can be given. Made with Metropix ©2024

Score	Energy rating	Current	Potential
92+	A		
81-91	B		89 B
69-80	C	73 C	
55-68	D		
39-54	E		
21-38	F		
1-20	G		

PRS
Property Redress Scheme

