



Apt 2, 19 Gloucester Street, St. Helier, Jersey
£425,000

BROADLANDS
FINDING YOU A HOME SINCE 1972

Apartment 2, 19 Gloucester Street

- Completely renovated two bed apartment
- Twenty-one foot open plan living room / kitchen
- Fully fitted kitchen with Bosch integrated appliances
- Video entry system
- Designated off road parking space
- Close to Waterfront, park beach, cafes and restaurants
- Sole agent
- WhatsApp Don 07829 917172 /
don@broadlandsjersey.com or Erica 07797 712094 /
erica@broadlandsjersey.com



Apartment 2, 19 Gloucester Street

A completely renovated two-bedroom apartment situated in a prime location close to the Waterfront, park, beach, cafes, and restaurants. The accommodation comprises a modern open plan living room and kitchen, two bedrooms, bathroom, dressing room, and cloakroom.

The top finish includes the introduction of recessed lighting, a video entry system, app controlled electric radiators, and integrated Bosch appliances in the fully fitted kitchen.

Parking is straightforward, as the apartment includes a designated off-road parking space.

With its prime location and quality finishes, this property is a must-see for those seeking a desirable living space in a sought-after area. Contact Broadlands the sole agent to arrange a viewing and make this apartment your new home.





Living

Spacious open plan living room / kitchen with high ceiling and three picture windows to front. Integrated appliances include hob, extractor, oven, microwave, fridge/freezer, dishwasher and washer/dryer. Tiled splashbacks.

Sleeping

Two bedrooms both with windows to rear. Bathroom featuring bath with shower over and basin. Dressing room with fitted storage unit and rail. Separate cloakroom.

Outside

Designated parking space to rear. The apartment is located in a prime location close to the Waterfront, park, beach, cafes, and restaurants.

Services

All mains excluding gas. New electric radiators controlled by an app. Colour video entry phone system.



FIRST FLOOR
706 sq.ft. (65.6 sq.m.) approx.

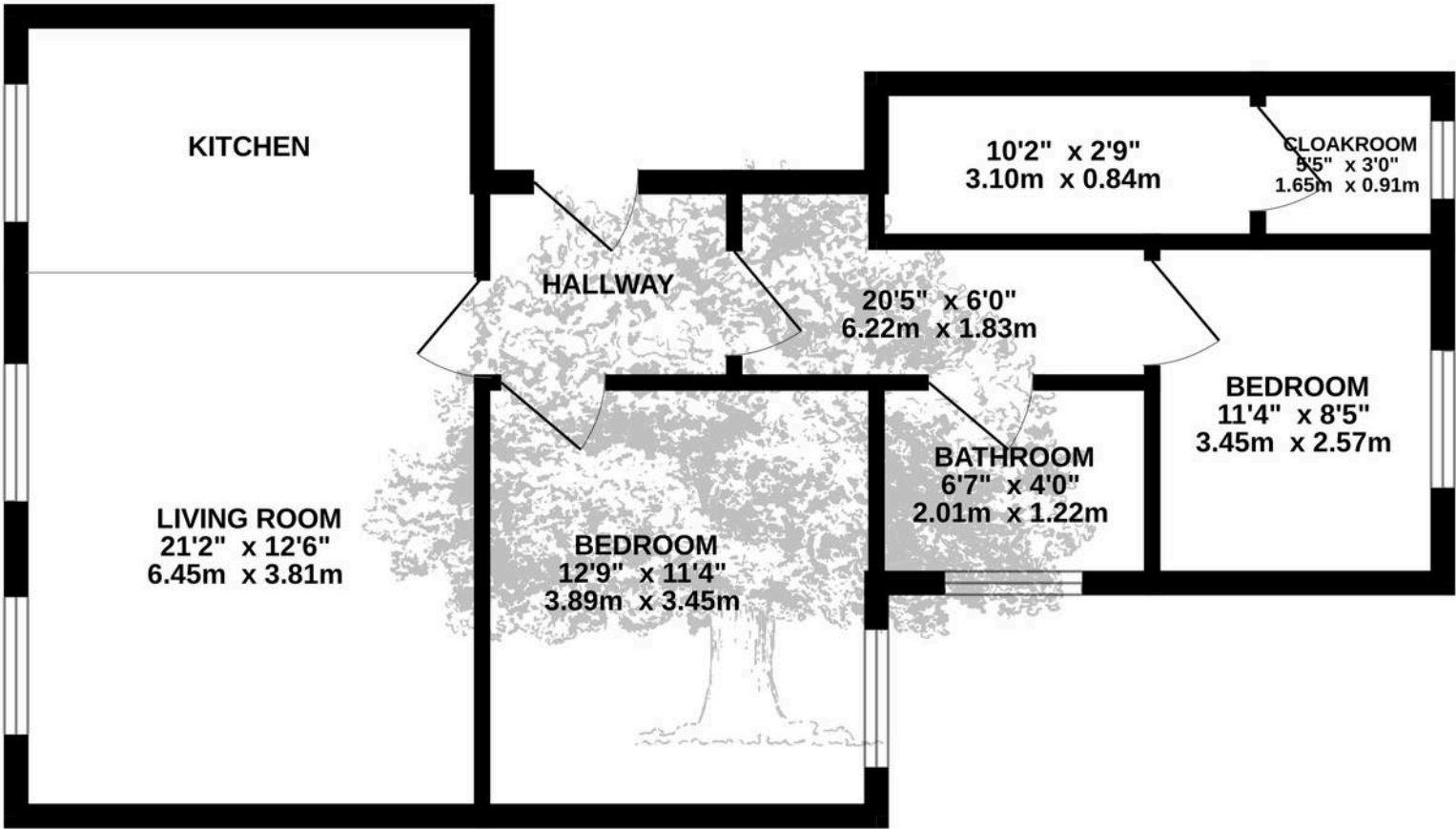

TOTAL FLOOR AREA : 706sq.ft. (65.6 sq.m.) approx.

Whilst every attempt has been made to ensure the accuracy of the floorplan contained here, measurements of doors, windows, rooms and any other items are approximate and no responsibility is taken for any error, omission or mis-statement. This plan is for illustrative purposes only and should be used as such by any prospective purchaser. The services, systems and appliances shown have not been tested and no guarantee as to their operability or efficiency can be given.
Made with Metropix ©2024



Broadlands

Broadlands Estates, Library Place - JE2 3NL

07829 917172 • don@broadlandsjersey.com • www.broadlandsjersey.com/

BROADLANDS

FINDING YOU A HOME SINCE 1972