



Bardwell Road, St. Albans



DAVID CHADWICK
ST ALBANS



38 Bardwell Road, St. Albans, AL1 1RJ

Entrance hall | Sitting room | Dining/family room | Kitchen | Two double bedrooms | Bath/shower room | Gardens | Council Tax Band D - £2,155.11 p.a. | EPC rating D | Tenure - Freehold

The Property

A pretty Victorian terraced cottage situated in a central conservation area cul-de-sac location within easy reach of the city centre, mainline station, well-regarded schools and extensive local amenities.

This delightful Victorian terraced cottage offers well-presented, spacious accommodation over three floors. The ground floor includes an entrance hall and two separate reception rooms, a well-proportioned sitting room with an attractive feature fireplace and plantation shutters to

to the front, and a generous dining/family room, leading to a modern kitchen, at the rear, also with a feature fireplace and stripped wooden floorboards.

To the first floor a landing provides access to two comfortable double bedrooms, the larger of the two at the front of house benefits from fitted wardrobes and plantation shutters. A beautifully appointed bathroom, with a roll top claw foot bath and separate walk-in shower enclosure, completes the picture on this floor. To the second floor, with ladder access via a hatch from bedroom 2, is a useful loft room, currently used as a home office, there is a fitted work bench, two skylights to the rear and eaves storage to the eaves both front and back.

The house sits behind a pretty brick-built façade and townhouse style garden. To the rear of the house is a delightful garden, arranged over two levels, both laid to paving with raised and planted beds to the boundaries.



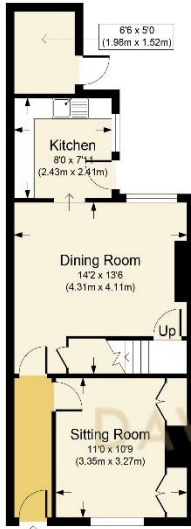

Ground Floor

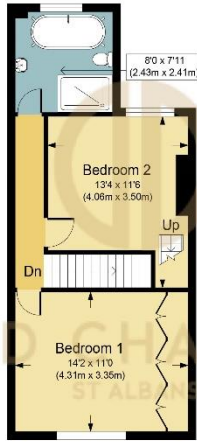

First Floor



Second Floor



BARDWELL ROAD, AL1

APPROX. GROSS INTERNAL FLOOR AREA 1011.80 SQ FT / 94.0 SQ M
DAVIDCHADWICK THIS IMAGE IS ILLUSTRATIVE ONLY. NOT TO SCALE. COPYRIGHT © THE IMAGE TALKER LTD. 2022



To confirm: These sales particulars have been prepared as a guide only. They are not a statement nor representation of fact. They do not form part of a contract. Room sizes are approximate, and floor plans are not to scale and should therefore not be relied on for the purposes of planning, architectural alterations, building works or for the ordering of materials, fixtures, fittings, floor/wall coverings and/or furnishings, whether freestanding or fitted. We have not carried out a survey nor tested the services or appliances. Prospective purchasers should satisfy themselves by inspection or otherwise.



DAVID CHADWICK
 ST ALBANS

david@davidchadwickstalbans.com
 Mobile 07859 768597
 Office 01727 857165

davidchadwickstalbans.com