



£250,000

26 DOVECOT CLOSE, GRISTHORPE, FILEY, YO14 9PY

- Detached Bungalow
- Two Bedrooms
- Master En Suite
- Garage And Gardens

A LARGE TWO BEDROOM DETACHED BUNGALOW SITUATED IN THIS PRETTY VILLAGE ON A PLEASANT CUL DE SAC. IN NEED OF UPDATING AND MODERNISATION THIS PROPERTY COULD BE A LOVELY HOME WITH SUPERB POTENTIAL.



TIPPLE UNDERWOOD ESTATE
AGENTS
3 Coldyhill Lane, Scarborough, North
Yorkshire, YO12 6SF

CONTACT
www.tippleunderwood.co.uk
01723 350299
mail@tippleunderwood.co.uk

Agents Note: Whilst every care has been taken to prepare these sales particulars, they are for guidance purposes only. All measurements are approximate and for general guidance purposes only and whilst every care has been taken to ensure their accuracy, they should not be relied upon and potential buyers are advised to recheck the measurements

GROUND FLOOR
1095 sq.ft. (101.7 sq.m.) approx.

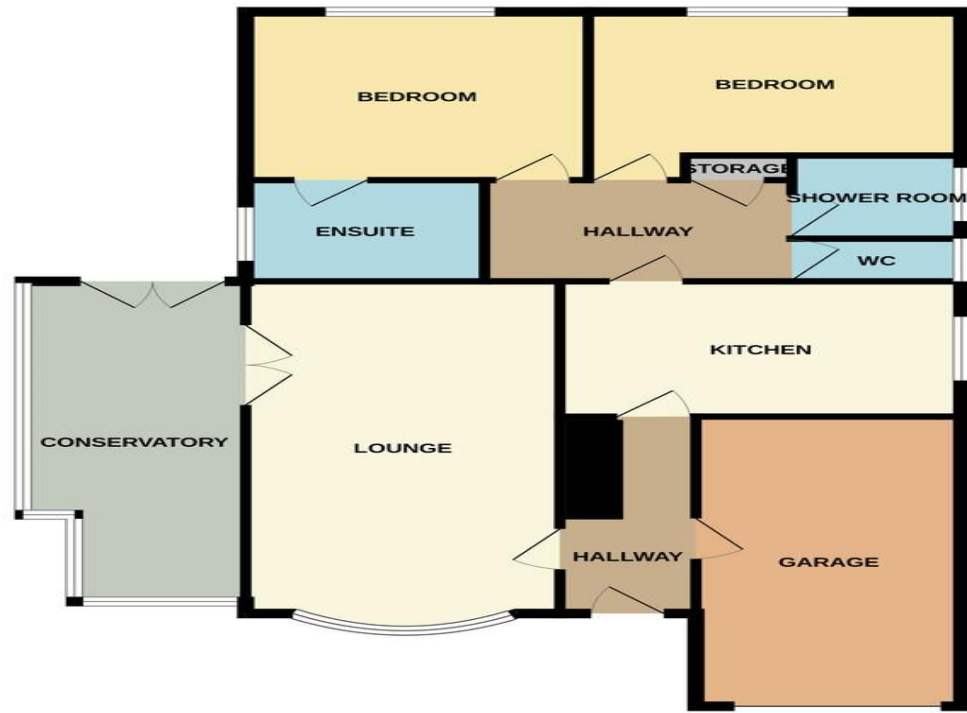

TOTAL FLOOR AREA: 1095 sq.ft. (101.7 sq.m.) approx.
Whilst every attempt has been made to ensure the accuracy of the floorplan contained here, measurements of doors, windows, rooms and any other items are approximate and no responsibility is taken for any error, omission or mis-statement. This plan is for illustrative purposes only and should be used as such by any prospective purchaser. The services, systems and appliances shown have not been tested and no guarantee as to their operability or efficiency can be given.
Made with Metropix ©2024



Property Description

The property when briefly described comprises, entrance hall, lounge, conservatory, kitchen, inner hall, two double bedrooms, master with en suite, shower room and separate w/c. To the outside of the property are gardens to three sides, timber shed and large integrated garage.



GROUND FLOOR

ENTRANCE HALL

LOUNGE
20' 6" x 10' 9" (6.25m x 3.28m)

CONSERVATORY
19' 9" x 7' 7" (6.02m x 2.31m) max

KITCHEN
13' 9" x 8' 5" (4.19m x 2.57m)

INNER HALL

MASTER BEDROOM
11' 10" x 10' 9" (3.61m x 3.28m)
ENSUITE

BEDROOM
12' 9" x 8' 10" (3.89m x 2.69m)

SHOWER ROOM

WC

INTEGRAL GARAGE
17' 10" x 9' (5.44m x 2.74m)

OUTSIDE

GARDENS

NOTE

Gas has been capped off at the property