





10 Lyons Lane

Appleton, Warrington

An impressive detached period house with separate annex/apartment, in a private and elevated position on one of the town's foremost roads within easy reach of the village centre with all of its amenities.

Council Tax band: G

Tenure: Freehold

EPC Energy Efficiency Rating: E

- Beautifully remodelled throughout including a separate annex/apartment over the garage
- Large landscaped third of an acre grounds with electric gates, adjoining the Cricket Club at the rear
- Six bedrooms and four bathrooms in all
- An impressive detached period home on a very sought after and prestigious road



GROUND FLOOR
1912 sq.ft. (177.7 sq.m.) approx.

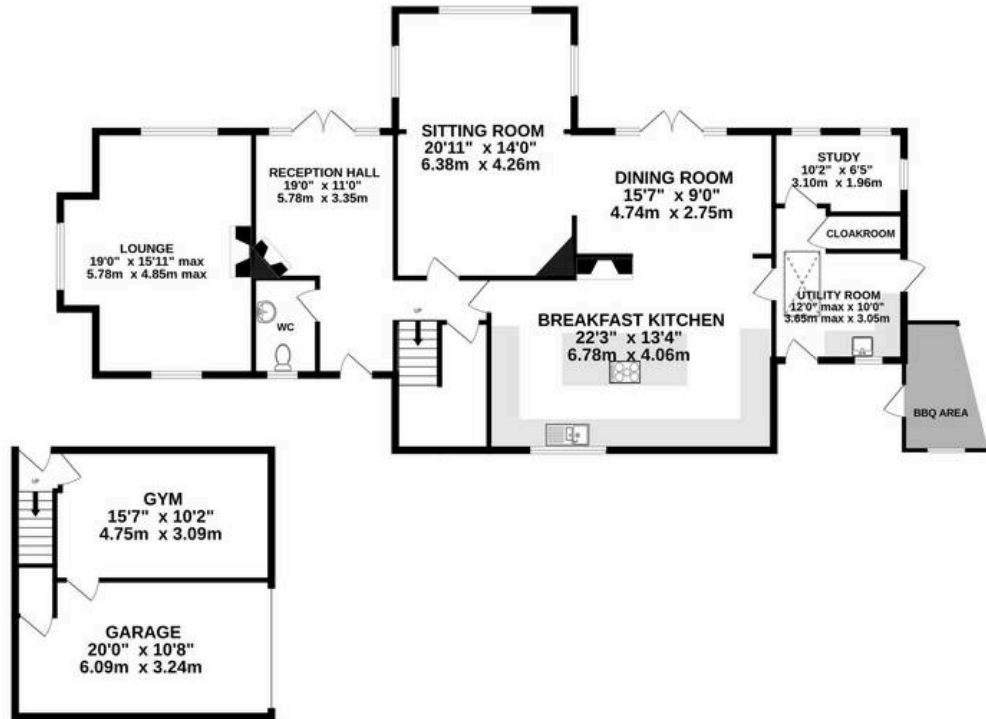

1ST FLOOR
1664 sq.ft. (154.6 sq.m.) approx.

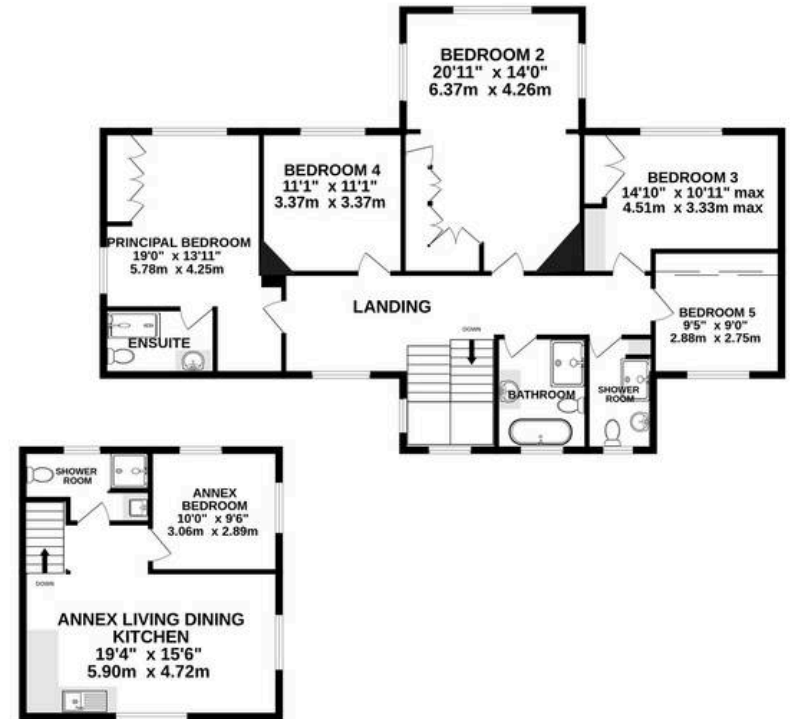

TOTAL FLOOR AREA : 3576 sq.ft. (332.2 sq.m.) approx.

Whilst every attempt has been made to ensure the accuracy of the floorplan contained here, measurements of doors, windows, rooms and any other items are approximate and no responsibility is taken for any error, omission or mis-statement. This plan is for illustrative purposes only and should be used as such by any prospective purchaser. The services, systems and appliances shown have not been tested and no guarantee as to their operability or efficiency can be given.

Made with Metropix ©2024



Stuart Rushton & Company

Stuart Rushton & Co, 35 King Street – WA16 6DW

01565 757000

enquiries@srushton.co.uk

www.srushton.co.uk



**Stuart
Rushton**
& COMPANY

We are not authorised to make or give any representations or warranties in relation to the property either here or elsewhere. We assume no responsibility for any statement that may be made in these particulars, and they do not form part of any offer or contract and must not be relied upon as statements or representation of fact. Any areas, measurements or distances are approximate. The text, photographs and plans are for guidance only. Importantly, it should not be assumed that the property has all necessary planning, building regulations or other consents and we have not tested any services, equipment or facilities. Purchasers must satisfy themselves by inspection or otherwise.