

S&B



2 Bedroom Semi-Detached Family Home Ashcombe Square, New Malden. £550,000 Freehold

Newly Built just 2 years ago, a beautifully presented, 2 bedroom Semi-Detached Family home, set within a quiet cul-de-sac location in Ashcombe Square, New Malden.

This stunning 2 bedroom home is presented to an exceptionally high standard with modern designs and a contemporary feel.

The open Plan, reception / kitchen / dining room is spacious, with double aspect with bi fold doors opening out to the private garden.

The modern kitchen has fully integrated appliances and subway tiling.

On the first floor there are two spacious bedrooms and a luxury bathroom.

Downstairs Cloakroom, Off Road Driveway Parking,

Spacious Garden with pedestrian side access.

Offered to the market, chain free.

WWW.STACKANDBONNER.COM

020 8974 8844

sales@stackandbonner.com



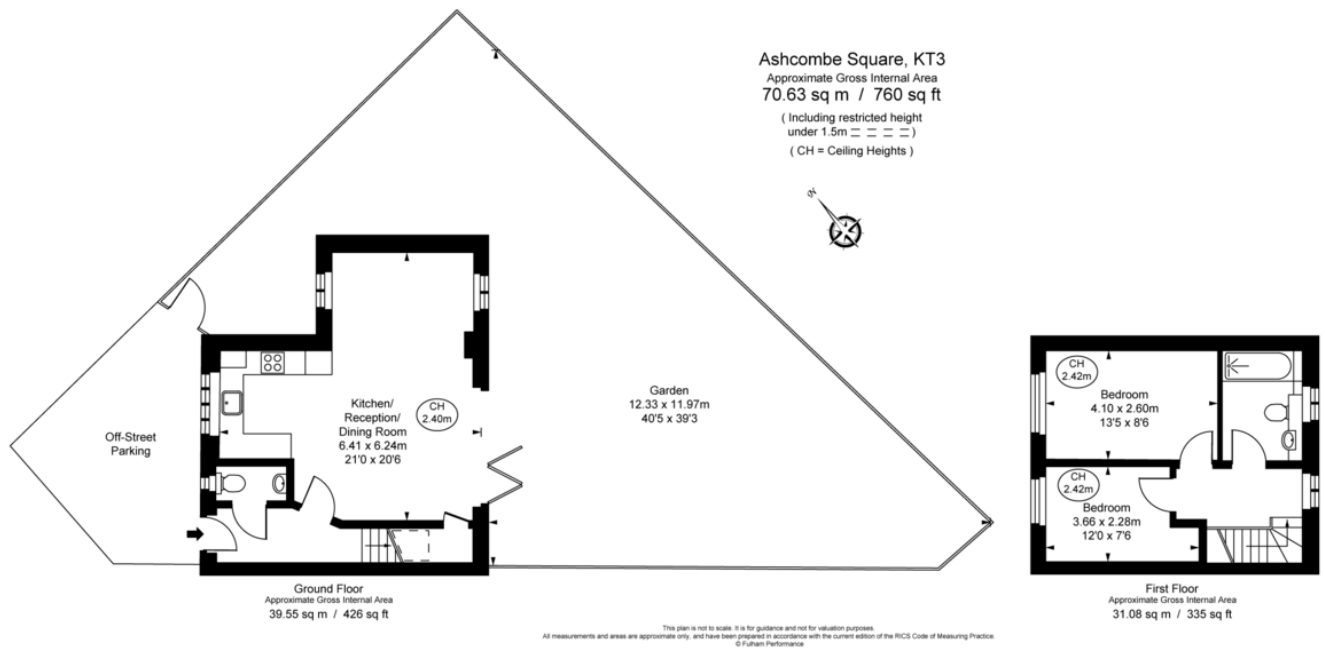

- 2 Bedroom Semi-Detached Family Home
- Presented to an exceptionally high standard
- Modern Feel with contemporary designs
- Open Plan Living / Kitchen / Dining Room
- Bi fold doors opening to the private garden
- 2 Double Bedrooms
- Luxury Bathroom
- Downstairs Cloakroom
- Private Garden
- Off Road Parking
- No Onward Chain