



43 Wesley Road | Kiveton Park | S26 6RJ

Guide Price £150,000 to £160,000

Bell & Co Estates are delighted to present this stunning, three-bedroom mid-terrace home located in the heart of Kiveton Park. In brief, the property comprises a cosy front-facing lounge featuring an elegant electric fire as a focal point. Double doors lead into the spacious dining room, seamlessly flowing into the modern fitted kitchen, which offers ample storage and workspace. On the first floor, you will find two generously sized bedrooms, both offering plenty of natural light. The modern family bathroom is well-appointed with a walk-in shower, bath, WC, and sink unit, designed for convenience and relaxation. Moving up to the second floor, there is a further double bedroom, providing additional space and privacy. Externally, the property offers on-street parking to the front, while the rear boasts a low-maintenance garden with a patio area and astro-turf, perfect for outdoor dining or simply relaxing in the sunshine. Situated close to local amenities, schools, and transport links, this home is in a prime location.

- Modern Three Bedroom End Terraced
- Beautifully Presented
- Front Facing Lounge
- Separate Dining Room
- Kitchen With Integrated Appliances
- Private Rear Garden



GROUND FLOOR
429 sq.ft. (39.8 sq.m.) approx.

1ST FLOOR
436 sq.ft. (40.5 sq.m.) approx.

2ND FLOOR
255 sq.ft. (23.7 sq.m.) approx.

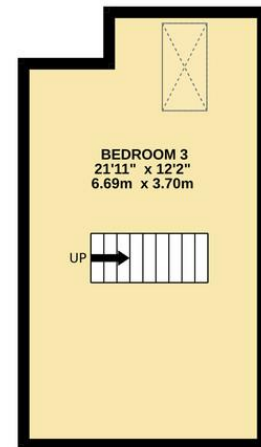
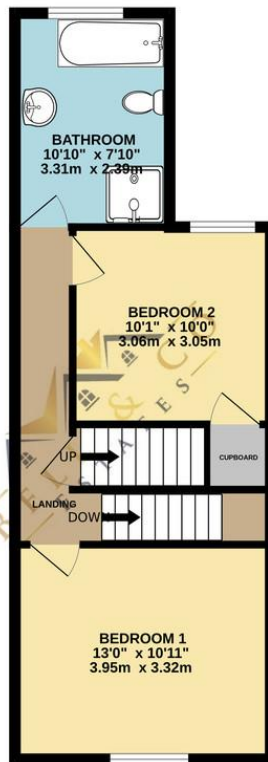
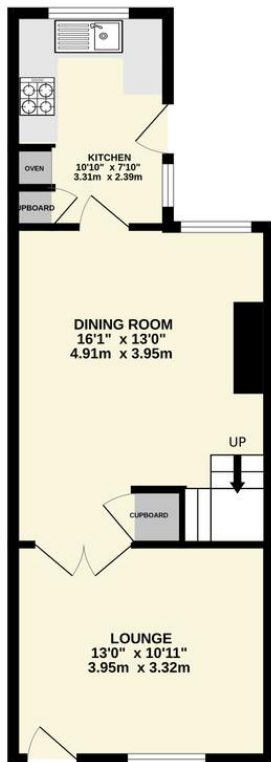

Contact Details

79 Wales Road
Kiveton Park
Sheffield
South Yorkshire
S26 6RA

www.bellcoestates.com
info@bellcoestates.com
03333 580590

43 Wesley Road
Kiveton Park
SHEFFIELD
S26 6RJ

Energy rating

D

Valid until
13 October 2034

Certificate number
2189-5410-1171-4785-6712

Property type End-terrace house

Total floor area 105 square metres

Agents Note: Whilst every care has been taken to prepare these sales particulars, they are for guidance purposes only. All measurements are approximate and for general guidance purposes only and whilst every care has been taken to ensure their accuracy, they should not be relied upon and potential buyers are advised to recheck the measurements