



**Berry Road, Paignton**

Paignton

Guide Price **£325,000**

ABSOLUTE



## Berry Road

Paignton,

Recently renovated high spec property with open plan living area, stylish kitchen, 3 double bedrooms, walk-in wardrobe, en-suite, family bathroom, underfloor heating, workshop, and a versatile chalet/office room in the rear garden.

Driveway parking.

Council Tax band: B

Tenure: Freehold

EPC Energy Efficiency Rating: E

EPC Environmental Impact Rating: E

- Stunning renovated family home
- Three double bedrooms
- En-suite shower room
- Downstairs WC
- Extended, stylish kitchen/breakfast room
- Quartz worktops and high quality integrated appliances
- Modern family bathroom
- Workshop, low maintenance gardens and off road parking
- Underfloor heating on the ground floor
- Recently built garden chalet



# Berry Road

Paignton,

The property is located in a popular residential area, being convenient for access to bus services, and local amenities. Paignton town centre is just over a mile away, with its choice of local shops, cafes and restaurants. Torbay has a choice of wonderful beaches and an attractive coastal footpath connecting the nearby towns of Brixham and Torquay. There is a branch-line train station in Paignton town centre, connecting to the mainline station in Newton Abbot.

## Absolute Sales & Lettings

Absolute Sales & Lettings, 27 Hyde Road - TQ4 5BP

01803 890110

[paignton@movewithabsolute.co.uk](mailto:paignton@movewithabsolute.co.uk)

<http://www.movewithabsolute.co.uk>



### Ground Floor

Approx. 79.6 sq. metres (857.2 sq. feet)

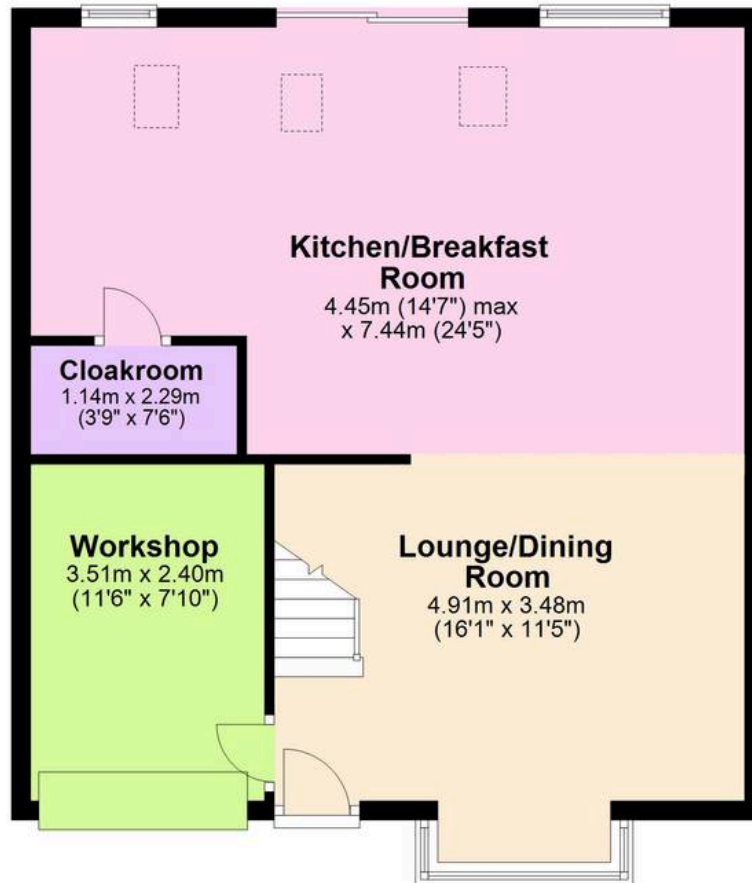
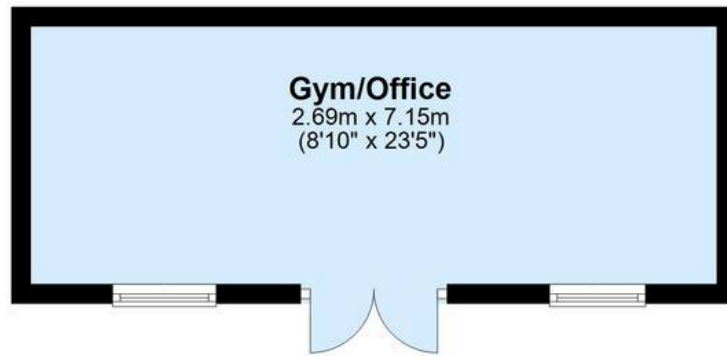

### First Floor

Approx. 47.6 sq. metres (512.3 sq. feet)



Total area: approx. 127.2 sq. metres (1369.5 sq. feet)

Approx  
Plan produced using PlanUp.

