

LANCASTER
SAMMS

3 Drakes Close, Huntington

York

£695,000



A truly elegant family home occupying a choice position within the exclusive, Bishops Manor development in the favoured Old Village of Huntingdon. Offered to the market for the first time since new.

Internally, the beautifully appointed accommodation comprises of an entrance hallway with cloakroom/WC and the principal reception rooms. To the front elevation is a bright, spacious living room with feature gas fireplace and surround. Double glass doors lead through to a stylish dining room with sliding doors direct onto the rear patio.

Off the hallway is access to the high specification kitchen, featuring ample wall and base units complemented by quartz worksurfaces, solid oak flooring and a double oven with extractor over. A range of Bosch integrated appliances including fridge/freezer, wine cooler and dishwasher add to the modern touches of this home. The kitchen space is also inclusive of a handy breakfast bar and stools.

A utility room sits alongside the kitchen, which includes a further sink plus access to the double garage.

Finishing off the ground floor accommodation to the rear of the property is a garden room. Offering an abundance of natural light from the glass windows, skylight and bi-fold doors onto the garden help to bring the outside in. A perfect place to enjoy all the seasons.

To the first floor are four generously sized double bedrooms, two complete with fitted wardrobes. The master bedroom also boasts a three piece ensuite shower room. A further house bathroom including free standing bath tub, completes the upstairs accommodation.

Externally the grounds have been immaculately maintained. A sweeping driveway to the front of the house offers ample parking for two cars plus access to the double garage. A mature hedge and two well shaped conifers help to provide privacy and add to the visual of the property. To the rear are multiple seating and dining spaces within the well loved south facing garden. While mainly laid to lawn, the inclusion of low maintenance hedges, shrubs and trees plus well stocked borders make this garden a perfect place to enjoy year round.

Drakes Close forms part of the exclusive Bishops Manor development on the edge of countryside within the popular suburb of Huntington just 3 miles north of York City Centre. Just moments away are peaceful family and dog walks and the historic All Saints Church.

Council Tax band: F

Tenure: Freehold









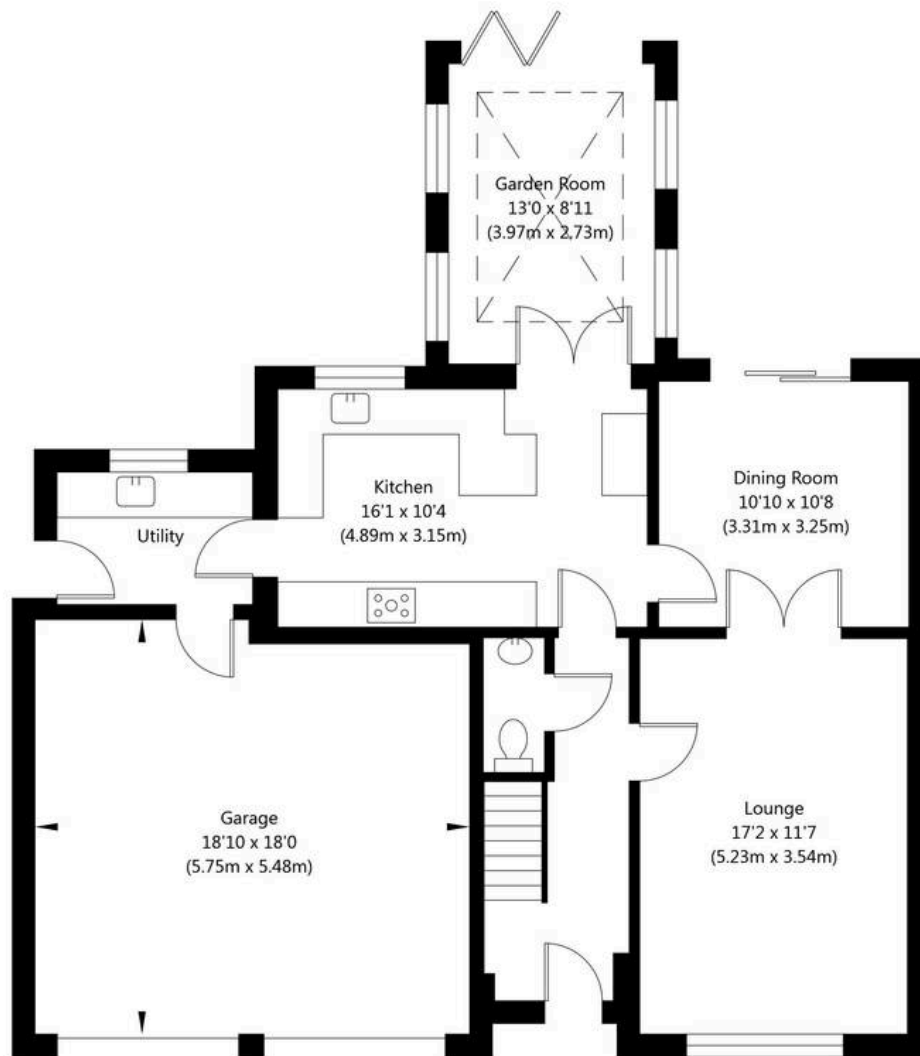

Ground Floor - (Excluding Garage)
GROSS INTERNAL FLOOR AREA
APPROX. 782 SQ FT / 72.68 SQ M

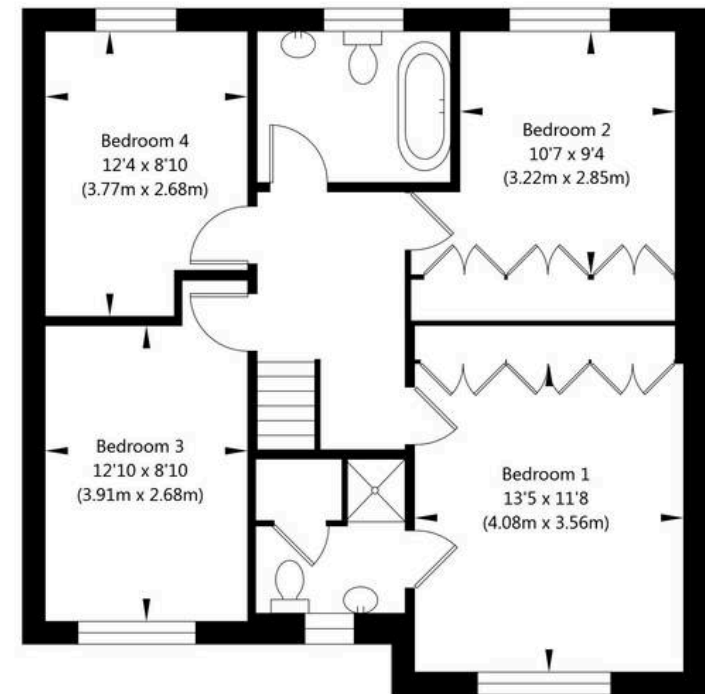

First Floor
GROSS INTERNAL FLOOR AREA
APPROX. 727 SQ FT / 67.57 SQ M

NOT TO SCALE - FOR ILLUSTRATIVE PURPOSES ONLY
APPROXIMATE GROSS INTERNAL FLOOR AREA 1509 SQ FT / 140.25 SQ M - (Excluding Garage)
All measurements and fixtures including doors and windows are approximate and should be independently verified.
www.exposurepropertymarketing.com © 2024





Lancaster Samms

27 High Petergate, York – YO1 7HP

01904 500455

info@lancastersamms.co.uk

www.lancastersamms.co.uk/

LANCASTER
SAMMS