

S&B



2 Bedroom Apartment Queenshurst Square, Kingston Upon Thames. £699,950 Leasehold

Overlooking the landscaped internal gardens of Queenshurst Square, a stunning and immaculately presented 2 bedroom apartment is offered to the market for sale.

Located on the 2nd floor in a tranquil location, with 763 sq ft of internal living space.

Contemporary open plan living accommodation with a spacious living, dining room and a high specification modern designed kitchen with integrated appliances.

2 double bedrooms both with views over the internal gardens, 2 luxury bathrooms [one ensuite]

The property is offered to the market with secure underground parking and no onward chain.

Benefits for Queenshurst Square residents include, 24-hour concierge service, landscaped communal garden with water features, residents' gym, residents screening room, Wi-Fi and media room, Queenshurst Square, is conveniently located for Kingston Mainline Station, the River Thames and Kingston's Historic Town Centre. Nearby are an abundance of restaurants and coffee shops, ideal for alfresco dining on the riverside.

This stunning apartment is offered to the market chain free.

WWW.STACKANDBONNER.COM

020 8974 8844

sales@stackandbonner.com



Hamond Court,
Queenshurst Square, KT2
Approximate Gross Internal Area
70.90 sq m / 763 sq ft
(CH = Ceiling Heights)

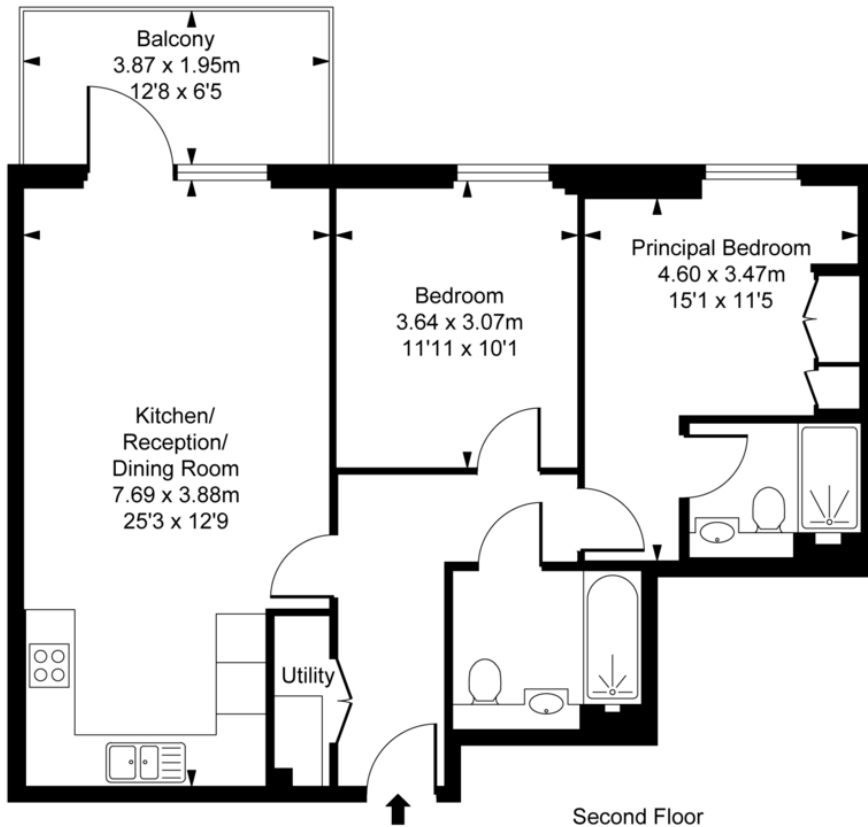

This plan is not to scale. It is for guidance and not for valuation purposes.
All measurements and areas are approximate only, and have been prepared in accordance with the current edition of the RICS Code of Measuring Practice.
© Fulham Performance

- 2 Bedroom Contemporary Apartment
- Overlooking Landscaped Internal Garden
- Open Plan Living accommodation
- Two Double Bedrooms
- Two Luxury Bathrooms (One En Suite)
- Fitted Wardrobes to the Principal Bedroom
- Private Balcony
- 2nd Floor
- 763 sq ft
- Concierge Service
- Residents Gym
- Residents Screening Room and Media Room
- Service Charge – £4,219.32 per annum
- Ground Rent: £425 per annum
- Lease: 994 years remaining
- Council Tax: Band E - £2,901.95 per annum