

Crucible Homes



Johnson Lane
Sheffield, S35 9XG

TO LET
£850PCM

Overview

AVAILABLE NOW

NO PETS OR SMOKERS

EXTREMELY WELL PRESENTED HOME

ENCLOSED REAR YARD

GREAT LOCATION

CLOSE TO AMENITIES



Description

Crucible Homes are delighted to market this two bedroom mid terraced home available to rent in Ecclesfield.

The accommodation briefly comprises; entrance hallway, living room, kitchen diner with storage/pantry, rear enclosed yard, two good sized bedrooms and bathroom with three piece white suite.

The home is filled with natural light and has been neutrally decorated throughout, in great condition. Within close proximity to shops, pubs and supermarkets and a 5 minute drive to the M1 motorway, this property is ideal for those who commute for work and benefit from a large abundance of amenities.

Call the office today for a viewing.



GROUND FLOOR

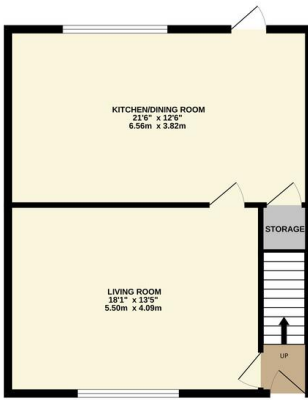

1ST FLOOR

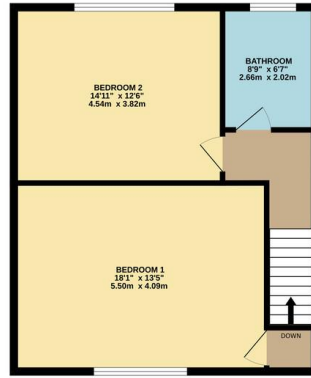

Whilst every attempt has been made to ensure the accuracy of the floorplan contained herein, measurements of doors, windows, stairs and any other items are approximate and no responsibility is taken for any error, omission or mis-statement. This plan is for illustrative purposes only and should be used as such by any prospective purchaser. The services, systems and appliances shown have not been tested and no guarantee as to their operability or efficiency can be given.
Made with Metropix ©2024

Score	Energy rating	Current	Potential
92+	A		
81-91	B		83 B
69-80	C		
55-68	D	62 D	
39-54	E		
21-38	F		
1-20	G		

