



29 Ellis Road, Broadbridge Heath

Guide Price £525,000

29 Ellis Road

Broadbridge Heath, Horsham

Three storey four bedroom three bathroom family home.

To the ground floor is an entrance hall with convenient WC. The modern kitchen is finished to a high specification with fitted wall and base units and integrated appliances. The spacious living/dining room provides a great space for entertaining with light flooding through from the sky lights and double French doors that lead out to the garden terrace.

On the first floor there are two large double bedrooms both benefitting from fitted wardrobes and en-suite. To the top floor there are two further bedrooms one with fitted wardrobes and an additional modern bathroom

The rear garden is laid to lawn accessed via the French doors with patio area and there is an allocated parking space.

The property is situated on the popular Wickhurst Green development in Broadbridge Heath, within easy access of excellent schools, major transport links, country walks and shops.

Council Tax band: E

EPC Energy Efficiency Rating: B

EPC Environmental Impact Rating: B

- **Four Bedrooms**
- **Three Bathrooms**
- **Modern Kitchen**
- **Located on the Popular Wickhurst Green Development**
- **Spacious Living Area**
- **Allocated Parking**
- **Three Storey Townhouse**

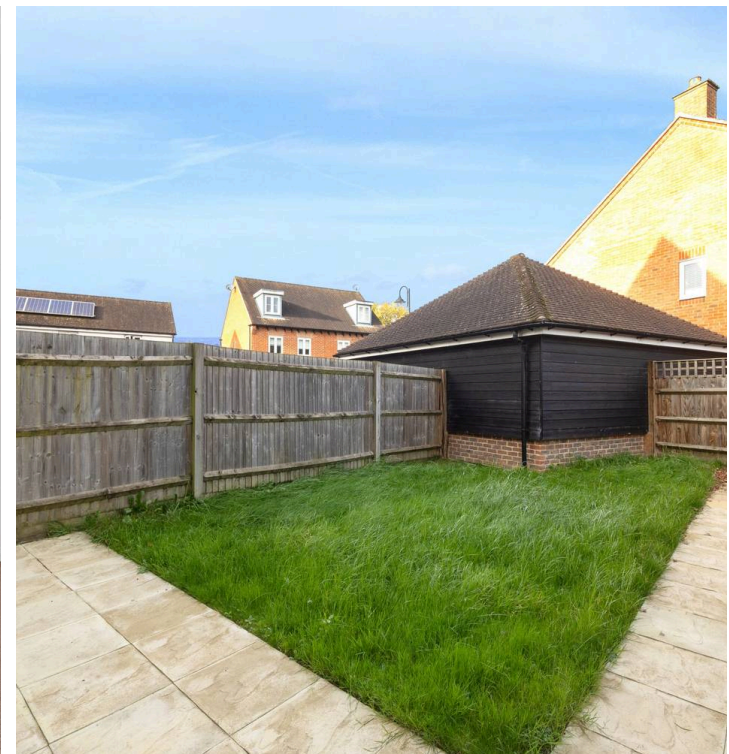

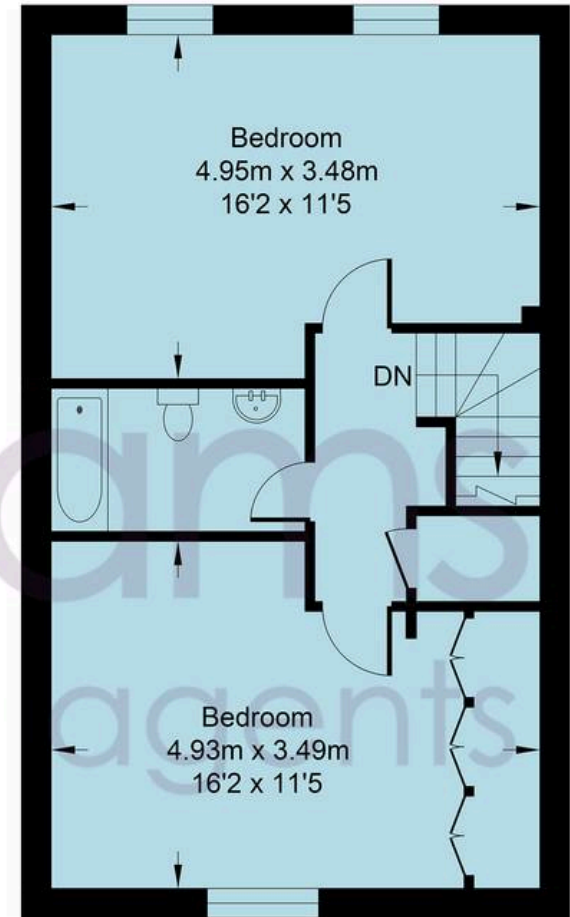
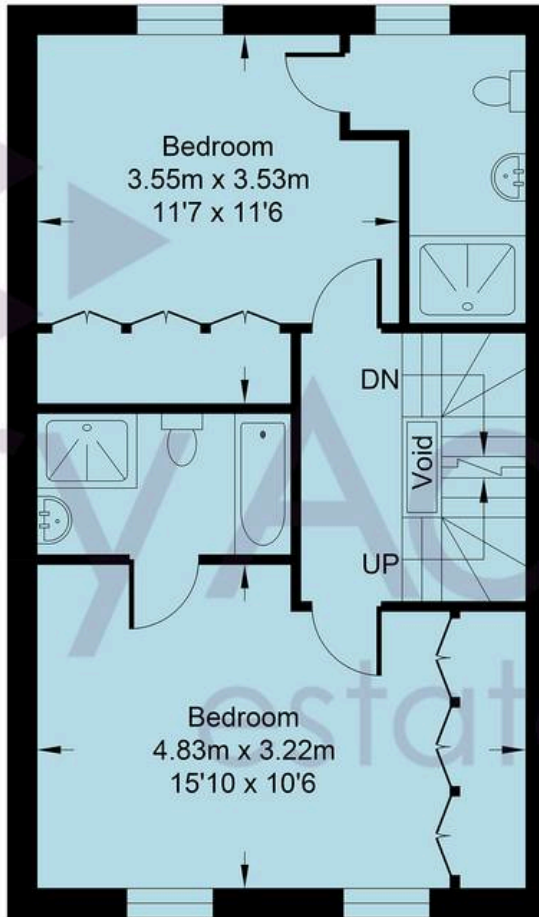
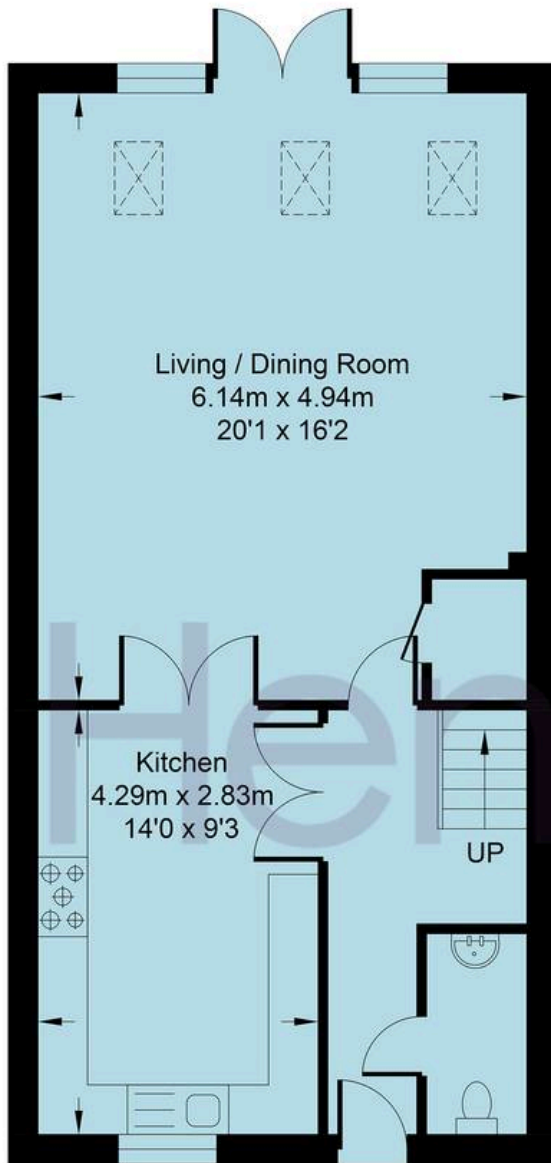

Ellis Road

Approximate Area = 1477.88 sq ft / 137.30 sq m

Total = 1477.88 sq ft / 137.30 sq m

For identification only - not to scale



Henry Adams - Horsham

Henry Adams HRR Ltd, 50 Carfax, Horsham - RH12 1BP

01403 253271

horsham@henryadams.co.uk

www.henryadams.co.uk/

Agents Note - Our particulars are for guidance only and are intended to give a fair overall summary of the property. They do not form part of any contract or offer, and should not be relied upon as a statement or representation of fact. Measurements, areas and distances are approximate only. Photographs may include lifestyle shots and pictures of local views. No undertaking is given as to the structural condition of the property, or any necessary consents or the operating ability or efficiency of any service, system or appliance. Please ask if you would like further information, especially before you travel to the property.