



67 Winstanley Road, Stamshaw

Portsmouth

Offers in Region of £235,000

 chinneckshaw



67 Winstanley Road

Stamshaw, Portsmouth

This beautifully presented 2-bedroom terraced property is located in the convenient North End area of Portsmouth. Upon entering, you are greeted by a semi-open plan living space, featuring a long bench storage, making it ideal for dining and entertaining. The living area is light and airy, with a window to the rear and a door leading to the kitchen. The kitchen is well-equipped with cream wall and floor units, contrasting countertops, and space for a washing machine, dishwasher, and a tall fridge freezer. A small lobby offers access to the garden and the bathroom, which boasts a modern white suite, a bath with a shower, a chrome towel rail, and a window to the rear.

Upstairs are two double bedrooms: the front room includes an alcove for storage, while the back room, currently used as an office, has built-in storage and a window to the rear. The courtyard-style garden features a shed for storing the summer BBQ.

Decorated in simple, crisp tones throughout, this is the perfect starter home.

Council Tax band: B

Tenure: Freehold





Ground Floor

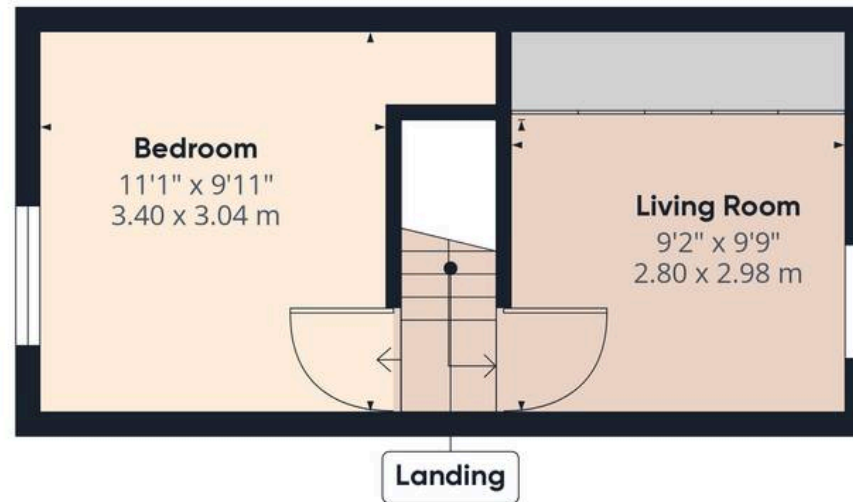

Floor 1

Approximate total area⁽¹⁾

688.02 ft²

63.92 m²

(1) Excluding balconies and terraces

While every attempt has been made to ensure accuracy, all measurements are approximate, not to scale. This floor plan is for illustrative purposes only.

Calculations are based on RICS IPMS 3C standard.

GIRAFFE 360



Chinneck Shaw

Bridge House, Milton Road, Portsmouth – PO3 6AN

023 9282 6731

hello@chinneckshaw.co.uk

www.chinneckshaw.co.uk/

Chinneck Shaw, Bridge House, Milton Road, PO3 6AN Consumer Protection from Unfair Trading Regulations 2008: These details are for guidance only and complete accuracy cannot be guaranteed. If there is any point which is of particular importance, verification should be obtained. They do not constitute a contract or part of a contract. All measurements are approximate. No guarantee can be given with regard to planning permissions or fitness for purpose. No apparatus, equipment, fixture or fitting has been tested. Items shown in the photographs are NOT necessarily included. Interested Parties are advised to check availability and make an appointment to view before travelling to see a property.