



8 Cranbourne Close  
Bridgwater, Somerset, TA6 3TR

**Brightest** move



# Brightest move

£215,000



Brightestmove are delighted to offer for sale this nicely positioned end terraced house which is situated on the northern outskirts of Bridgwater.

This two-bedroom home was originally built by 'Wimpey Homes' in the mid 1980's and is situated on a generous size plot.

The double-glazed accommodation is warmed by electric heating which includes four 'Fischer' radiators which were installed in 2018 under the benefit of a ten-year warranty.

The accommodation briefly comprises hallway, cloakroom/WC, kitchen and lounge/diner to the ground floor with two double bedrooms and refitted shower room upstairs.

Externally the property benefits from ample off-street parking to the front and side and rear gardens.





Bridgwater is an emerging town situated in the heart of the borough of Sedgemoor and within 11 miles of Taunton and 38 miles of Bristol. The town which is famed for its annual carnival is a thriving place with many new jobs being created in recent years.

For more information or an appointment to view please contact the vendors sole agents.

SERVICES: Mains electricity, water and drainage HEATING: Electric radiators

TENURE: Freehold COUNCIL TAX BAND: B

GROUND FLOOR

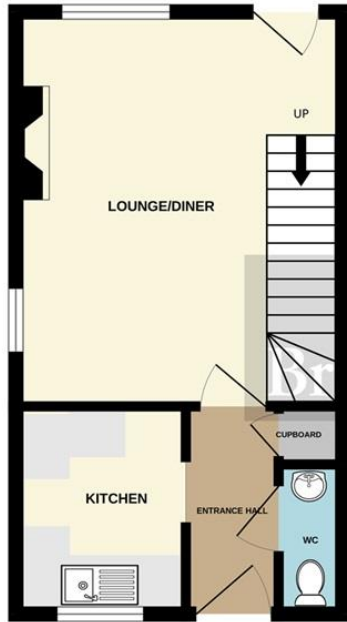

1ST FLOOR

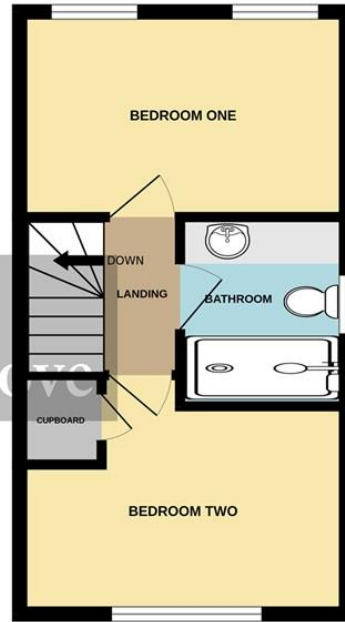

**Kitchen 8' 00" x 6' 06" (2.44m x 1.98m)**

**Lounge/Diner 15' 01" x 12' 07" (4.6m x 3.84m)**

**Bedroom One 12' 09" x 8' 01" (3.89m x 2.46m)**

**Bedroom Two 12' 07" (max) x 7' 05" (max) (3.84m x 2.26m)**

Energy rating TBA

No statement in these details is to be relied upon as representation of fact, and purchasers should satisfy themselves by inspection or otherwise as to the accuracy of the statements contained within. These details do not constitute any part of any offer or contract. CMH Southwest limited trading as Brightest Move and their employees and agents do not have any authority to give warranty or representation whatsoever in respect of this property. These details and all statements herein are provided without any responsibility on the part of CMH Southwest limited trading as Brightest Move or the vendors. CMH Southwest limited trading as Brightest Move has not tested the equipment or central heating system mentioned in these particulars and the purchasers are advised to satisfy themselves as to the working order and condition. Measurements: Great care is taken when measuring, but measurements should not be relied upon for ordering carpets, equipment, etc. This property sheet forms part of our database, and is protected by the database right and copyright laws. No unauthorised copying or distribution without permission.