



redrose

16 Worden Brook Close

Buckshaw Village, Chorley, PR7 7BU

Lovely bright one bedroom apartment in the attractive Worden Brook apartment block. Open plan living with patio doors to an Sunny balcony overlooking woodland to the rear, double bedroom, three piece bathroom suite and allocated parking to the rear. A great first time buy or investment property!

£85,995

EPC Rating '77'



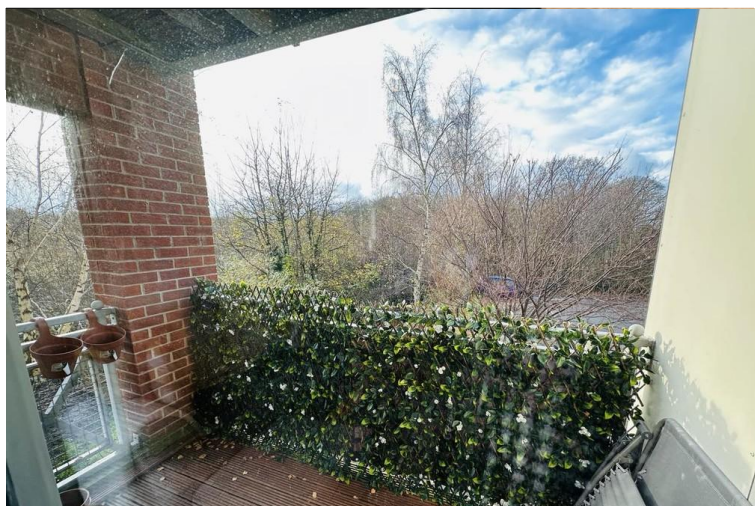

Property Description

COMMUNAL AREAS

Secure entry via intercom leads to the communal hallway, the property is located on the 1st floor.

HALLWAY

Ceiling light point, panelled doors leading to bedroom, bathroom and lounge. Wall mounted intercom and laminate flooring.

BEDROOM

12' 5" x 8' 10" (3.8m x 2.7m) Lovely feature circular double glazed window, ceiling light point and wall mounted heater.

LOUNGE/KITCHEN

18' 4" x 9' 6" (5.6m x 2.9m) Lovely bright open plan kitchen/lounge with double glazed sliding patio doors to balcony. A range of wall and base units in light beech with integrated dishwasher and space for washing machine, fridge and freezer, downlights, electric hob and single electric oven.





BATHROOM

5' 6" x 6' 6" (1.7m x 2.0m) Three piece bathroom suite with bath, low level WC and wash hand basin. Half tiled walls, ceiling light point and vinyl flooring.

PARKING

Allocated and visitor parking to the rear of the property.

REDROSE MORTGAGE SERVICES

If you would like a free mortgage consultation our in house financial adviser will be able to meet with you discuss your requirements and to assess your mortgage capability. You will receive professional and independent mortgage advice along with any other associated services.



Score	Energy rating	Current	Potential
92+	A		
81-91	B		
69-80	C	77 C	77 C
55-68	D		
39-54	E		
21-38	F		
1-20	G		

GROUND FLOOR

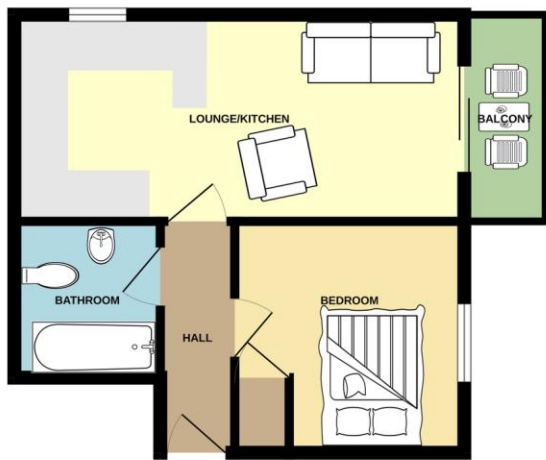

Whilst every attempt has been made to ensure the accuracy of the floorplan contained herein, measurements of such, including, notes and any other items are approximate and no responsibility is taken for any error, omission or misstatement. This plan is for illustrative purposes only and should not be used as such by any prospective purchaser. The accuracy, completeness and applicability of this plan has not been tested and no guarantee is given. Measurements are approximate and should not be relied upon. Made with Housify C2024

Redrose
15 Barnes Wallis Way
Buckshaw Village
Chorley
Lancs

www.redrosepm.co.uk
sales@redrose.co.uk
01772 456558

Agents Note: Whilst every care has been taken to prepare these sales particulars, they are for guidance purposes only. All measurements are approximate and are for general guidance purposes only and whilst every care has been taken to ensure their accuracy, they should not be relied upon and potential buyers are advised to recheck the measurements