



Maple Drive, St. Marys Bay

Romney Marsh

Guide Price **£325,000**



21 Maple Drive

St. Marys Bay, Romney Marsh

Charming 3-bed semi-detached house in St Marys Bay village. Spacious living room, dining area, kitchen, large conservatory. Mature gardens, driveway, garage. Short walk to local amenities and beach. Ideal family home.

Contact us to view.

Council Tax band: C

Tenure: Freehold

EPC Energy Efficiency Rating: D

EPC Environmental Impact Rating: D

- Three Bedroom
- Semi Detached House
- Large Living Space
- Conservatory
- Mature Garden
- Driveway
- Walking Distance to Village Centre



Porch

Hallway

Living Space

14' 1" x 11' 11" (4.29m x 3.63m)

Dining Space

11' 8" x 9' 9" (3.56m x 2.96m)

Kitchen

8' 2" x 12' 0" (2.48m x 3.65m)

Conservatory

13' 1" x 9' 7" (4.00m x 2.93m)

Landing

Bedroom

9' 11" x 12' 2" (3.02m x 3.72m)

Bedroom

9' 9" x 10' 11" (2.96m x 3.34m)

Bedroom

9' 2" x 7' 2" (2.79m x 2.19m)

Shower Room

6' 1" x 6' 8" (1.86m x 2.04m)





Ground Floor

Approx. 55.5 sq. metres (597.8 sq. feet)



First Floor

Approx. 39.9 sq. metres (429.2 sq. feet)

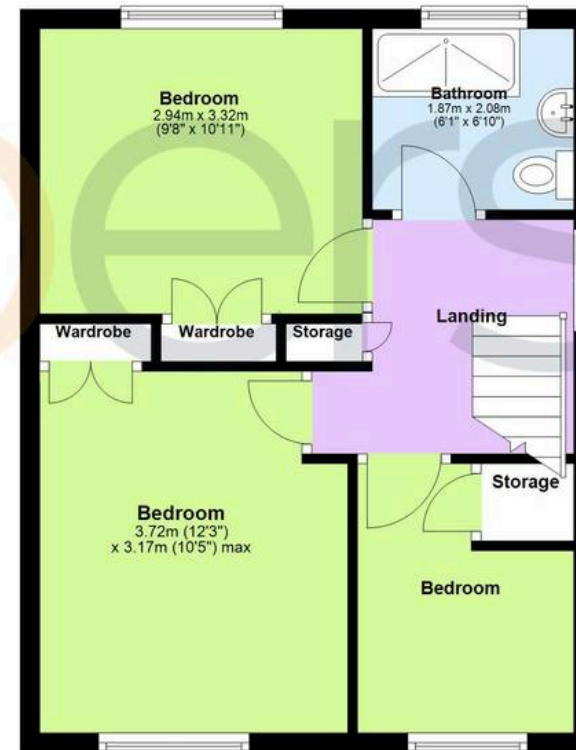

Total area: approx. 95.4 sq. metres (1027.0 sq. feet)



Skippers Estate Agents New Romney

55 High Street - TN28 8AH

01797 362898

Skippers