



CROWN

LETS 4 U

TO LET



Monthly £2,800

3 bedroom Terraced Longmead Road Tooting Broadway SW17

Crown Real Estate presents three-bedroom family home, offering a perfect blend of comfort, style, and convenience. This property has 3 bedrooms. Each bedroom is well-proportioned, with large windows that allow natural light to flood in, creating bright and airy spaces.

The heart of the home is the fully equipped kitchen, featuring high-end appliances, plenty of counter space, and stylish cabinetry. It's perfect for family meals and entertaining guests. The spacious living and dining areas flow seamlessly together, creating an ideal setting for both relaxed family time and more formal gatherings.

This property has a modern family bathroom. Property comes with its own private garden, offering plenty of space for children to play, gardening enthusiasts to cultivate, or simply relaxing in the sunshine.

This property is walking distance to Earlsfield Station and Tooting Broadway (Northern Line) station and all other local transport and shops.

NEWLY DECORATED

AVAILABLE NOW!

- **3 Double Bedrooms**
- **Modern Kitchen**
- **Private Garden**
- **Family Bathroom**
- **Laminated Flooring**
- **Fully equipped kitchen**
- **Closed to all local transport**
- **Walking distance to Earlsfield Station**

Croydon Office: Crown Lets 4u, 292 London Road, Croydon, Surrey, CR0 2TG

Tel: 020 8684 6677 **Mob:** 07540 874 532 **Fax:** 0872 115 6090 **Email:** info@crownlets4u.co.uk

www.crownlets4u.co.uk



Croydon Office: Crown Lets 4u, 292 London Road, Croydon, Surrey, CR0 2TG

Tel: 020 8684 6677 **Mob:** 07540 874 532 **Fax:** 0872 115 6090 **Email:** info@crowplets4u.co.uk

www.crowplets4u.co.uk

FLOOR PLAN

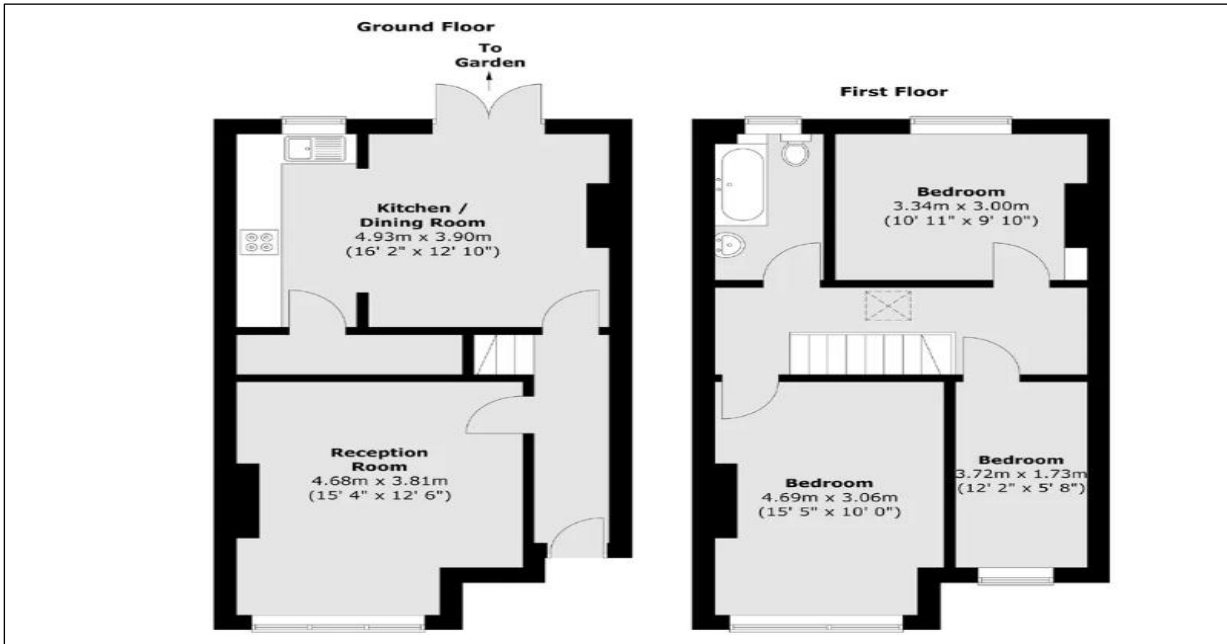

MAP

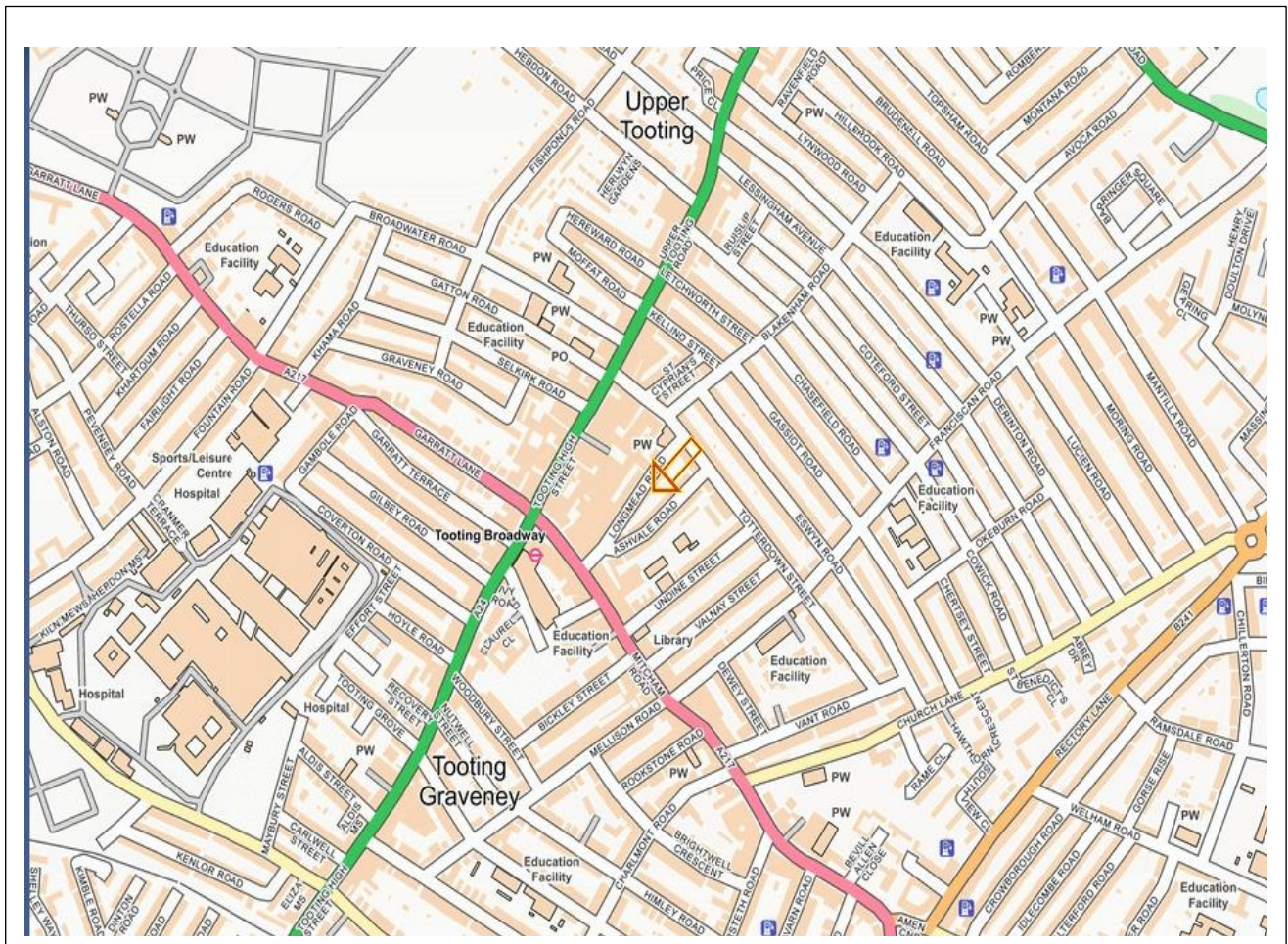

Croydon Branch: 292 London Road, Croydon, Surrey, CR0 2TG

Tel: 020 8684 6677 Mob: 07540 874 532 Fax: 0872 115 6090 Email: info@crownlets4u.co.uk

www.crownlets4u.co.uk