



2 Bedrooms



1 Bath/Shower Room



1 Reception Room



On-Street Parking



Well-Maintained Garden



EPC Band D

Council Tax  
Band: D £2,222.54  
April 24 / March 25  
Local Authority  
Dacorum Council

 **ashtons**  
for life's great moves



**Bridge Street, Berkhamsted, HP4 2EB**  
**Guide Price £515,000 Freehold**

## Bridge Street, Berkhamsted

A beautifully presented two-bedroom Victorian cottage located in the heart of the conservation area within walking distance of Berkhamsted's High Street & Mainline Station.

- 🏡 Central Berkhamsted Character Cottage
- 🏡 Open-Plan Living Room with Feature Fireplace
- 🏡 Spacious Kitchen with Integrated Appliances
- 🏡 Two Double Bedrooms
- 🏡 Additional Loft Room
- 🏡 Well-Maintained Garden
- 🏡 Convenient Location

### Description

This charming Victorian terrace home is nestled in a pretty no through road in the heart of Berkhamsted. The property's position is ideal for easy access to the town centre with a variety of shops, restaurants and cafes and it is only a five-minute walk to the mainline train station with frequent trains into London Euston.

On the ground floor there is a bright yet cosy living room with an attractive feature fireplace. To the rear there is a beautifully presented kitchen/dining area with integrated appliances.

Upstairs there are two good sized bedrooms with fitted wardrobes to the principal bedroom. There is a stunning newly fitted bathroom with a bath with shower-over, toilet and basin. Additionally, there is a useful loft space which is currently being used as a home office.

The pretty rear garden is well maintained with a wooden decked patio area and useful garden shed.

### Location

The property is located in one of the most historical and sought after parts of the Conservation Area and is conveniently placed for the town centre amenities, mainline station, restaurants and cafes as well as local schools for children of all age groups.



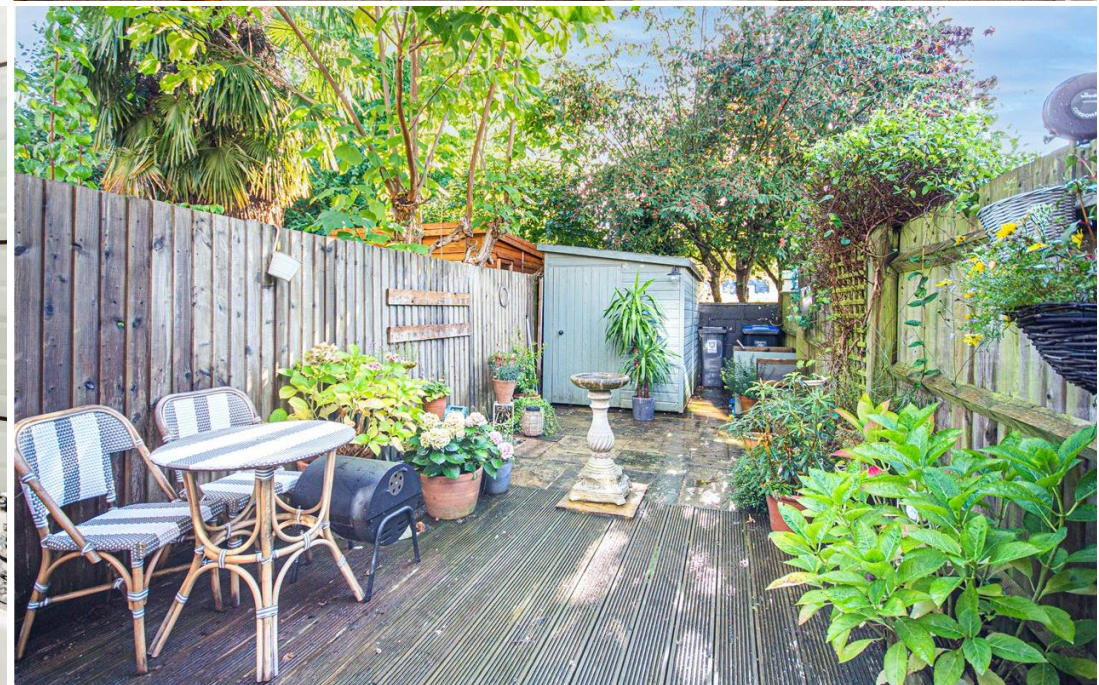

**Important Information**

These particulars do not constitute an offer or contract in whole or part. The statements contained herein are made without responsibility on the part of Ashtons or the vendors and they cannot be relied upon as representatives of fact. In respect of floor plans, these are for illustrative purposes only. The measurement and position of each element is approximate and must be viewed as such. Intending purchasers should therefore satisfy themselves by inspection or otherwise as to their correctness. The vendors do not make or give, and neither Ashtons nor any person in their employment has any authority to make or give, any representation or warranty whatsoever in relation to this property. We offer a wide range of services through third party providers including solicitors, surveyors, removal firms, mortgage providers and EPC suppliers. We receive additional payments for administering suppliers quoting software and making referrals. You are not under any obligations to use these services and it is your discretion whether you choose to deal with these parties or your own preferred supplier. You should be aware the average payment we received in 2021 equated to £48.36 per referral.

GROUND FLOOR  
271 sq.ft. (25.2 sq.m.) approx.

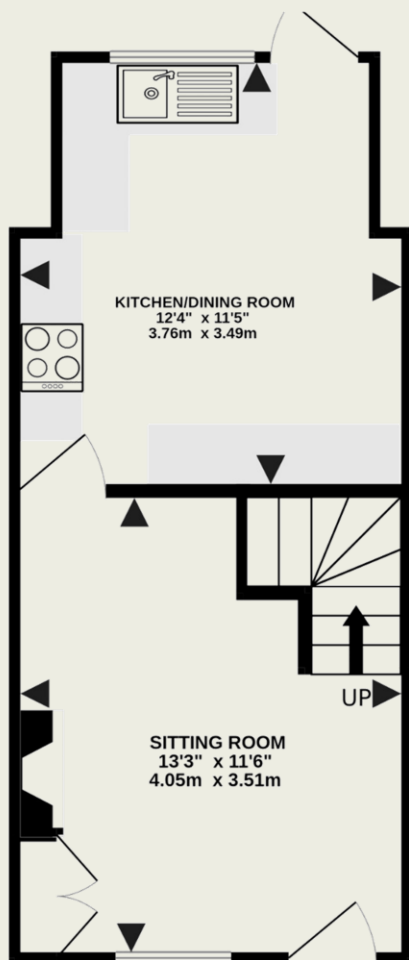

1ST FLOOR  
268 sq.ft. (24.9 sq.m.) approx.

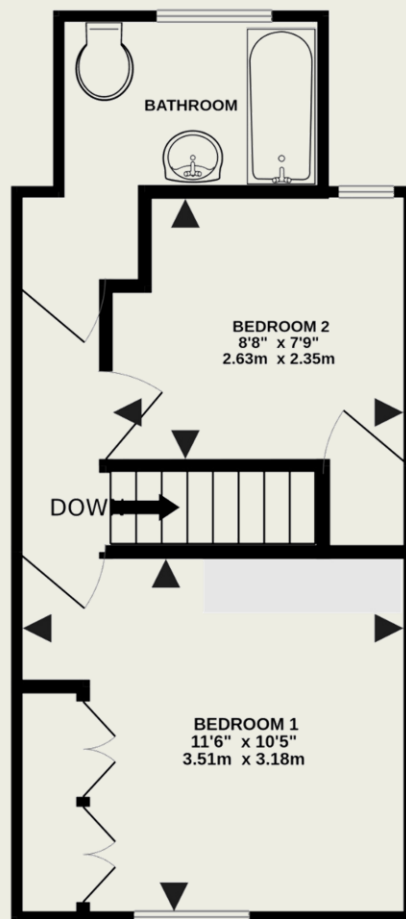

2ND FLOOR  
96 sq.ft. (8.9 sq.m.) approx.

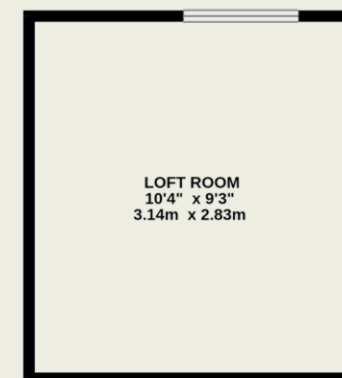

TOTAL FLOOR AREA : 635sq.ft. (59.0 sq.m.) approx.

This floorplan is for illustrative purposes only. The measurement and position of each element is approximate and must be viewed as such