



30 Beech Crescent, Hythe - SO45 3QG

£259,950 Freehold

This spacious mid-terrace home is set on the outskirts of Hythe and benefits from many pleasing features. This includes a refitted kitchen/dining room and a large lounge - featuring a fireplace with wood burning stove set between the two rooms! In addition to this, there are three bedrooms, a bathroom and a separate WC. Outside of the property there is block-paved driveway parking, a recently landscaped rear garden, and two brick-built sheds.

Further features include UPVC double glazing throughout, cavity wall insulation and solar panels. We strongly advise organising an appointment to view.

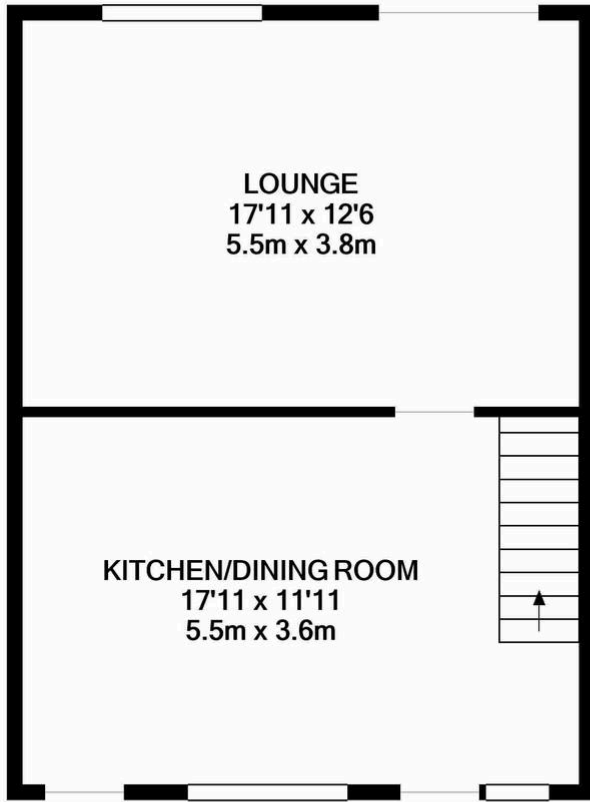

GROUND FLOOR
APPROX. FLOOR
AREA 435 SQ.FT.
(40.4 SQ.M.)

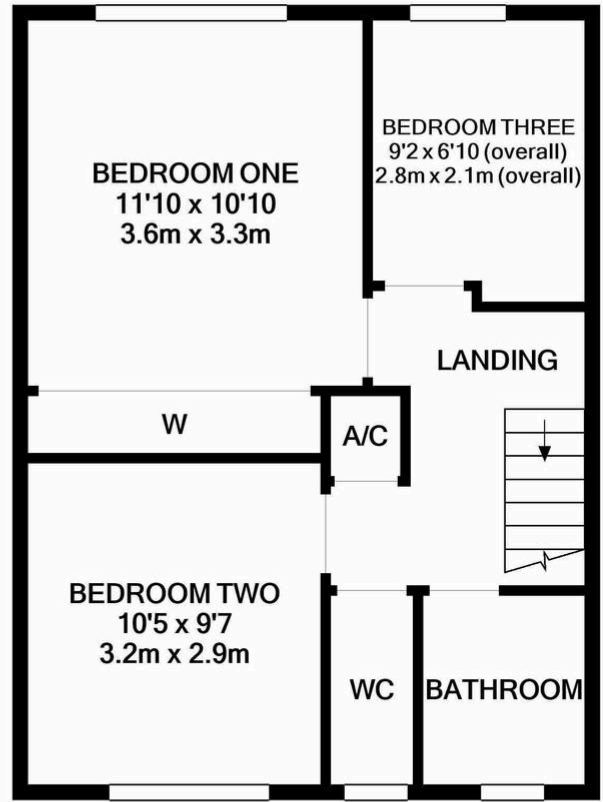

1ST FLOOR
APPROX. FLOOR
AREA 435 SQ.FT.
(40.4 SQ.M.)

TOTAL APPROX. FLOOR AREA 871 SQ.FT. (80.9 SQ.M.)

Whilst every attempt has been made to ensure the accuracy of the floor plan contained here, measurements of doors, windows, rooms and any other items are approximate and no responsibility is taken for any error, omission, or mis-statement. This plan is for illustrative purposes only and should be used as such by any prospective purchaser. The services, systems and appliances shown have not been tested and no guarantee as to their operability or efficiency can be given

Made with Metropix ©2020

You can include any text here. The text can be modified upon generating your brochure.



1 Southward House
Dibden Purlieu SO45 4PT



T: 02380 844405
info@anthonyjamesproperties.co.uk