



Bridge Street, Sturminster Newton

£995 per month



Interact with the virtual realty tour and call Forest Marble 24/7 to book your viewing of this newly refurbished and immaculately presented three bedroom flat. The flat is located on the second floor of Retsel House in the heart of Sturminster Newton, an idyllic country town with a host of amenities right on your doorstep. The flat comprises of an open plan main living space including a modern fitted kitchen and living area, three double bedrooms, and bathroom suite with shower. This flat is part of a block of four dwellings, with three other similarly high specification apartments also now fully fitted and available for immediate rental. To interact with the virtual reality tour please follow this link:

[Click Here](#)



### Situation

Sturminster Newton is a beautiful old market town found in the county of Dorset. The town enjoys a thriving community with the benefit of a varied selection of shops, first and secondary schools, and churches of most denominations. The town's economy is predominately centred around agriculture, with one of the country's largest cattle markets being held there up until 1988, with a housing estate and 300 seat community arts centre called The Exchange now in its place. The beautiful town is renowned for its association with famous poets William Barnes and Thomas Hardy. Easy access via road to the larger surrounding towns of Blandford Forum, Shaftesbury and Sherborne, with Gillingham offering a mainline station to London Waterloo.

### Key Features

- Three Bedroom Flat
- Newly Converted
- Town Centre Location
- Second Floor
- Open Plan Living Space
- Available Immediately



## Rooms

### Hallway

17'5" x 3'1" (5.31m x 0.94m)

### Open Plan Kitchen and Living Area

11'1" x 28'8" (3.38m x 8.74m)

### Bedroom One

11'4" x 12'11" (3.45m x 3.94m)

### Bedroom Two

11'3" x 13'0" (3.43m x 3.96m)

### Bedroom Three

11'2" x 8'3" (3.40m x 2.51m)

### Bathroom

6'1" x 7'3" (1.85m x 2.21m)



## Directions

As you head south from the centre of Sturminster Newton the property will be on your right hand side approximately 150 meters from the market cross.

## Agent Notes

Forest Marble Property Sales & Lettings are open 24/7. We bring together all of the latest technology and techniques available to sell or let your home; by listening to your specific requirements we will work with you so that together we can achieve the best possible price for your property. By using our unique customer guarantee we will give you access to a true 24/7 service (we are available when you are free to talk), local knowledge, experience and connections that you will find will deliver the service you finally want from your estate agent. Years of local knowledge covering Frome, Westbury, Warminster, Radstock, Midsomer Norton and all surrounding villages. We offer a full range of services including Sales, Lettings, Independent Financial Advice and conveyancing. In fact everything that you could need to help you move.





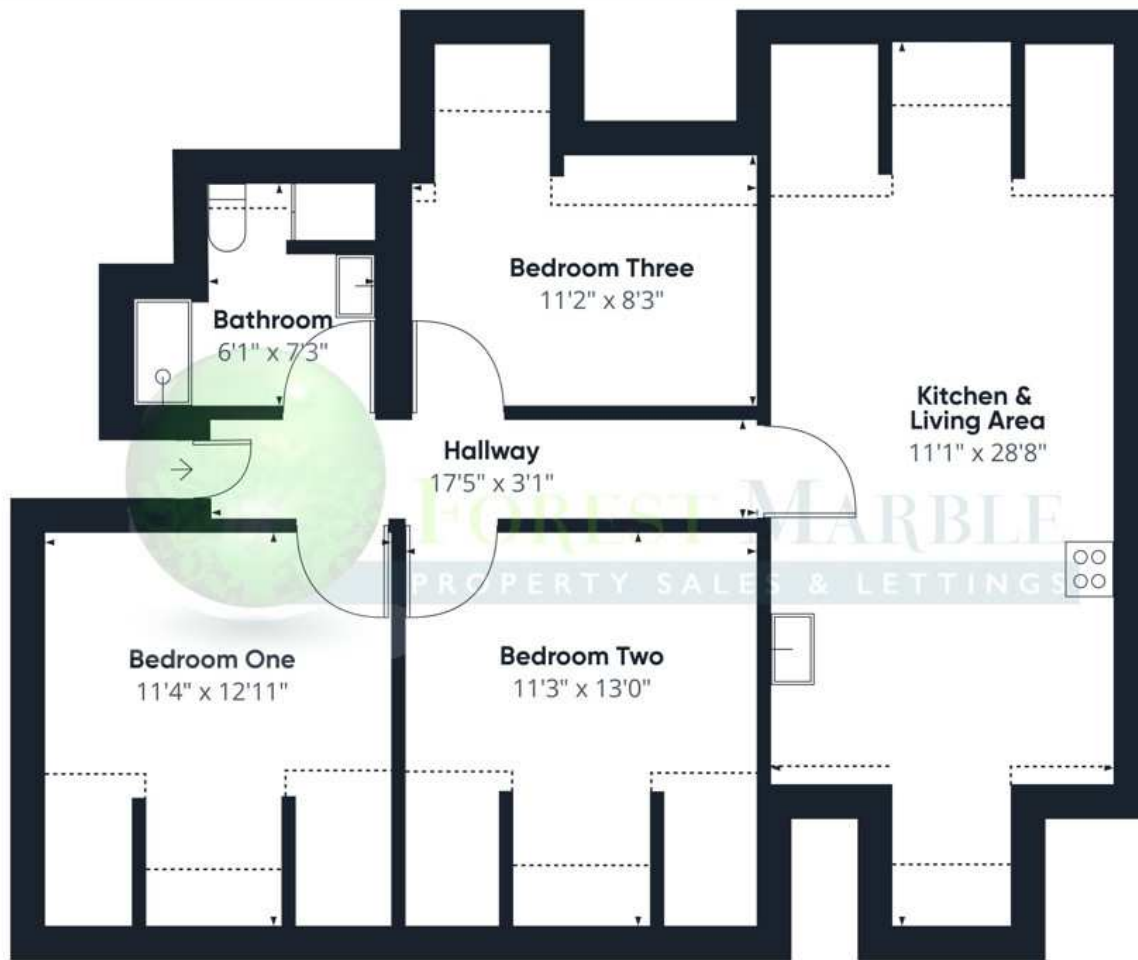

Approximate total area<sup>®</sup>

778.45 ft<sup>2</sup>

Reduced headroom

154.73 ft<sup>2</sup>

(1) Excluding balconies and terraces

Reduced headroom

— Below 5 ft

While every attempt has been made to ensure accuracy, all measurements are approximate, not to scale. This floor plan is for illustrative purposes only.

Calculations are based on RICS IPMS 3C standard.

GIRAFFE360

### Forest Marble Ltd

Forest Marble, 4 Harris Close, Frome BA11 5JY

Call: 01373 482900

Web: [www.forestmarble.co.uk](http://www.forestmarble.co.uk)

Email: [will.parfitt@forestmarble.co.uk](mailto:will.parfitt@forestmarble.co.uk)

MONEY LAUNDERING REGULATIONS 2003 intending purchasers will be asked to produce identification and proof of financial status when an offer is received. We would ask for your co-operation in order that there will be no delay in agreeing the sale. Consumer Protection from Unfair Regulations 2008: The Agents has not tested any apparatus, equipment, fixtures and fittings, or services, so cannot verify that they are in working order or fit for the purpose. The buyer is advised to obtain verification from his or her Professional Buyer. References to the Tenure of the property are based on information supplied by the Vendor. The agents have not had sight of the title documents. The buyer is advised to obtain verification from their Solicitor. You are advised to check the availability of any property before travelling any distance to view.