



23 Bellalmond Crescent

East Whitburn, Bathgate, West Lothian, EH47 0JF



Property Summary

With its highly sought-after village location in East Whitburn, within commuting distance of both Edinburgh and Glasgow, this two-bedroom semi-detached house enjoys spacious accommodation requiring some cosmetic upgrades and refurbishment. The home is set near local amenities, including bus links, shops, a primary school, and green spaces, and is ideal for buyers looking for an alternative to city living. The semi-detached home is further complemented by a spacious multi-car driveway and private gardens, with the rear garden boasting outside seating and a drying area.

Extras: all fitted floor and window coverings and light fittings are included in the sale.

Property Features

- Semi-detached house in East Whitburn
- Part of an established residential development
- Exciting redecoration opportunities
- Entrance and rear hall with under-stair storage
- Living/dining room with fireplace
- Spacious kitchen with fitted units
- Two double bedrooms with built-in storage
- Three-piece shower room
- Private gardens to the front and rear
- Private driveway parking
- Gas central heating and double glazing
- EPC Rating - E



Floorplan

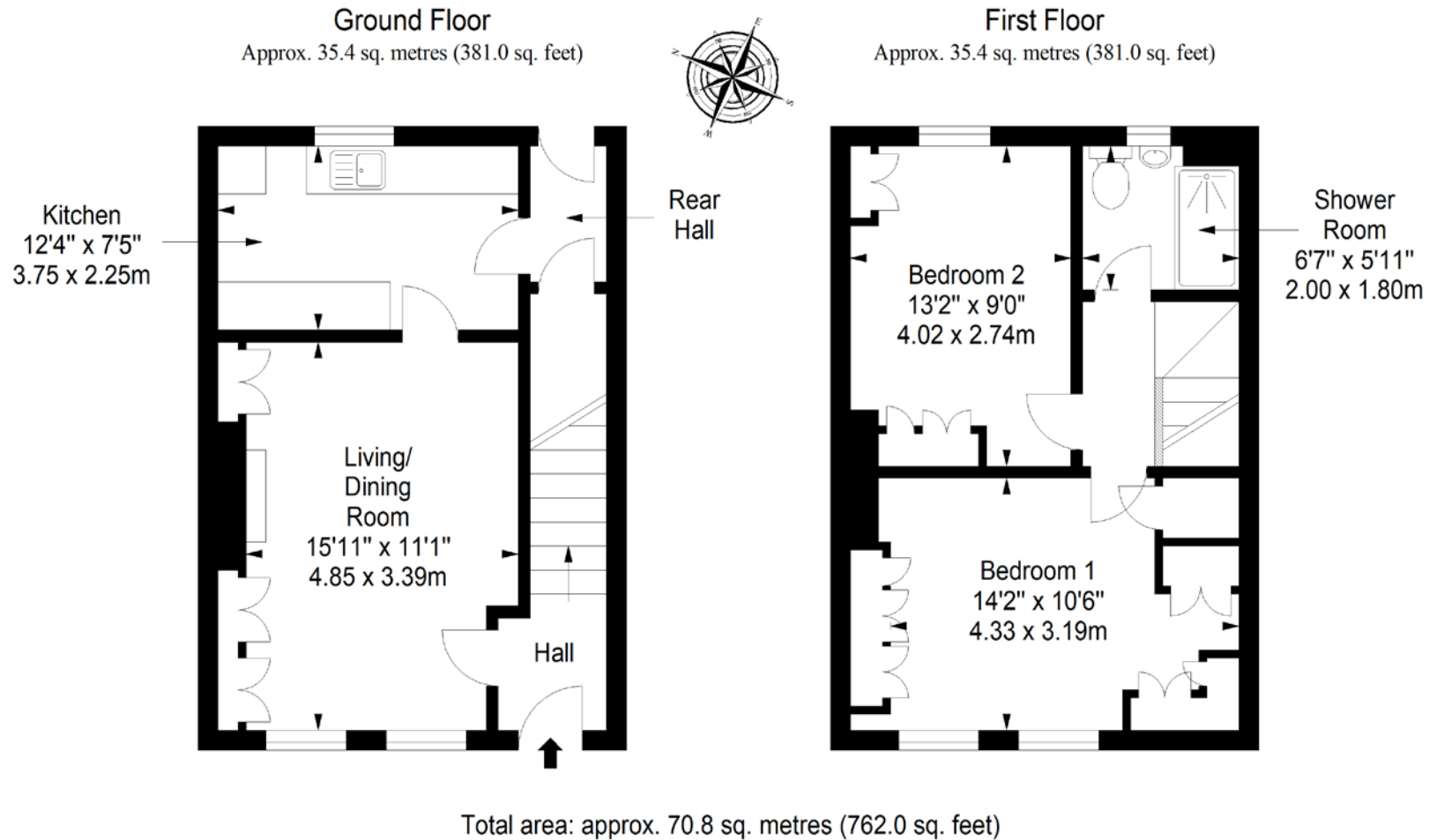

All Enquiries to our Property Department:

Afton Henderson | ah@sneddons-ssc.co.uk | 01506 815832 | www.sneddonmorrison.co.uk
14 East Main Street, Whitburn, West Lothian EH47 0RB

IMPORTANT: The selling agents for themselves and for the sellers of the above property give notice that these particulars are for guidance only and their accuracy is not guaranteed. These particulars will not form part of any contract and interested parties should satisfy themselves in all aspects prior to submitting offers. The sellers do not bind themselves to accept the highest offer. S1106