



FOR SALE

3 Bed Detached House in Sedgefield Drive, Thurnby, LE7 9PS
£295,000

*** No Chain *** Calling all DIY enthusiasts and property renovators. A rare opportunity to acquire a detached family home that can be changed, adapted and improved to suit any modern family. Accommodation comprises entrance hall, downstairs w.c., lounge, extended dining room, kitchen, three bedrooms, family bathroom, large rear garden, detached garage and off road parking.



GROUND FLOOR
507 sq.ft. (47.1 sq.m.) approx.

1ST FLOOR
395 sq.ft. (36.7 sq.m.) approx.

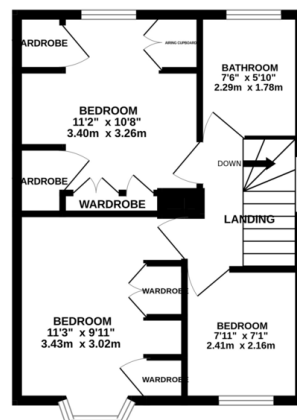
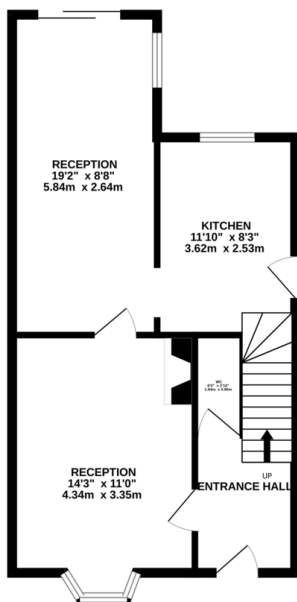

TOTAL FLOOR AREA - 902 sq.ft. (83.8 sq.m.) approx.
Whilst every attempt has been made to ensure the accuracy of the description contained here, measurements of doors, windows, rooms and any other items are approximate and no responsibility is taken for any error, omission or misstatement. This plan is for illustrative purposes only and should be used as such by any prospective purchaser. The services, systems and appliances shown have not been tested and no guarantee as to their operability or efficiency can be given.
Made with Heliplan ©2012

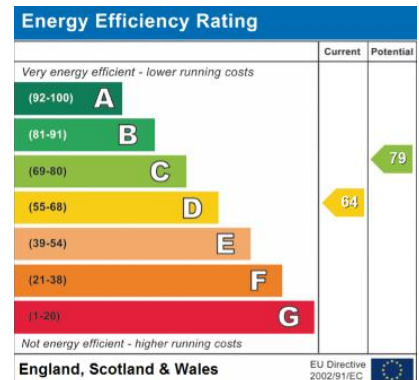

- No Chain
- Full Refurbishment Required
- Popular Location
- Detached House
- Three Bedrooms
- Detached Garage
- Downstairs W.C.
- Extended Reception

Agents Note: Whilst every care has been taken to prepare these sales particulars, they are for guidance purposes only. All measurements are approximate and for general guidance purposes only and whilst every care has been taken to ensure their accuracy, they should not be relied upon and potential buyers are advised to recheck the measurements.

