



Andrew Pearce
PINNER

NORTHOLT ROAD, , HA2 0ES £285,000



A spacious 1 bed apartment, located on the fifth floor of this modern apartment complex.

Just 360 yards from South Harrow's Piccadilly Line Tube Station and close to local amenities, shops, and schools.

Featuring a bright and spacious double bedroom with a built-in wardrobe, an open-plan reception room and kitchen with integrated appliances, and a fully tiled bathroom, the property is filled with natural light thanks to floor-to-ceiling windows.

Additional highlights include hardwood flooring, a utility cupboard, storage space, an entryphone system, and lift access.

With a long lease remaining of 135 years.

Service charge around £2000pa

Chain free sale



5TH FLOOR
511 sq.ft. (47.5 sq.m.) approx.

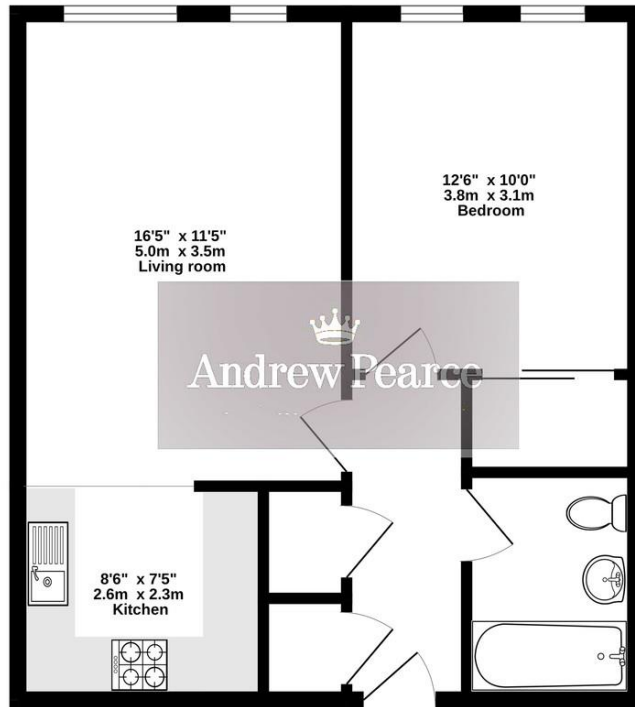

TOTAL FLOOR AREA: 511 sq.ft. (47.5 sq.m.) approx.
Whilst every attempt has been made to ensure the accuracy of the floorplan contained here, measurements of doors, windows, rooms and any other items are approximate and no responsibility is taken for any error, omission or mis-statement. This plan is for illustrative purposes only and should be used as such by any prospective purchaser. The services, systems and appliances shown have not been tested and no guarantee as to their operability or efficiency can be given.
Made with Metropix ©2024.



