



Lucerne Close

+44 (0) 1223 508050

lettings@cookecurtis.co.uk

www.cookecurtis.co.uk

A one bedroom house conveniently located for easy access to Addenbrookes Hospital and the city centre. Recently re-decorated and with new carpets throughout.

£1,200 pcm

Lucerne Close, Cambridge,
CB1 9SB



Lucerne Close sits in a peaceful cul-de-sac set just off Yarrow Road and is accessed via Teasel Way. It is a 15 minute drive or 25 minute cycle ride from the centre of Cambridge. There are good bus links in to Cambridge city centre and to Addenbrookes Hospital from Yarrow Road. There is a large Tesco supermarket within walking distance, plus a variety of local amenities on Cherry Hinton High Street.

This one bedroom house has been recently re-decorated and features brand new carpets throughout. Entering the property, you are immediately greeted with the spacious living room. To the left is the kitchen, which has plenty of worktop and cupboard space, plus fridge / freezer, washing machine, oven and hob.

Upstairs is the double bedroom and bathroom with shower over the bath.

The property has a parking space to the front, double glazing and gas central heating.

Please refer to the 'Tenant Guide' brochure, for more information regarding the tenancy application process, referencing, terms and conditions of the holding fee and payments due before the start of the tenancy.







42 sqm / 452 sqft

1 bed, 1 bath, 1 recep

Council tax band – B

EPC - C / 69

Gas central heating

Off road parking

Fully re-decorated and
new carpets throughout

Available December 2024



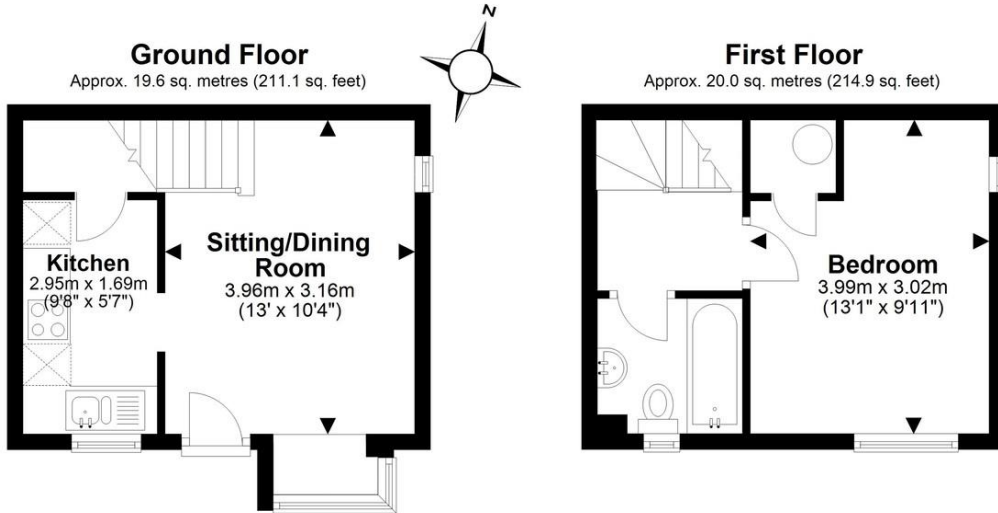

Total area: approx. 39.6 sq. metres (426.0 sq. feet)

Drawings are for guidance only. www.beachenergy.co.uk - IPMS 2
Plan produced using PlanUp.

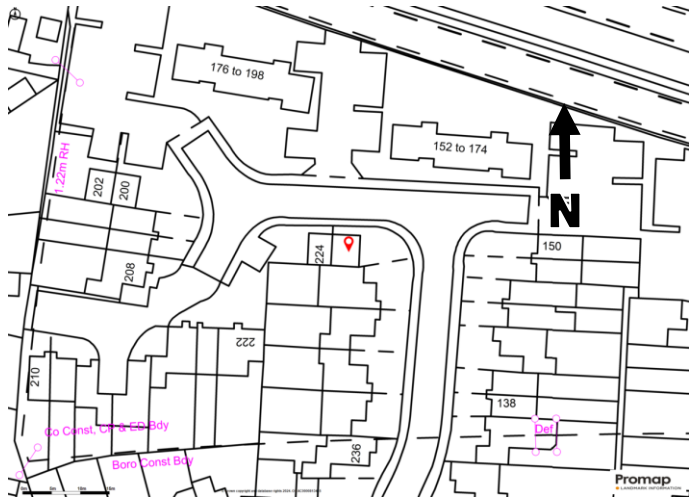

Lucerne Close is a popular development conveniently situated within easy reach local amenities. Cherry Hinton is a thriving, sought-after suburb just south east of the city. It is incredibly well served by a traditional High Street with an excellent range of shops, pubs, restaurants and takeaways plus leisure and health facilities. There is also a major Tesco supermarket off Yarrow Road. The area is highly popular with commuters thanks to its excellent access Addenbrooke's (1.5 miles), Cambridge railway station (2 miles) and on to the city centre (3.5 miles) and also with those looking for a traditional community with excellent day-to-day facilities that feels close to the city but retains its own identity. Cherry Hinton benefits from having excellent bus links into the centre of Cambridge and easy access on to the A14 for anyone commuting elsewhere.

COOKE
CURTIS
& CO