

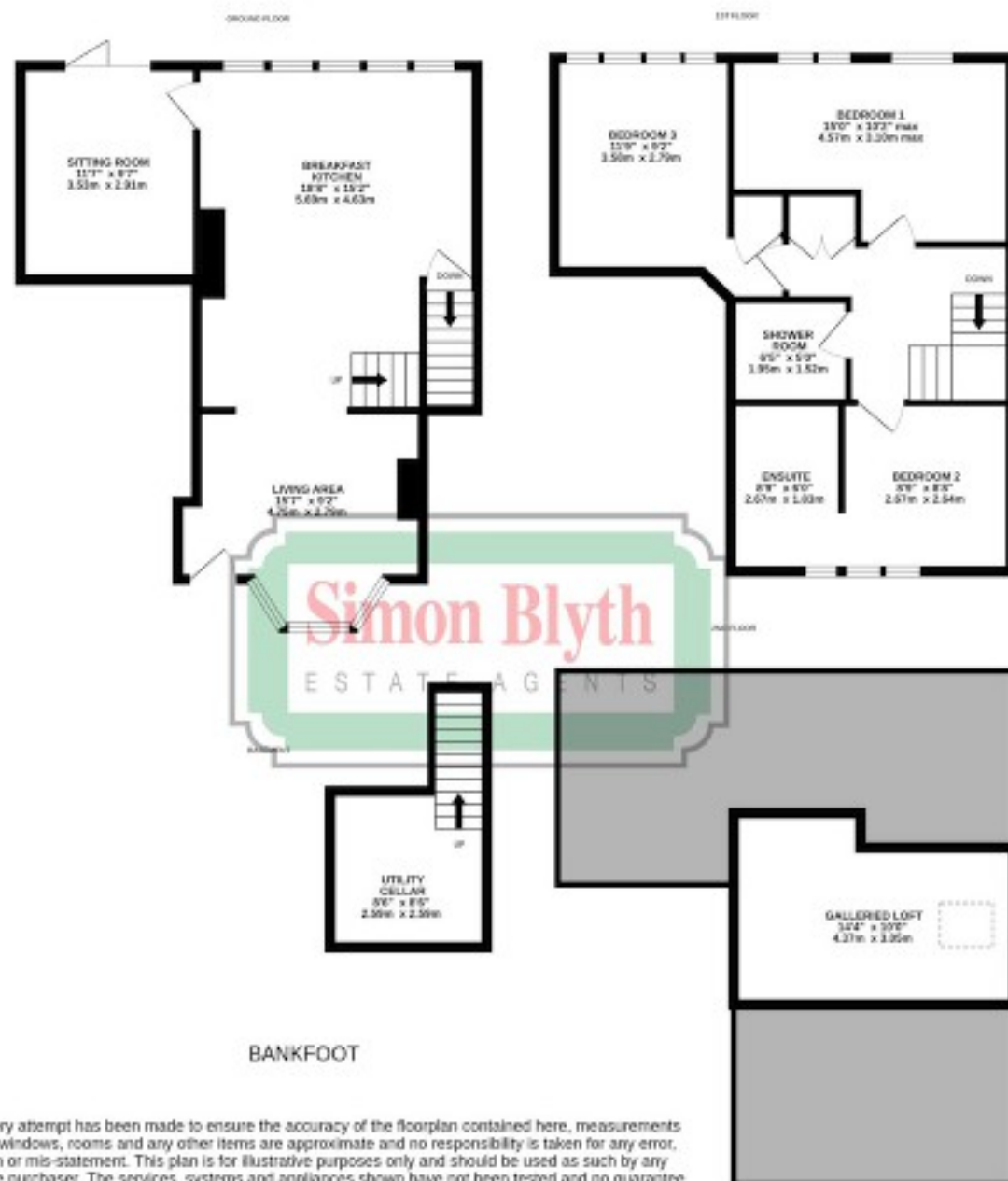

1 Bankfoot, Almondbury
Huddersfield

Offers in Region of **£495,000**



Whilst every attempt has been made to ensure the accuracy of the floorplan contained here, measurements of doors, windows, rooms and any other items are approximate and no responsibility is taken for any error, omission or mis-statement. This plan is for illustrative purposes only and should be used as such by any prospective purchaser. The services, systems and appliances shown have not been tested and no guarantee as to their operability or efficiency can be given.
Made with Metropix ©2024



1 Bankfoot

Almondbury, Huddersfield

A charming stone built and slated character cottage in an idyllic semi rural location within the Woodsome Valley and over looking large rear garden.

This beautiful property has undergone a comprehensive programme of modernisation and updating to create a fabulous turn key home with a stylish interior which retains a number of features, the ground floor living space has under floor heating with a sociable open plan sitting area and breakfast kitchen with large island and ideal for those who wish to entertain together with a separate living room with bi fold doors opening onto the garden. The basement has a vaulted tanked utility which also has under floor heating. The first floor landing leads to a shower room and three bedrooms (one with en suite bathroom, one with a galleried loft room). Externally there is off road parking and gardens to front and rear.





Ground Floor Living Area -15' 7" x 9' 2" (4.75m x 2.79m)

This has a timber and sealed unit double glazed door to the front elevation together with a large splay bay window which is adjacent, this has pvcu double glazed windows, window seat and enjoys a lovely aspect over the garden with views beyond across open country side. There is a beamed ceiling with inset led down lighters, tiled flooring with under floor heating which continues throughout the ground floor living space. The living area is open plan to the breakfast kitchen.

Breakfast Kitchen -18' 8" x 15' 2" (5.69m x 4.62m)

As the dimensions indicate this is a particularly spacious room which has a stone return staircase to one side rising to the first floor, there is tiled floor with under floor heating, beamed ceiling with inset led down lighters, across the rear elevation there are a bank of stone mullioned pvcu double glazed windows which provide the room with plenty of natural light and take advantage of a wonderful aspect across a large rear garden with views beyond. To one side there is a double ended fireplace with stone surround oak lintel, raised stone hearth and this divides the breakfast kitchen from the sitting room. The kitchen is fitted with a range of shaker style base and wall cupboards, drawers, these are matte reid green and contrasting matte white with brass handles and complimented by contrasting overlying quartz worktops. There is an inset double bowl Belfast sink with antique brass mixer tap, Range Master cooker with five ring induction hob, twin electric oven, grill and warming drawer with matching Range Master extractor hood over, integrated dishwasher and large island unit with handles, cupboards, wine cooler and once again complimented by contrasting overlying quartz worktop which extends to form a breakfast bar. To one side there is a door giving access to the basement and to the opposite side a door way provides access to the sitting room.



Sitting Room

11' 7" x 9' 7" (3.53m x 2.92m)

This has a double ended fireplace with wood burning stove, shared with the breakfast kitchen, There is exposed stone work, inset led down lighters, tiled flooring with under floor heating and three section bi fold powder coated aluminium doors which flood the room with natural light as well as taking full advantage of a lovely aspect across the large garden with open aspect beyond.



Basement/ Utility Cellar

8' 6" x 8' 6" (2.59m x 2.59m)

This is accessed from the breakfast kitchen with steps leading down to a barrel vaulted room which has been tanked together with tiled floor with under floor heating, wall mounted Baxi gas fired central heating boiler, Belfast sink with chrome monobloc tap, oak effect work surface with under counter space for washing machine and tumble dryer.





First Floor Landing

With inset led down lighters, beamed ceiling, loft access, there is a glass panelled balustrade with oak hand rail, twin door storage cupboard with fitted shelving, from the landing access can be gained to the following rooms..-

Bedroom One

15' 0" x 10' 2" (4.57m x 3.10m)

This generously proportioned double room is situated to the rear of the property and has a bank of stone mullioned pvcu double glazed windows, together with window seat looking out across the garden and with a lovely aspect beyond . There is a pitched beamed ceiling with exposed roof truss, central heating radiator, ceiling light point and inset led down lighters. To one side the bedroom is overlooked by a galleried loft which can be accessed from the landing.

Bedroom Two

8' 9" x 8' 8" (2.67m x 2.64m)

This has stone mullioned pvcu double glazed windows looking out over the front garden and with some lovely open views beyond across country side. There is a pitched beamed ceiling with exposed roof truss, central heating radiator, inset led down lighters and two display niches. To one side a doorway gives access to an en suite bathroom.

En Suite Bathroom

8' 9" x 6' 0" (2.67m x 1.83m)

With pvcu double glazed window, pitched beamed ceiling with inset led down lighters, chrome ladder style heated towel rail, part tiled walls with display niches, tiled floor and fitted with a four piece suite comprising free standing bath with free standing chrome monobloc tap incorporating hand spray, oval hand wash basin mounted on a granite plinth with chrome monobloc tap, low flush WC and shower cubicle with chrome shower fitting.



Bedroom Three

11' 9" x 9' 2" (3.58m x 2.79m)

This has a pitched beamed ceiling with inset led down lighters, central heating radiator, fitted storage cupboard with shelving and a bank of stone mullioned pvcu double glazed windows which look out across the rear garden and enjoying a lovely aspect beyond.

Shower Room

6' 5" x 5' 0" (1.96m x 1.52m)

With inset led down lighters, floor to ceiling tiled walls, extractor fan, chrome ladder style heated towel rail and fitted with a suite comprising oval hand wash basin with chrome mixer tap mounted on a granite plinth, low flush WC and large walk in shower with glazed panels and chrome shower fitting.

Galleried Loft

14' 4" x 10' 0" (4.37m x 3.05m)

This is accessed via a timber fold down ladder located on the landing, there is a beamed ceiling with inset led down lighters, exposed roof truss, glass panelled and stainless steel balustrade together with glass panelled section with oak hand rail looking out across the master bedroom.





Garden

Beyond the parking bay there are stone steps rising to a stone pathway providing access to the front door where there is external lighting and a lawned garden. There is large rear garden with stone flagged patio spanning the width of the cottage together with outside lighting, from here a short flight of stone steps, leading to a generous shaped lawned garden with planted trees, fruit trees, flowers and shrubs. This has a south easterly aspect and enjoys a lovely aspect across open field and farm land beyond.

Parking

To the front of the property there is a tarmac parking.





VIEWING For an appointment to view, please contact the Huddersfield Office on 01484 651878

BOUNDARY OWNERSHIP The boundary ownerships and tenure of the property have not been checked on the title deeds for any discrepancies or rights of way if any (This is a standard statement on all our brochures due to the Property Misdescription's Act)

COPYRIGHT Unauthorised reproduction prohibited.

FREE VALUATIONS If you are thinking of a move then take advantage of our FREE valuation service, telephone our nearest office for a prompt and efficient service.

CONSUMER PROTECTION FROM UNFAIR TRADING REGULATIONS 2008 Simon Blyth for themselves and for the vendors or lessors of this property, whose agent they are, have made every effort to ensure the details given have been prepared in accordance with the above act and to the best of our knowledge give a fair and reasonable representation of the property.

Please note:

1. There is a six inch measurement tolerance or metric equivalent and the measurements given should not be entirely relied upon and purchasers must make their own measurements if ordering carpets, curtains or other equipment.
2. None of the main services, i.e. gas, water, electricity, drainage or central heating system (if any) have been tested in any way whatsoever. This also includes appliances which are to be left in situ by the vendors.

PURCHASERS MUST SATISFY THEMSELVES AS TO THE CONDITION AND EFFECTIVENESS OF ANY SUCH APPLIANCES OR SERVICES FLOOR PLANS NOT TO SCALE - FOR IDENTIFICATION PURPOSES ONLY.

MAILING LIST Keep up to date with all our new properties. Let us know your price range, the area and type of home you require by registering on our mailing list.

MORTGAGE ADVICE Simon Blyth Estate Agents understand that getting appropriate mortgage advice is a crucial part of the home buying process. Finding a suitable mortgage has always been something of a daunting experience which is why we would like to introduce you to our independent mortgage advisors. They provide tailored mortgage solutions through a wealth of experience in the mortgage and property market and offer access to the full unrestricted range of products available. Our advisors are dedicated to providing ongoing guidance and advice throughout the entire house purchase process keeping you, your estate agent and solicitor involved with continual updates on the progress. Once in your new home they will be available for ongoing support to build a long term relationship for your future mortgage planning. Your home may be repossessed if you do not keep up repayments on your mortgage. For friendly expert advice on your mortgage requirements, or to discuss the potential of making your ideas a reality then please call in or phone for a chat.

OFFICE OPENING TIMES 7 DAYS A WEEK Monday to Friday - 8:45 am to 5:30 pm

Saturday - 9:00 am - 4:00 pm Sunday - 11:00 am - 2:00 pm



Simon Blyth Estate Agents

Simon Blyth Estate Agents, 26 Lidget Street - HD3 3JP

01484 651878

huddersfield@simonblyth.co.uk

www.simonblyth.co.uk/

Wakefield	Huddersfield	Holmfirth	Kirkburton	Penistone	Sheffield	Barnsley	Pontefract	Leeds	Halifax
01924 361631	01484 651878	01484 689689	01484 603399	01226 762400	01143 216 590	01226 731730	01977 800259	0113 4689331	01422 417000