



£375,000
Freehold

5 Atkinson Close, Whiteley
Fareham, PO15 7QA



Quick View



3 Bedrooms



No Garage



1 Living room



2 Bathrooms



Semi-Detached House



EPC Rating B



Parking



Council Tax Band D

Reasons to View

- Fantastic location for those who love the outdoors! With a cricket pitch, tennis court & playing field just a 2 min drive away – why not add the paddleboards and enjoy the Hamble too!
- In catchment for both Whiteley primary and Cornerstone, the closest just a 7 min walk, so the school run should be a doddle in the morning!
- With a crisp, neutral décor throughout, and cottage style internal doors with chrome fittings, there's a quality, cosy feel here.
- A shower ensuite, family bathroom and a downstairs cloakroom means there will be no one standing in line waiting here.
- A desired layout with a spacious kitchen dining area to the rear with access to the garden makes entertaining a pleasure – especially in the summer, enjoying those family BBQ's.
- Offered with vacant possession – ideal for any first-time buyer wanting to be in before April 2025.

Description

This is such a great location, with the only passing traffic being just your neighbours, plus the convenience of being a short distance to Botley Road, your morning commute is made a lot easier. For those needing public transport, the bus stop to Whiteley, Fareham and Swanwick train station is just a short walk around the corner. On the direct London line, there is a cycle path on the Botley Road and Swanwick station for local access.

This lovely semi detached home has the advantage of a driveway to the side providing parking for two cars, as well as parking on the street. The front door opens into the hall, with stairs to the first floor, and a door to the sitting room which leads to the back of the house. Neat practical oak style flooring flows through the cupboard under the stairs and a spacious cloakroom, which has a white suite and a window, and plenty of space to hang coats, and into the kitchen / dining room.

The kitchen / dining room is a great space, with loads of room for a family table – perfect for entertaining or watching over the children doing their homework whilst preparing the family meal. The white kitchen is well planned to provide lots of cupboard space, and has an integrated fridge freezer, double oven, gas hob, extractor & dishwasher. With French doors that open into the garden, it's the ideal layout for the summer months too.

Upstairs, there is access to the loft and to the main bedroom, which has a mirror fronted double wardrobe, and a white ensuite with a shower cubical and complimentary tiles, plus a window. The other two bedrooms, one with a double wardrobe, share the family bathroom which has a shower over the bath; ideal for a quick shower or a more indulgent soak when time allows.

Outside, the garden is enclosed with panel fencing and a side gate gives access to the parking; really convenient when you bring back the weekly shop. The garden is a blank canvass being laid to lawn and being 30'x30' there's plenty of room to kick a ball around, and host summer BBQ. A timber built shed provides storage for your bikes and the paddle boards.

We think this is a great house on a good plot and invite you to take a peek at our full walk around video on our website. Please call the office to arrange a viewing in person.

Material Facts:

This property is currently let, and we are advised the tenant will vacate 28/2/25. Exchange of contracts can take place post vacating.

Directions

<https://what3words.com/spits.trim.salaried>

Ground Floor

Approx. 42.2 sq. metres (454.5 sq. feet)

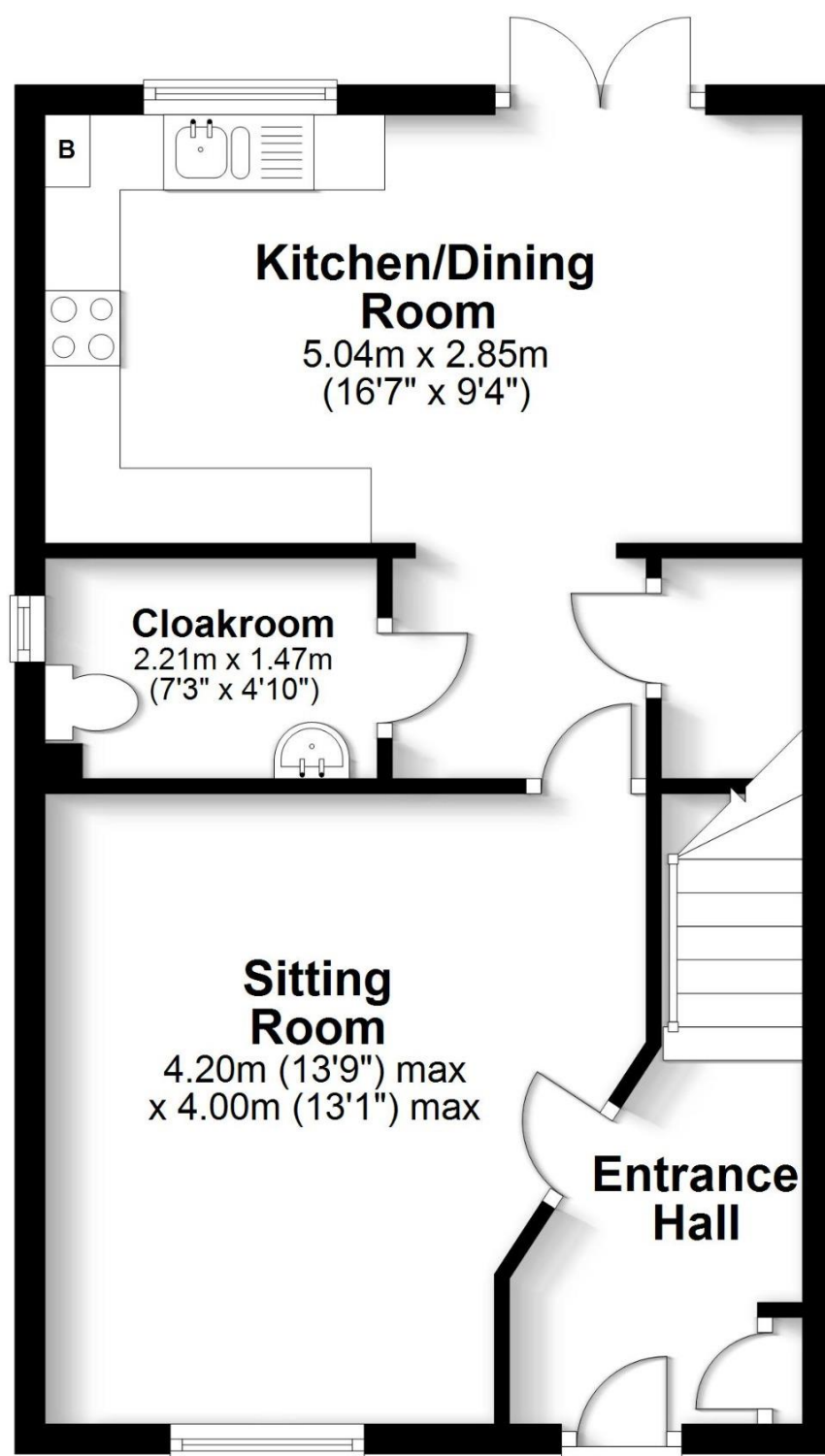

First Floor

Approx. 40.6 sq. metres (437.4 sq. feet)

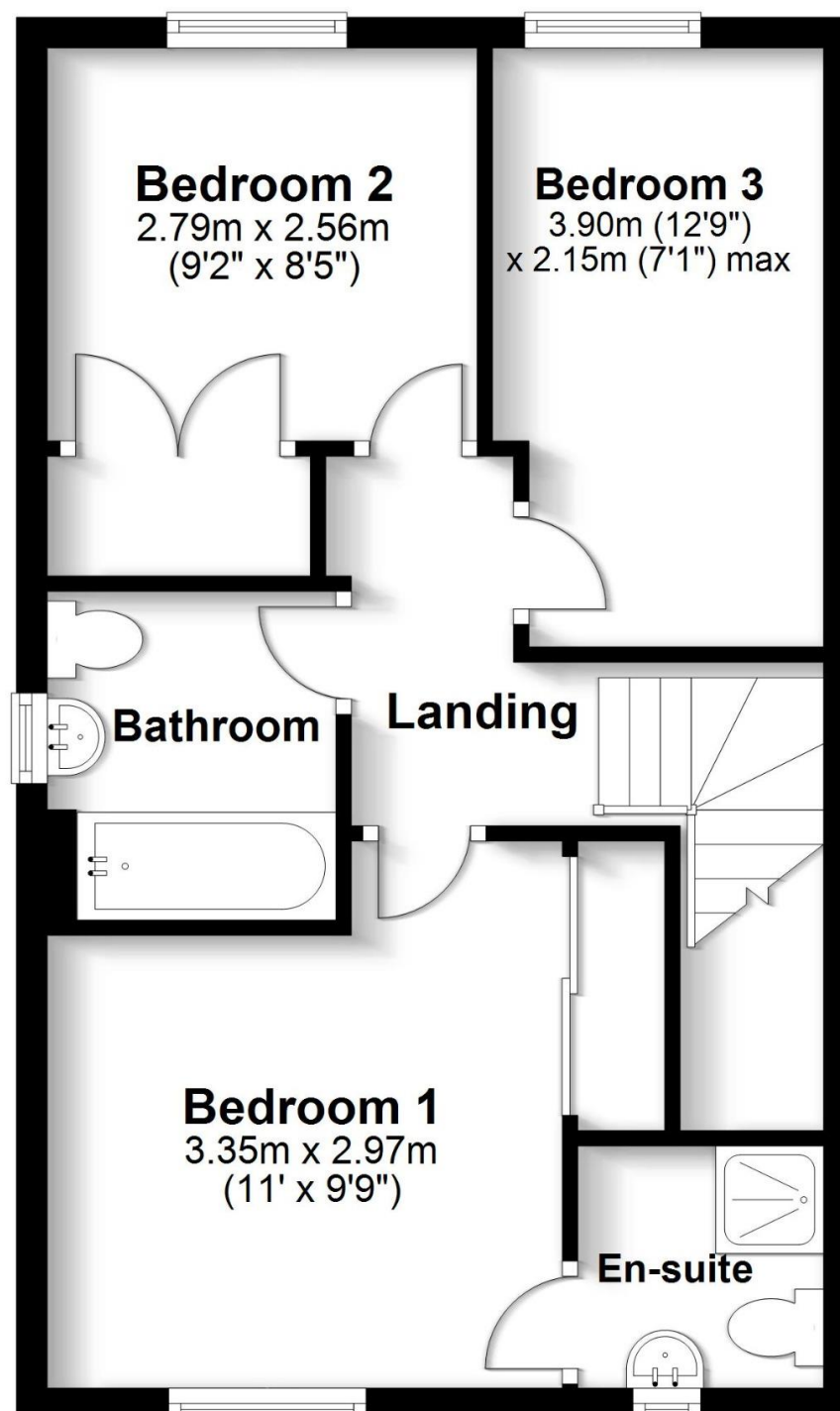

Total area: approx. 82.9 sq. metres (891.9 sq. feet)

Robinson Reade endeavour to supply accurate and reliable property information in line with Consumer Protection from Unfair Trading Regulations 2008, however please contact the office before viewing if there is any aspect which is particularly important to you and we will be pleased to provide the relevant information. These property details do not constitute any part of an offer or contract, all measurements are approximate. Any services, appliances and heating systems listed have not been checked. We must point out that where we introduce you to a third party who offers conveyancing, removal or financial services, e.g. legal, mortgage and insurance advice, we may earn a commission. For more information go to www.robinsoneade.co.uk/referral-fees. Robinson Reade Ltd, Registered office: 10 Middle Road, Park Gate, Southampton, SO31 7GH, Co Reg No: 5185152



Pop in to see us at 10 Middle Road, Park Gate, Southampton, Hampshire, SO31 7GH
 Email us sales@robinsonreade.co.uk Visit us www.robinsonreade.co.uk
 Call us on 01489 579009

Independent Sales & Letting Agents for the Strawberry Coast