



Ulverston

£850 pcm

22 Burlington Street
Ulverston
Cumbria
LA12 7JA

An opportunity to rent a well presented, part furnished, one bedroom, mid terraced house. Comprising; two reception rooms, one with a multifuel stove, kitchen, a garden room which is great for entertaining and a four piece bathroom.

- One Bedroom Mid Terrace House
- Living Room, Dining Room & Kitchen
- Easy To Maintain Garden With Garden Room
- With Walking Distance To Ulverston Town Centre
- On Street Parking
- Part Furnished
- Pets Are Unable To Be Accepted At This Property
- No Smokers or Sharers
- Council Tax Band A
- Available Now

Property Ref: ULR0438





Living Room

Location: Travelling in the direction of Barrow take the forth exit at the central roundabout into the Town Centre passing Brewery Street Car Park on your left. At the staggered crossroads take the right turning into Hart Street and then the second right turning into Burlington Street. Continue towards the end of the road and the property can be found on the right hand side.

What3words: ///thudding.blur.spurned

Furnishings: The property is offered furnished which includes the furniture as pictured.

Services: Mains Electric, Gas, Water (Unmetered) and Drainage. Internet Speed: <https://checker.ofcom.org.uk/en-gb/broadband-coverage#pc=LA61RB&uprn=100110695355>

Viewings: Strictly by appointment with Hackney & Leigh – Ulverston Office.

Ongoing Tenancy Management: Upon tenancy commencement the rent will be paid to Hackney & Leigh, and the day to day management, along with the maintenance, will be managed directly by the landlord.

Applying for a Tenancy: Tenancy Application Forms are available from any Hackney & Leigh office. Each application must be accompanied by payment of a Holding Deposit (one weeks rent) payable either by debit or credit card. This is paid to reserve the property and will be held by us for a period of 15 days unless we agree otherwise. All adults of 18yrs and over who will be living at the property will be asked to provide evidence of nationality and identity to validate their "Right to Rent" under the Immigration Act 2014.

Referencing: All applicants will be required to provide satisfactory references eg: employer, current landlord and two character references. For the self-employed, a reference from your accountant or solicitor will be required. A credit reference will be obtained for each applicant. Acceptance of references and the offer of a tenancy is at our discretion.

The Tenancy: The property will be let on a fixed term Assured

Shorthold Tenancy for an initial period of 6 months. There is no automatic provision within the lease for early termination and the tenant is responsible for rent for the whole term. The tenant is responsible for Council Tax for the tenancy period and for all charges for water and sewerage, gas, electricity, telephone or other utility/service providers' charges supplied to the tenant during the tenancy.

Deposit & Rent: The successful Tenant will be required to pay a deposit (equal to a maximum of 5 weeks rent depending on the property). This will be held in accordance with the Tenancy Deposit Scheme Regulations and will be re-fundable at the end of the tenancy, subject to the property being left in a satisfactory condition. Rent is payable on or by each rent day and is payable by standing order. One month's rent in advance PLUS the deposit, is required at the time of signing the agreement. Please Note: It is NOT possible to use the deposit as rent for the final month.

Pets: Pets are unable to be accepted at this property. Pets may not be acceptable for a number of reasons including allergies/medical reasons, conditions within the property lease, lack of outside space, communal grounds or close proximity to a main road. Acceptance of a pet is subject to the Landlords discretion.

Insurance: It is the Tenants' responsibility to insure their own possessions. Tenants are strongly advised to take out accidental damage cover in respect of the Landlord's property and contents.

Energy Performance Certificate: The full Energy Performance Certificate is available on our website www.hackney-leigh.co.uk and also at any of our offices.

How to rent: Prospective tenants are advised to read the government's leaflet which is available here: <https://www.gov.uk/government/publications/how-to-rent>



Dining Room



Kitchen

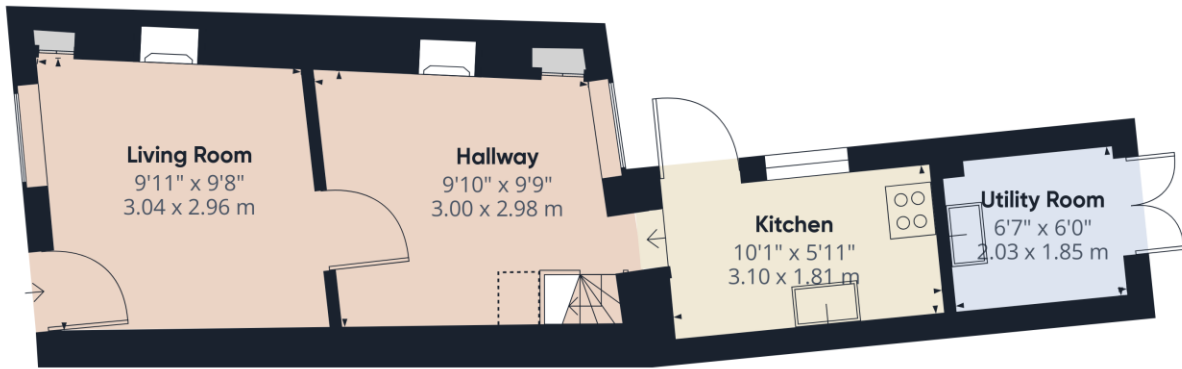

Ground Floor

Approximate total area^m

562.42 ft²
52.25 m²

Reduced headroom

3.21 ft²
0.3 m²

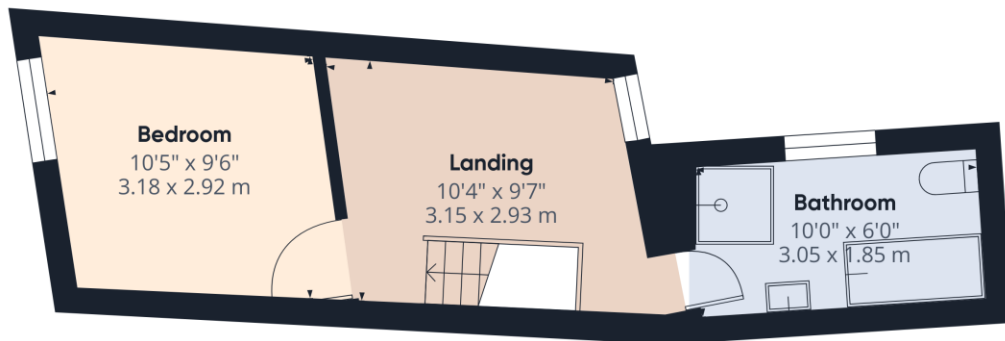

Floor 1

(1) Excluding balconies and terraces

Reduced headroom
..... Below 5 ft/1.5 m

While every attempt has been made to ensure accuracy, all measurements are approximate, not to scale. This floor plan is for illustrative purposes only.

Calculations are based on RICS IPMS 3C standard.

GIRAFFE 360

22 Burlington Street Ulverston - Ref: ULR0438

Property particulars and appointments to view are provided on the understanding that all negotiations are conducted through Hackney and Leigh Ltd. This information is provided for general guidance only. It does not form part of any contract or agreement and no guarantee of accuracy is given. Prospective tenants should make their own enquiries as to the suitability or otherwise of the property. No responsibility can be accepted for any loss or expense incurred in viewing or in the event of a property being let or withdrawn. Please contact us to confirm the property's availability, especially if travelling some distance.