

A balcony view of a modern residential complex. The balcony has a wooden ceiling and a glass railing. In the background, there is a river, a city skyline with cranes, and a large multi-story apartment building with many balconies. The sky is blue with some clouds.

H&G

*Spinnaker*  
HOUSE

# *Spinnaker* HOUSE

---

**A well presented, spacious two bedroom, two bathroom apartment with balcony in the award winning Battersea Reach riverside development.**

This property encompasses a well-proportioned open plan kitchen/ reception room, with ample space for separate dining and living areas. The kitchen area is fully equipped with state of the art appliances.

The private balcony can be accessed from the reception room and second bedroom and provides sweeping views across the communal gardens to the River. The master suite is a generous size and benefits from built-in wardrobes and an en suite shower room.

Available Now on a furnished basis.

One parking space included.







# Battersea REACH

Battersea Reach offers a 24hr concierge service, residents gymnasium, coffee and cake shop, Tesco Express and a Young's riverside bar and restaurant. Fashionable Old York Road with its boutiques, cafes, restaurants and shops is within close proximity.

Local transport links are provided by Wandsworth Town or Clapham Junction Station (National Rail) for connections into and out of central London with buses providing access across the river to Fulham and Chelsea.

A Thames Clipper river taxi service is now in operation, with the pier located just a few hundred yards away.

## H&G

020 7352 2455

info@hgproperty.co.uk

www.hgproperty.co.uk

4 Vicentia Court, Bridges Wharf

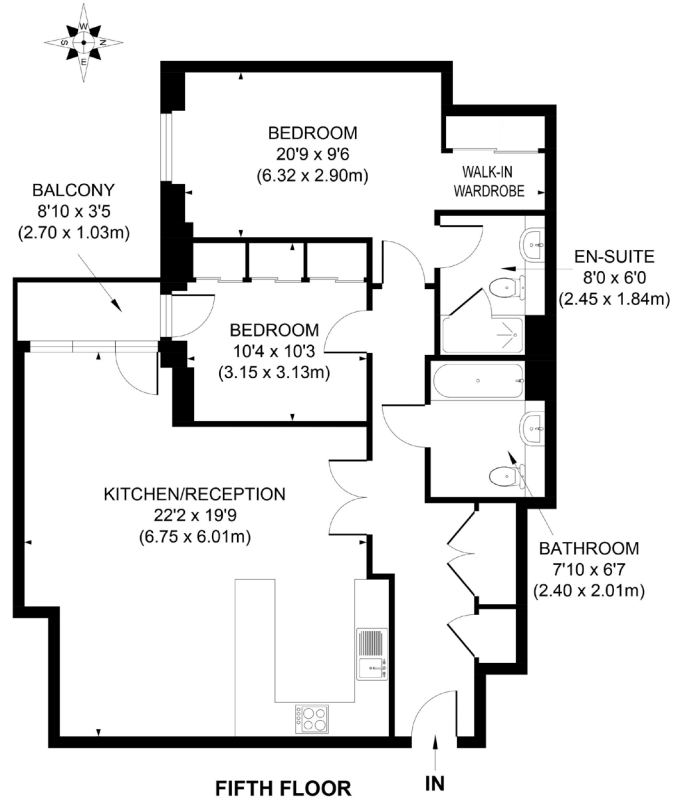

APPROX. GROSS INTERNAL FLOOR AREA 947 SQ FT / 88.06 SQ M

Illustration for identification purpose only, not to scale  
All measurements are maximum, and includes wardrobes and window bays where applicable  
Prepared by Pixangle ©. Tel 020 8870 2118