



**Coopers**

**Coopers**

Longfellow Court, Longfellow Road, Wyken

In Excess of £150,000

# Longfellow Court, Longfellow Road

Wyken, Coventry

Looking for a ground floor flat with no chain? This two-bedroom property features off-road parking, gas central heating, a long lease of 104 years, and a convenient location.

Council Tax band: B

Tenure: Leasehold

EPC Energy Efficiency Rating: B

- Ground floor flat with two bedrooms and practical layout
- Lounge with adjacent kitchen and separate bathroom
- Gas central heating throughout
- Allocated off-road parking space for added convenience
- Leasehold with approximately 104 years remaining (to be confirmed)
- Service charge and ground rent approximately £1450 (to be confirmed)
- Sold with no onward chain for a smooth purchase
- Conveniently located near local shops, transport links, and green spaces





**Coopers**



**Coopers**



**Coopers**

GROUND FLOOR  
601 sq.ft. (55.9 sq.m.) approx.

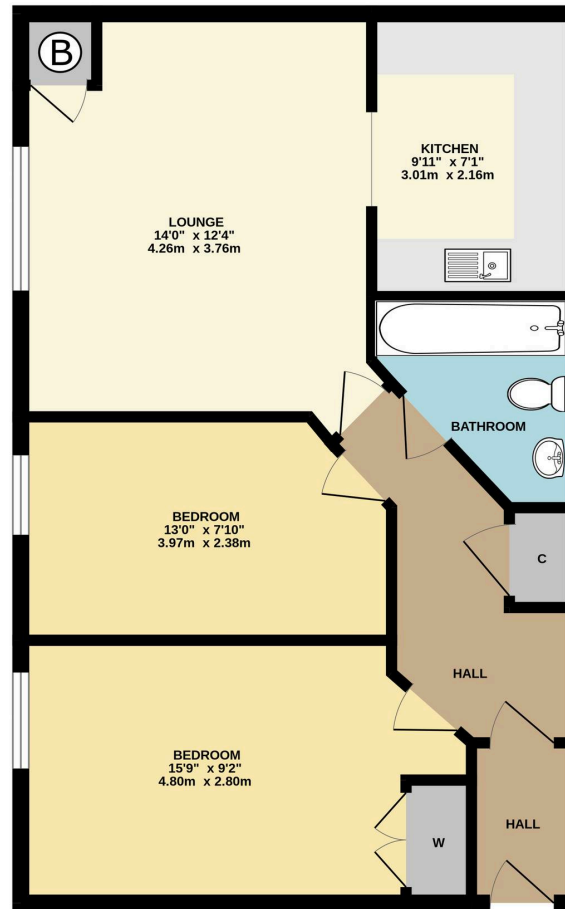

TOTAL FLOOR AREA : 601 sq.ft. (55.9 sq.m.) approx.

Whilst every attempt has been made to ensure the accuracy of the floorplan contained here, measurements of doors, windows, rooms and any other items are approximate and no responsibility is taken for any error, omission or mis-statement. This plan is for illustrative purposes only and should be used as such by any prospective purchaser. The services, systems and appliances shown have not been tested and no guarantee as to their operability or efficiency can be given.  
Made with Metroplan ©2024

Coopers Estate Agents

Coopers, 22 New Union Street – CV1 2HN



Coopers Chartered Surveyors Ltd, 22 New Union Street, Coventry, West Midlands

CV1 2HN, 024 7655 2841, sales@coopers-cov.com. Company Registration

Number: 6725089 / VAT number: 940 3555 34

024 7655 2841 • sales@coopersestateagents.com • www.coopersestateagents.com/