

Romsey Close, Hockley, SS5 4XJ



Guide Price £100,000 - £110,000

Situated on the popular Betts Farm development is this ground floor Studio Flat/Apartment, perfect for a Buy To Let or first time purchase, requiring complete modernisation throughout and is priced realistically to allow for the cost of the work required. Benefiting from having allocated parking in communal car park, communal gardens to the rear and within close walking distance of mainline railway station and local shops.

A realistic monthly rental return on this property would be approximately £650 per month.

NO ONWARD CHAIN.

Council Tax Band: A. EPC Rating: C.

Ref 11675

Entrance via communal entrance door

COMMUNAL ENTRANCE HALL

Communal door providing access to communal gardens. Personal hardwood entrance door to

HALLWAY

BATHROOM

WC with low level cistern. Pedestal wash hand basin. Panelled bath with electric shower over. Airing/storage cupboard.



LOUNGE/BEDROOM 14' x 13' 3" (4.27m x 4.04m) Two double glazed windows overlooking communal gardens. Storage area. Textured ceiling. Electric storage radiators.



KITCHEN (REQUIRING COMPLETE REFURBISHMENT) 9' 6" x 7' 2" (2.9m x 2.18m) Double glazed window overlooking communal gardens. Space for appliances. Textured ceiling.



EXTERIOR

Allocated parking within communal car park.
Bike storage shed.
Communal gardens to the rear.



Agents Note:

*Ideal for a Buy To Let opportunity, with an approximate 6.5% yield as a return.
Lease - the vendors have advised there is approximately 950 years remaining
Service Charge - £41 per month
Ground Rent - £0*

GROUND FLOOR
260 sq.ft. (24.1 sq.m.) approx.

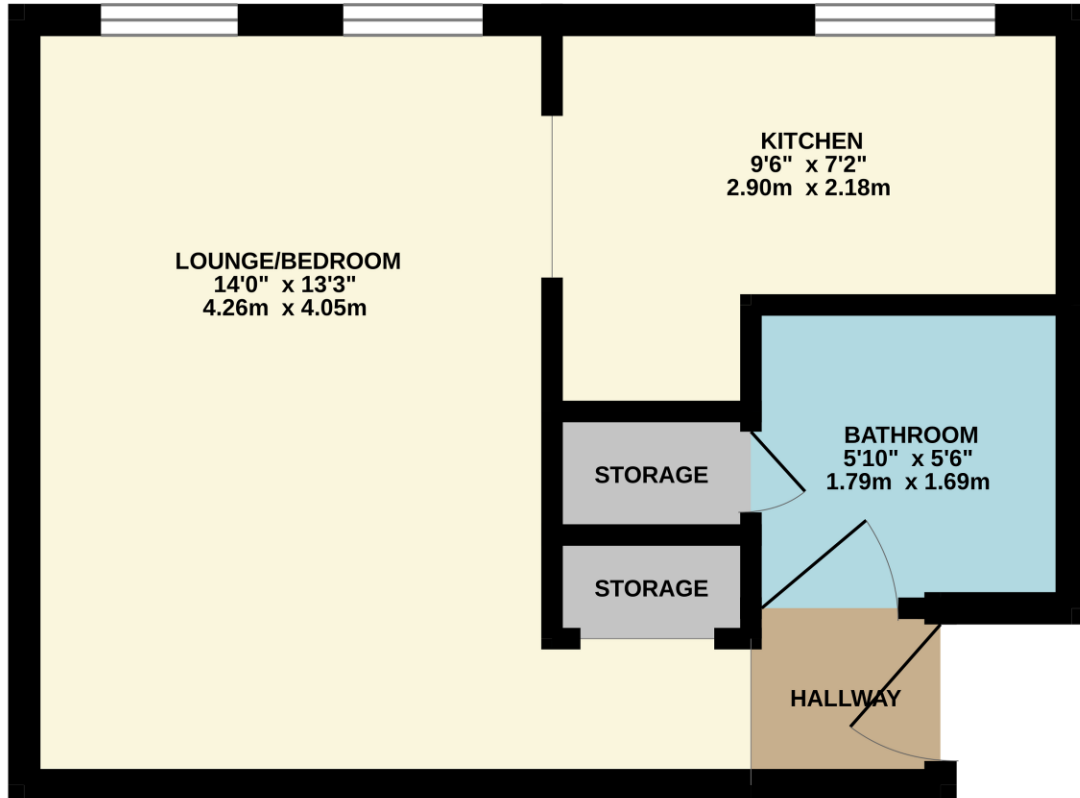

TOTAL FLOOR AREA : 260 sq.ft. (24.1 sq.m.) approx.

Whilst every attempt has been made to ensure the accuracy of the floorplan contained here, measurements of doors, windows, rooms and any other items are approximate and no responsibility is taken for any error, omission or mis-statement. This plan is for illustrative purposes only and should be used as such by any prospective purchaser. The services, systems and appliances shown have not been tested and no guarantee as to their operability or efficiency can be given.
Made with Metropix ©2024

Consumer Protection from Unfair Trading Regulations 2008.

The Agent has not tested any apparatus, equipment, fixtures and fittings or services and so cannot verify that they are in working order or fit for the purpose. A Buyer is advised to obtain verification from their Solicitor or Surveyor. References to the Tenure of a Property are based on information supplied by the Seller. The Agent has not had sight of the title documents. A Buyer is advised to obtain verification from their Solicitor. Items shown in photographs are NOT included unless specifically mentioned within the sales particulars. They may however be available by separate negotiation. Buyers must check the availability of any property and make an appointment to view before embarking on any journey to see a property.