



23 Hebden Close, Swindon

Swindon

£315,000

mcfarlane
property.com



23 Hebden Close

Swindon

Offered to the market is this spacious four-bedroom family home situated in the desirable location within Redhouse, North Swindon. The property offers flexible living accommodation which is split over three floors comprising of: a spacious newly fitted and beautifully spec'd open plan kitchen/diner, downstairs cloakroom, utility /family room, three double bedrooms of which the master accommodates an en-suite and built in wardrobes, Separate living room with Juliet balcony, further single bedroom, and modern family bathroom suite. Externally, the property also benefits from a sunny aspect rear garden, garage with above storage and off-road parking. Other benefits include air conditioning, gas central heating and double glazing throughout. Viewings are highly recommended.



- FOUR GOOD SIZE BEDROOMS
- BEAUTIFULLY PRESENTED THROUGHOUT
- GARAGE & PARKING
- EN-SUITE TO MASTER
- POPULAR LOCATION
- AIR CONDITIONING
- LANDSCAPED GARDEN



Outbuilding
Approx. 14.0 sq. metres (150.3 sq. feet)



Ground Floor
Approx. 36.6 sq. metres (394.3 sq. feet)

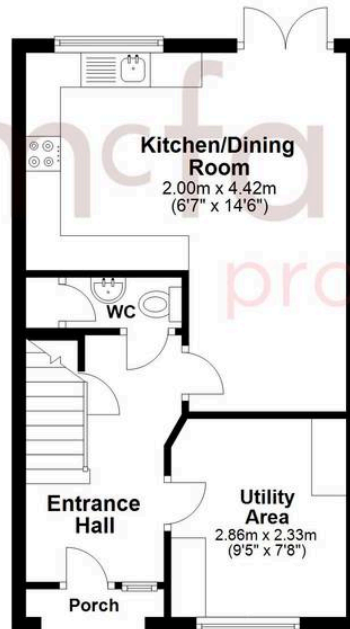

First Floor
Approx. 36.9 sq. metres (397.1 sq. feet)

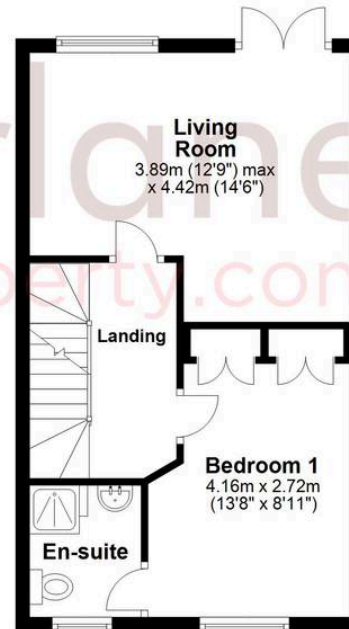

Second Floor
Approx. 37.5 sq. metres (403.7 sq. feet)

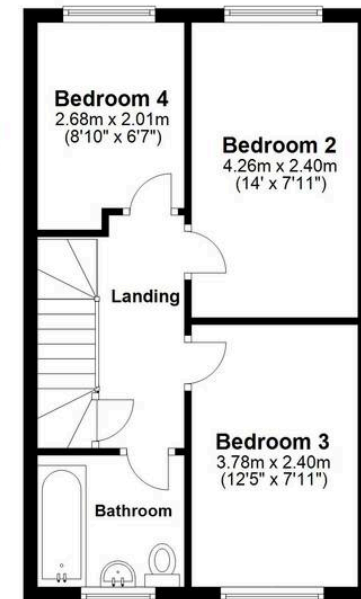

Total area: approx. 125.0 sq. metres (1345.3 sq. feet)

McFarlane Sales & Lettings

North Swindon, Redhouse Village Centre, Swindon - SN25 2FW

01793 296600 • swindon@mcfarlaneproperty.com • www.mcfarlaneproperty.com/