

Milan House
Charrington Place
St. Albans
AL1 3NT

 **2 Bedrooms**

 **2 Bath/Shower Rooms**

 **1 Reception Room – Open
Plan Lounge/Diner**

 **Allocated Parking
Available for an
Additional Charge (£161
per 6 months)**

 **Communal Garden**

 **EPC Band C**

Council Tax
Band: D £2,155.11 (2024/2025)
Local Authority: St Albans City &
District Council
Service Charge: £1,590 per annum
Ground Rent: £424.12 per annum

Guide Price
£360,000 Leasehold

 **ashtons**
for life's great moves

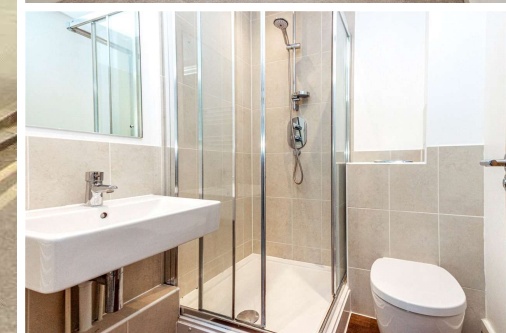

A newly decorated, two bedroom ground floor apartment in a convenient location. This property is offered to the market with the advantage of no onward chain and has an allocated parking space.

Description

Ideally positioned for access to the station, this well maintained ground floor apartment is positioned on the ground floor of a contemporary purpose-built building. Entrance is through a secure communal lobby and the front door opens into an entrance hall which gives access to an open-plan lounge/diner which has glazed doors to a small private terrace at the rear. The kitchen is at one end of the space, with wall and base units and several fitted appliances and there is ample room for living and dining furniture. The property has two bedrooms with bedroom one benefitting from a fitted wardrobe and an en-suite shower room. There is also a main bathroom with modern fittings and an allocated parking space is available for an additional charge.

Location

Milan House forms part of the Charrington Place development, close to the mainline station where there are fast rail links into central London. The wide range of amenities in St Albans city centre are within walking distance and Clarence Park is also nearby.

Tenure

Leasehold, 999 years from 30th June 2008

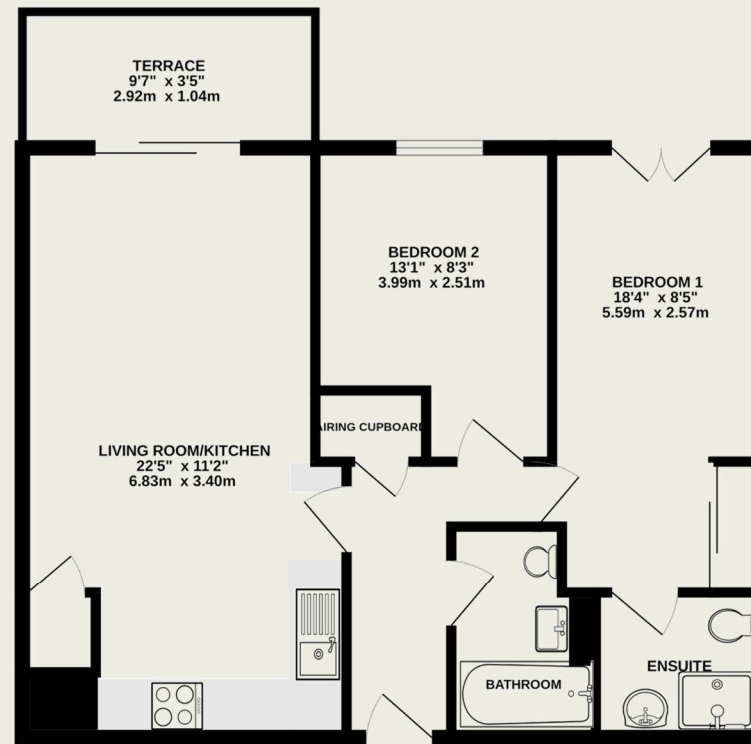

TOTAL FLOOR AREA : 622 sq.ft. (57.8 sq.m.) approx.

This floor plan is for illustrative purposes only. The measurement and position of each element is approximate and must be viewed as such

Important Information

These particulars do not constitute an offer or contract in whole or part. The statements contained herein are made without responsibility on the part of Ashtons or the vendors and they cannot be relied upon as representatives of fact. In respect of floor plans, these are for illustrative purposes only. The measurement and position of each element is approximate and must be viewed as such. Intending purchasers should therefore satisfy themselves by inspection or otherwise as to their correctness. The vendors do not make or give, and neither Ashtons nor any person in their employment has any authority to make or give, any representation or warranty whatsoever in relation to this property.

We offer a wide range of services through third-party providers including solicitors, surveyors, removal firms, mortgage providers and EPC suppliers. We receive additional payments for administering suppliers quoting software and making referrals. You are not under any obligation to use these services and it is your discretion whether you choose to deal with these parties or your own preferred supplier. You should be aware the average payment we received in 2021 equated to £48.36 per referral.