



Dekker, Clements Way

Shrivenham

£290,000



Dekker, Clements Way

Shrivenham

Welcome to this striking NEW HOME, a 2 Bedroom Mid-Terraced House located in the heart of a vibrant community. Boasting a spacious layout and modern design, this property is sure to captivate those seeking comfort and style. Enter into an inviting KITCHEN DINING ROOM, perfect for culinary creations and entertaining guests. The residence features a LARGE RECEPTION area flooded with natural light, enhancing the sense of openness and warmth. Convenience is key with a UTILITY room and a practical WC on the ground floor. The charm continues upstairs with an EN-SUITE to the MASTER bedroom, providing a private oasis, and a meticulously designed FAMILY BATHROOM for ultimate relaxation. With the added bonus of ALLOCATED PARKING, this MID TERRACE gem offers a perfect blend of functionality and charm.

With so much to offer both inside and out, this home ensures a lifestyle of comfort and style that is second to none. Don't miss this rare opportunity to make this exceptional property your own and experience the epitome of modern living.



- NEW HOME
- KITCHEN DINING ROOM
- LARGE RECEPTION
- UTILITY
- WC
- EN-SUITE TO MASTER
- FAMILY BATHROOM
- ALLOCATED PARKING
- MID TERRACE

Entrance Hall

Lounge

13' 8" x 12' 4" (4.17m x 3.75m)

Kitchen / Dining

9' 11" x 12' 2" (3.01m x 3.70m)

Utility

5' 7" x 3' 5" (1.70m x 1.05m)

WC

Landing

Bedroom 1

9' 5" x 10' 2" (2.86m x 3.10m)

En-suite

Bedroom 2

7' 10" x 15' 10" (2.40m x 4.83m)

Bathroom

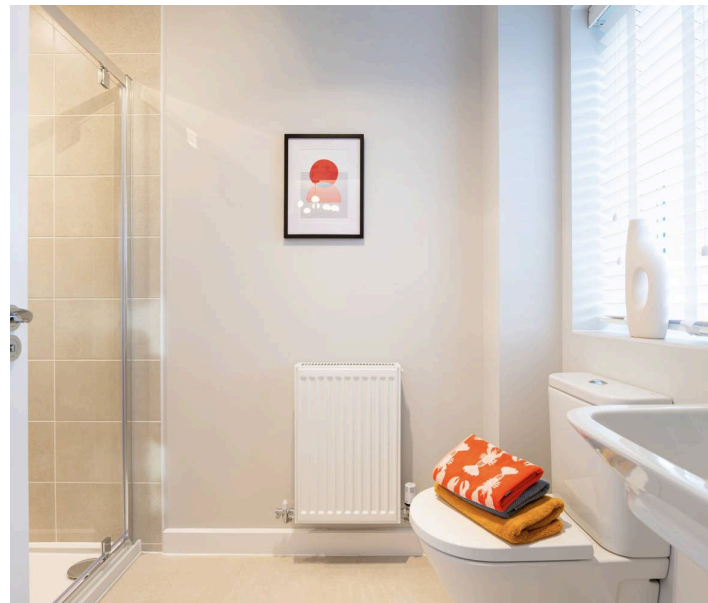

Ground Floor

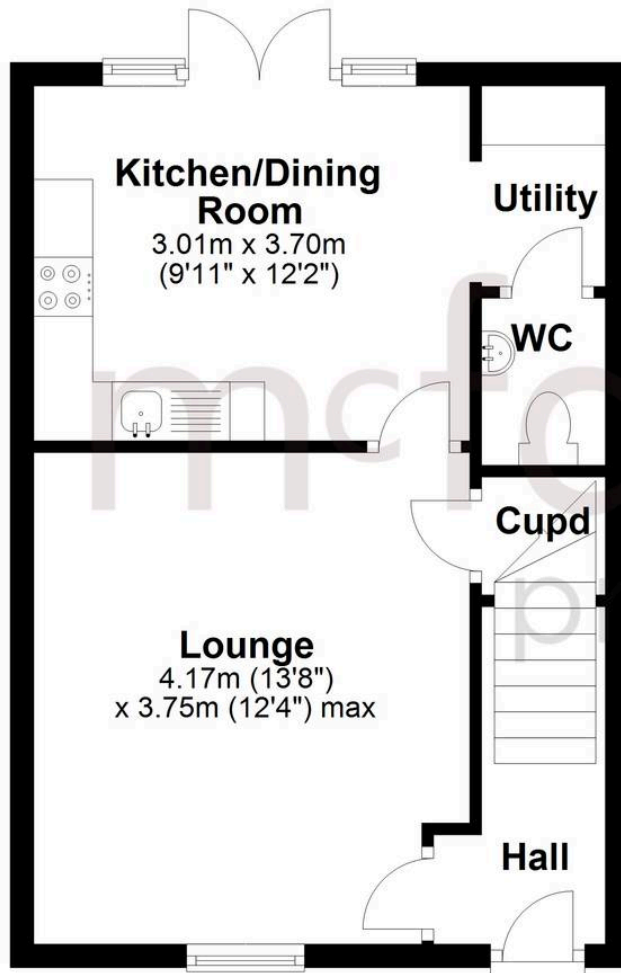

First Floor

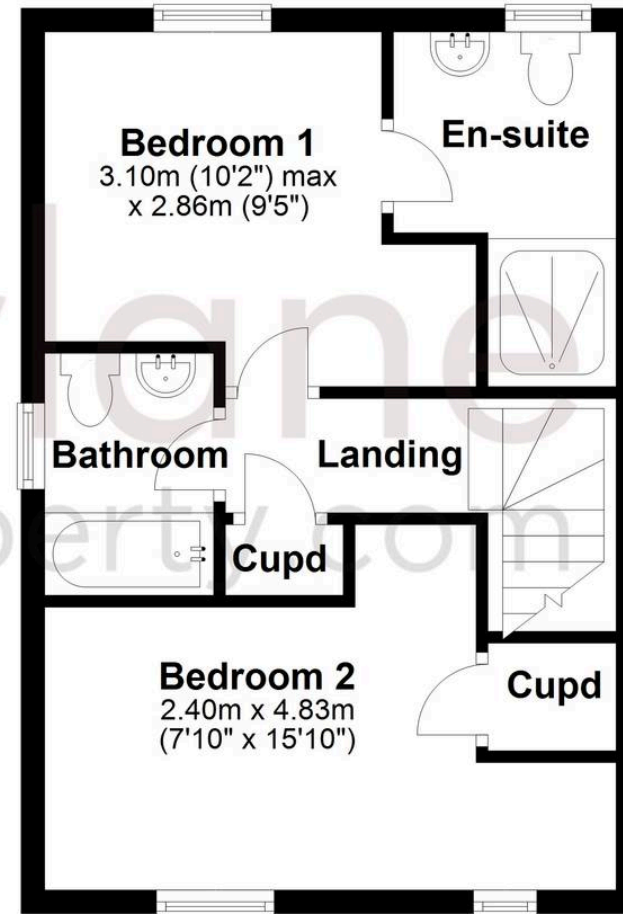

McFarlane Sales & Lettings

McFarlane Sales & Letting Ltd, 28-30 Wood Street - SN1 4AB

01793 296880 • oldtown@mcfarlaneproperty.com • www.mcfarlaneproperty.com/