



Seymours



The Green Camberley, GU17 0NT £450,000 Guide Price

Arrange a viewing: 01276 534100

Property Details

-  2 bedrooms
-  1 baths
-  EPC Rating TBC
-  772 sqft
-  Blackwater (0.8 miles)

- NO ONWARD CHAIN
- Two double bedrooms
- Two receptions
- Kitchen
- Shower room
- Attractive mature rear garden
- Scope and potential to extend subject to consents
- Council tax band D
- Overlooking the Green and close to beautiful countryside at Hawley Woods and Yateley Common

NO ONWARD CHAIN. A character semi detached cottage set within a picturesque location being ideally located in Frogmore and overlooking the green. The property itself at present is made up of two reception rooms, a kitchen and bathroom as well as two double bedrooms. To the rear of the house is an attractive mature rear garden. The property is in very liveable condition but could certainly be enlarged and refurbished subject to the usual consents.

[01276 534100](tel:01276534100) / james@seymours-blackwater.co.uk



Beckhampton Cottage

Approximate Gross Internal Area = 71.7 sq m / 772 sq ft

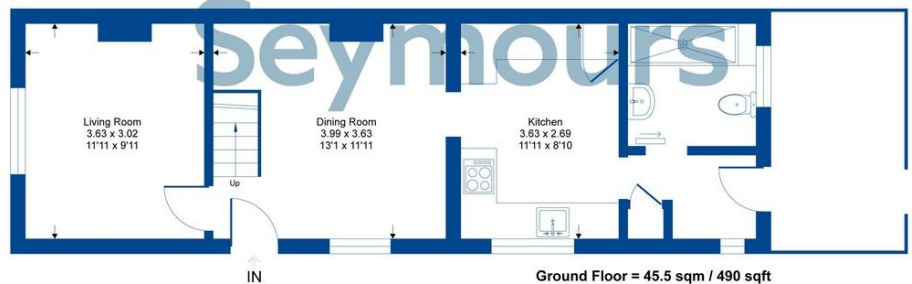
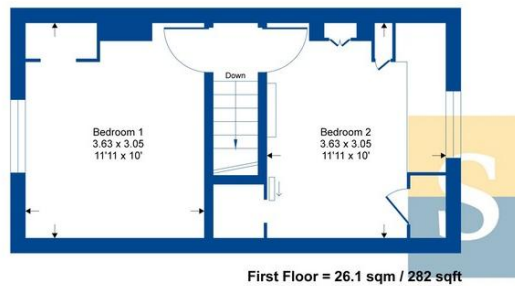

Whilst every attempt has been made to ensure the accuracy of the floor plan contained here, measurements of doors, windows, rooms and any other items are approximate and no responsibility is taken for any error, omission or mis-statement. This plan is for illustrative purposes only and should be used as such by any prospective purchaser.