



## 6 Penarth Rise, Nottingham - NG5 4EE

Guide Price £260,000 - £270,000



## 6 Penarth Rise

Nottingham, Nottingham

Delightful 3-bed semi-detached property with large front & rear garden, driveway, detached garage plus a spacious lounge, dining kitchen and modern shower room. All within easy reach of amenities!

Council Tax band: B

Tenure: Freehold

- Spacious semi-detached property on generous plot
- Popular location close to Sherwood and Mapperley's amenities
- Generous entrance hallway
- Bright and airy lounge perfect for family living
- Dining kitchen with patio doors to rear garden
- Two double bedrooms and one versatile third bedroom
- Modern shower room with Mira electric shower
- Landscaped rear garden, enclosed for privacy and an ideal space for relaxing or entertaining
- Large private driveway with a useful garage







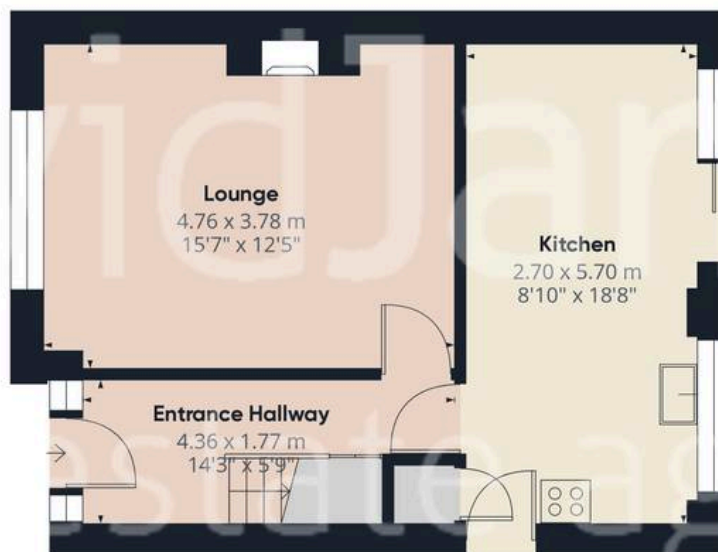

Floor 0 Building 1



Floor 1 Building 1

Approximate total area<sup>(1)</sup>

82.22 m<sup>2</sup>

885.02 ft<sup>2</sup>

(1) Excluding balconies and terraces

While every attempt has been made to ensure accuracy, all measurements are approximate, not to scale. This floor plan is for illustrative purposes only.

Calculations are based on RICS IPMS 3C standard.

GIRAFFE360



## David James Estate Agents

David James Estate Agents, 45B Plains Road – NG3 5JU

0115 962 4213 • [mapperley@david-james.com](mailto:mapperley@david-james.com) • [www.david-james.com](http://www.david-james.com)

These particulars are produced in good faith and are set out as a general guide only. Measurements are approximate and floor plans are for illustrative purposes only. Services have not been tested. We have established professional relationships with third-party suppliers for the provision of services to Clients, details of which can be found on the property listing page on our website.