

Chimney Crescent Irthlingborough

richard james

www.richardjames.net

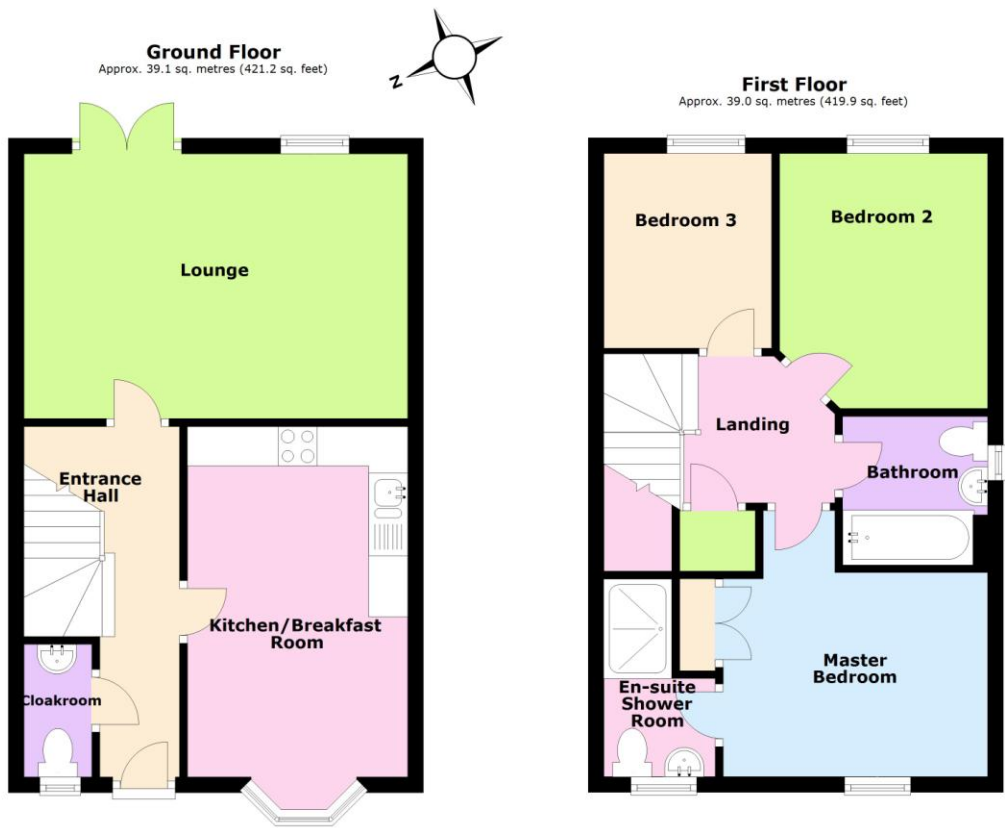

Chimney Crescent, Irthingborough NN9 5WF
Freehold Price £240,000

The information given in these particulars is intended to help you decide whether you wish to view this property and to avoid wasting your time in viewing unsuitable properties. We have tried to make sure that these particulars are accurate, but to a large extent we have to rely on what the seller tells us about the property. We do not check every single piece of information ourselves as the cost of doing so would be prohibitive and we do not wish to unnecessarily add to the cost of moving house. Once you find the property you want to buy, you will need to carry out more investigations into the property than it is practical or reasonable for an estate agent to do when preparing sales particulars. For example, we have not carried out any kind of survey of the property to look for structural defects and would advise any homebuyer to obtain a surveyors report before exchanging contracts. If you do not have your own surveyor, we would be pleased to recommend one. We have not checked whether any equipment in the property (such as central heating) is in working order and would advise homebuyers to check this. You should also instruct a solicitor to investigate all legal matters relating to the property (e.g. title, planning permission etc) as these are specialist matters in which estate agents are not qualified. Your solicitor will also agree with the seller what items (e.g. carpets, curtains etc) will be included in the sale.

Wellingborough Office ☐
27 Sheep Street Wellingborough
Northants NN8 1BS
01933 224400

Irthingborough Office ☐
28 High Street Irthingborough
Northants NN9 5TN
01933 651010

Rushden Office ☐
74 High Street Rushden
Northants NN10 0PQ
01933 480480



Situated in a cul de sac on the northern outskirts of Irthlingborough and constructed in 2014 by Persimmon Homes is this very well presented three bedroomed semi detached property with benefits to include uPVC double glazing, gas radiator central heating, built in stainless steel kitchen appliances and offers off road parking for two cars. The accommodation briefly comprises entrance hall, cloakroom, lounge, kitchen/dining room, three bedrooms with en suite shower room to master, bathroom, front and rear gardens and a driveway.

Entry via composite front door through to:

Entrance Hall

Stairs rising to first floor landing, pull out under stairs storage, radiator, laminate flooring, doors to:

Cloakroom

Two piece suite finished in white comprising of pedestal hand wash basin with tiled splash back, low flush W.C., radiator, tiled flooring, window to front aspect.

Lounge

11' 0" x 16' 1" (3.35m x 4.9m)

Window to rear aspect, French door to rear, radiator, TV point, telephone point.

Kitchen/Dining Room

16' 2" x 9' 10" (4.93m x 3m) (This measurement includes the area provided by the kitchen units)

Fitted to comprise one and half bowl stainless steel single drainer sink unit with cupboard under, a range of eye and base units providing work surfaces, built in stainless steel oven with four ring gas hob and extractor fan over, plumbing for washing machine and dishwasher, fridge/freezer space, tiled flooring, concealed wall mounted gas boiler serving domestic hot water and central heating systems, radiator, bay window to front aspect, TV point, stairs rising to:

First Floor Landing

Loft access, storage cupboard with shelving, doors to:

Bedroom One

11' 1" x 11' 1", " (Narrowing to 8'4) (3.38m x 3.38m)

Window to front aspect, radiator, build in double wardrobe, doors through to:

Ensuite Shower Room

Three piece suite comprising low flush W.C, pedestal hand wash basin, double shower cubicle with wall mounted chrome shower, chrome towel rail, tiled splash backs, window to front aspect, spotlights and extractor to ceiling, vinyl flooring.

Bedroom Two

8' 9" x 10' 9" (2.67m x 3.28m)

Window to rear aspect, radiator.

Bedroom Three

8' 3" x 7' 1" (2.51m x 2.16m)

Window to rear aspect, radiator.

Bathroom

Fitted to comprise low flush W.C, pedestal hand wash basin, panelled bath with shower attachment, tiled splash backs, window to side aspect, towel rail, vinyl flooring.

Outside Front - Garden is mainly lawn with border, laid with slate chippings.

Rear - Comprising paved patio, main lawn with raised border stocked with shrubs, wooden summer house, gated side pedestrian access, garden is enclosed by wooden panel fencing.

Driveway - Providing off-road parking for two cars, also note on the driveway there is a outside power point.

Energy Performance Rating

This property has an energy rating of TBC. The full Energy Performance Certificate is available upon request.

Council Tax

We understand the council tax is band B (£1805.89 per annum. Charges for 2024/2025).

Agents Note

Please be aware that some photographs used in our particulars are obtained using a wide-angle lens.

Conveyancing

We are able to offer a free quotation for your conveyancing from a panel of local solicitors or licensed conveyancers.

Offers

For offers to be submitted in the best light, the majority of vendors require us to confirm buyers have been financially qualified. We will require a Mortgage Certificate or Agreement In Principle (A.I.P.) and proof of deposit or cash. This information will be treated confidentially and will not be seen by any other party. We are obliged by law to pass on all offers to the vendors until contracts have been exchanged.

Money Laundering Regulations 2017 & Proceeds of Crime Act 2002

In order to comply with the above Regulations, an intending purchaser will be required to provide official I.D; proof of address, evidence of funding and source of deposit clearly showing the name of the account holder. If funds are being provided by a third party i.e. family, we will require the same from them too. We will verify clients identity electronically from the details provided. The information will be checked against various databases. This is not a credit check of any kind and does not affect credit history. We will retain a record on file.

General Data Protection Regulations 2018

Should you view or offer on this property, we will require certain pieces of personal information in order to provide a professional service to you and our client.

The personal information provided by you may be shared with the seller, but it will not be shared with any other third parties without your consent.

More information on how we hold and process your data is available on our website - www.richardjames.net

Mortgages

We are able to offer our clients mortgage advice through our association with an independent mortgage advisor. Written quotations are available on request. A life policy may be required.

YOUR HOME MAY BE REPOSSESSED IF YOU DO NOT KEEP UP REPAYMENTS ON YOUR MORTGAGE.

