



Cherry Hinton Road

0) 1223 508050

Lettings@cookecurtis.co.uk

www.cookecurtis.co.uk

A brand new one-bedroom, ground floor apartment on Cherry Hinton Road with an allocated parking space. Two miles from Cambridge City Centre.

£1,200 pcm

Cherry Hinton Road,
Cambridge, CB1 8DB



349 Cherry Hinton Road is a fantastic development of seven brand new properties each with a parking space. Approximately 1.3 miles from the train station, 1.2 miles to Addenbrookes and just over 2 miles into Central Cambridge it is ideally located for anyone working in Cambridge or needing to commute via train.

This property is the ground floor apartment at the front of the building, still set back from the road. It has its own front door rather than using a communal entrance.

It has an open plan kitchen / living room. The kitchen is fitted with white goods; there is a fridge, a freezer, washer / dryer, full size dishwasher, electric hob, oven and microwave.

The bathroom is to the right of the entrance, this is fully tiled and comprises a walk-in shower, WC and basin.

At the front of the property is the double bedroom, this is a good-size double with plenty of natural light from the bay window.

This property would share the communal courtyard (also housing the bicycle and bin storage) and has one allocated parking space. Unfurnished. Electric heating.

Available mid March to a professional couple or single occupant.

Video tour available.







44.6 sqm / 480 sqft

1 bed, 1 recep, 1 bath

Council tax - B

EPC - C / 76

Unfurnished

One allocated parking space

Ground floor apartment

Available March 2025



Flat ONE

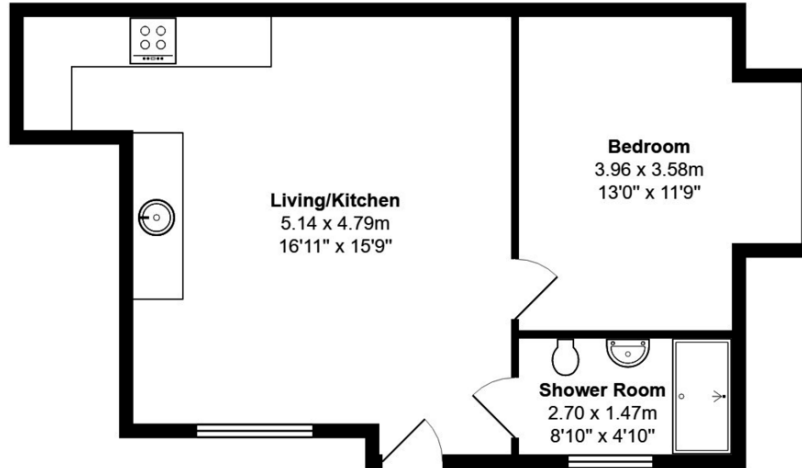

Total Area: 44.6 m² ... 480 ft²

All measurements are approximate and for display purposes only

Plan prepared by charlesjharrison.co.uk

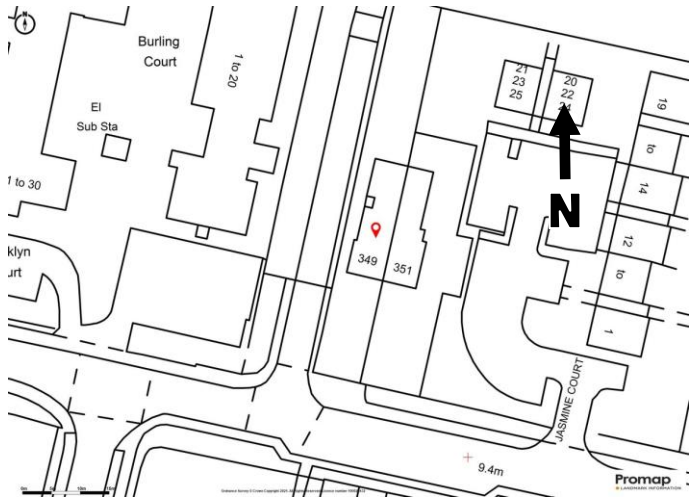

Cherry Hinton Road takes you from the city all the way to the village of Cherry Hinton. The road itself has an excellent range of facilities including nearby doctors and dentists surgeries, restaurants and take-aways. Mill Road, one of the country's top 50 suburbs and its' cosmopolitan shops, delis and restaurants, Addenbrookes Hospital and biomedical campus and the main train station are all just over a mile away and easily accessible on foot or by bicycle.

COOKE
CURTIS
& CO