



Bartlams.

---

103 Hazel Grove, Wombourne - WV5 9EH  
£215,000



## 103 Hazel Grove

Wombourne, Wolverhampton

Bartlams are delighted to bring to the market this charming one-bedroom bungalow, perfectly tucked away on a quiet estate in the heart of Wombourne. Situated within walking distance of the High Street and its array of amenities, and just a short drive to Wolverhampton and surrounding areas, this property offers a convenient yet peaceful location.

The bungalow boasts a modern exterior, beautifully maintained with landscaped features, a driveway for off road parking, and a gravelled front. Upon entering, you are welcomed into a cosy entrance hall that provides access to all areas of the home. The property features a stylish, modern kitchen with integrated appliances, a spacious double-length lounge filled with natural light from the double patio doors leading to the rear garden, and a generously sized double bedroom, offering ample space and versatility. The bathroom is well-appointed, complete with a shower cubicle, bath, sink, and WC, making excellent use of the available space.

The rear garden is a lovely mix of paved and lawned areas, complemented by a small shed for additional storage. Ready to move into, this well-maintained property offers modern living in a sought-after location.

We are advised by our client that this property is:  
Freehold, Council Tax Band - C, EPC - tbc



B.





Approx Gross Internal Area  
49 sq m / 531 sq ft

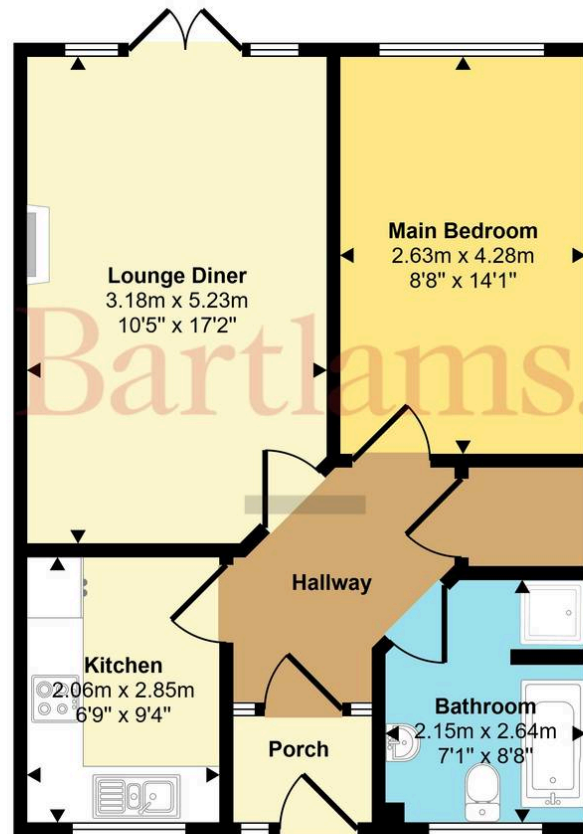

Floorplan

# Bartlams

Bartlams Ltd, The House On The Green High Street - WV5 9DP

01902894141

wombourne@bartlams.co.uk

www.bartlams.co.uk/

NOTICE: These particulars, although believed to be correct, do not constitute any part of an offer or contract. All statements contained in these particulars as to this property are made without responsibility and are not to be relied upon as statements or representations of warranty whatsoever in relation to property. Any intending purchaser must satisfy themselves by inspection or otherwise as to the correctness each of the statements contained in these particulars. All measurements are approximate and for illustrative purposes only. Photographs are produced for general information and it must not be inferred that any item shown is included in the sale. DISCLOSURE: As a professional Estate Agency our clients employ us to look after their best interests. This includes providing them with full details of offers made to purchase their property. To ensure our obligations to our clients are met we need to check the status of all potential purchasers. If you make an offer on this property we will ask a member of The Finance Family to contact you to verify your status. They are a leading firm of Independent Financial Advisers and Mortgage Brokers. Should they transact any business resulting from our introduction then we may receive a commission.

