



# Squires Court, Canterbury Gardens

Salford



£130,000

# Squires Court

Salford

**\*\*Includes Lease Extension\*\*** This **STYLISH** two bedroom apartment is located on the popular Canterbury Gardens, just a stone's throw from Ladywell Tram Stop!  
Council Tax band: A

Tenure: Leasehold

- Stylish Two Bedroom Apartment
- Benefitting from a Lease Extension
- Located on the Popular Canterbury Gardens Development
- Just a Stone's Throw from Ladywell Tram Stop, with Direct Access into Salford Quays, Media City and Manchester City Centre
- Two Double Bedrooms
- Stylish Fitted Kitchen
- Modern Three-Piece Shower Room
- Well-Maintained Communal Gardens
- Communal Parking
- Within Easy Access of Amenities - Early Viewing is Advised!



HILLS



### Entrance Hallway

Complete with a ceiling light point, wall mounted radiator and laminate flooring.

### Lounge / Diner

13' 11" x 12' 4" (4.24m x 3.77m)

Complete with a ceiling light point, double glazed window and wall mounted radiator. Fitted with carpet flooring.

### Kitchen

9' 11" x 7' 11" (3.03m x 2.41m)

Featuring complementary fitted units. Space for a freestanding oven, washing machine and dryer. Complete with a ceiling light point, double glazed window and cushioned flooring.

### Bedroom One

12' 1" x 11' 0" (3.68m x 3.35m)

Complete with a ceiling light point, double glazed window and wall mounted radiator. Fitted with carpet flooring.

### Bedroom Two

13' 5" x 8' 1" (4.10m x 2.47m)

Complete with a ceiling light point, double glazed window and wall mounted radiator. Fitted with carpet flooring.

### Shower Room

7' 2" x 6' 10" (2.18m x 2.09m)

Featuring a three piece suite including shower, hand wash basin and W.C. Complete with a ceiling light point, double glazed window and heated towel rail. Fitted with part tiled walls and cushioned flooring.



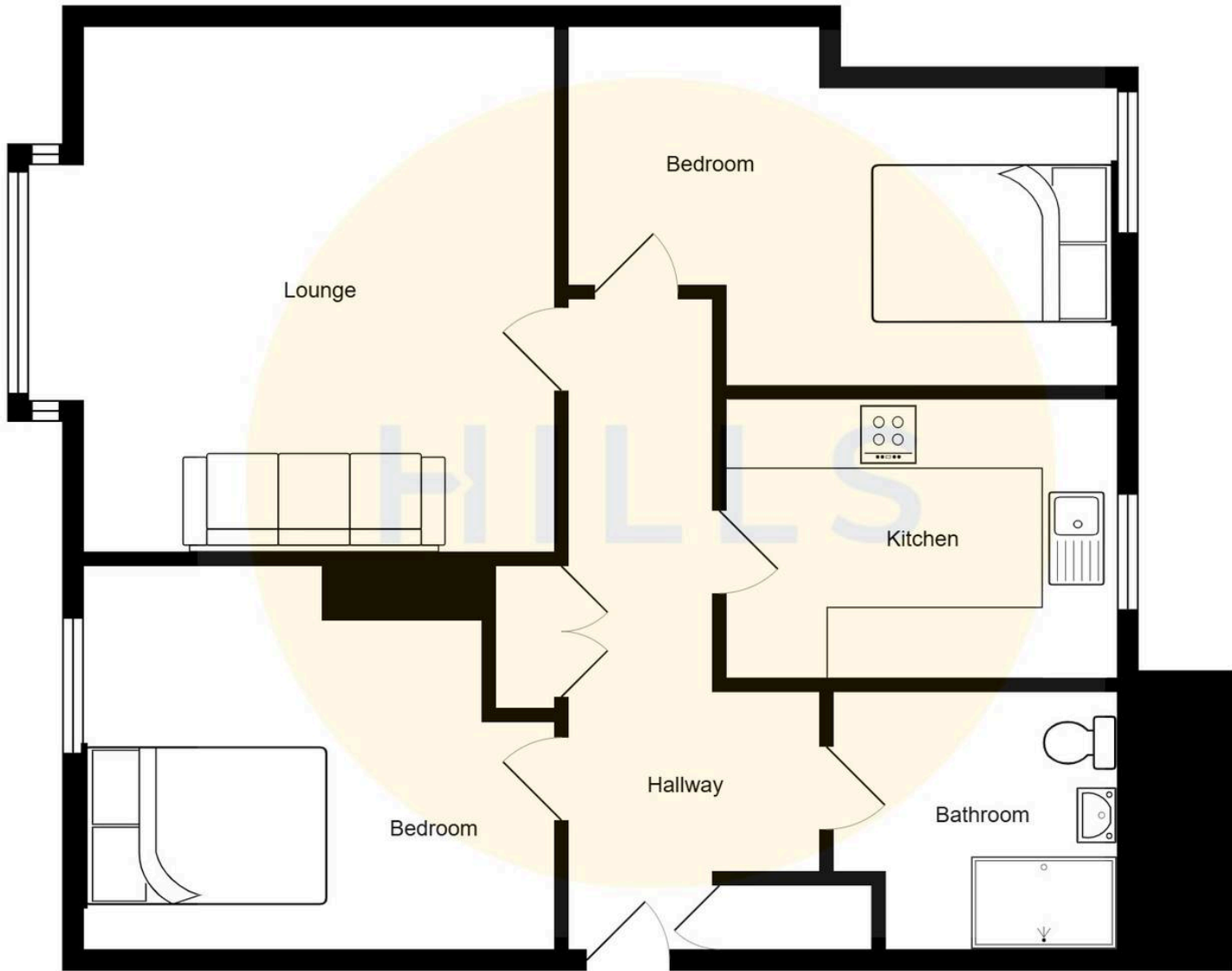



## Hills | Salfords Estate Agent

Hills Residential, Sentinel House Albert Street - M30 0SS

0161 707 4900

[sales@hills.agency](mailto:sales@hills.agency)

[www.hills.agency/](http://www.hills.agency/)



THE PROPERTY MISDESCRIPTIONS ACT 1991 The Agent has not tested any apparatus, equipment, fixtures and fittings or services and so cannot verify that they are in working order or fit for the purpose. A Buyer is advised to obtain verification from their Solicitor or Surveyor. References to the Tenure of a Property are based on information supplied by the Seller. The Agent has not had sight of the title documents. A Buyer is advised to obtain verification from their Solicitor. You are advised to check the availability of this property before travelling any distance to view. Every effort and precaution has been made to ensure these particulars are correct and not misleading but their accuracy is not guaranteed nor do they form part of any contract. If there is any point which is of particular importance to you, please contact us and we will provide any information you require. This is advisable, particularly if you intend to travel some distance to view the property. The mention of any appliances and services within these details does not imply that they are in full and efficient working order. These particulars are in draft form awaiting Vendors confirmation of their accuracy. These details must therefore be taken as a guide only.