



21 Pembroke Street, Swindon

Swindon

£210,000

mcfarlane

21 Pembroke Street

Swindon, SN1

McFarlane Sales & Lettings are delighted to present this characterful Victorian bay-fronted, two bedroom mid terrace home nestled in the sought-after heart of Old Town. The property welcomes you with a light filled living room featuring a bay window, a spacious dining area, and a well-appointed kitchen leading to a family bathroom at the rear. Upstairs, you'll find two generously sized bedrooms, one benefiting from built-in storage. Additional features include gas central heating, a private enclosed rear garden, and superb access to local schools, shops, cafes, and picturesque walking routes. A wonderful opportunity for first-time buyers or investors alike.





21 Pembroke Street

Swindon, SN1

McFarlane Sales & Lettings proudly present this bay-fronted, two bedroom mid terrace in sought-after Old Town. Featuring a bright living room, spacious dining area, well appointed kitchen, and family bathroom, plus two generous bedrooms, gas central heating, and an enclosed garden. Close to schools, shops, cafés, and scenic walks.

Council Tax band: B

Tenure: Freehold



- TWO DOUBLE BEDROOMS
- SPACIOUS LIVING AND DINING
- VICTORIAN BUILT
- BAY FRONTED
- NO CHAIN
- ENCLOSED REAR GARDEN

Ground Floor

Approx. 45.3 sq. metres (487.4 sq. feet)

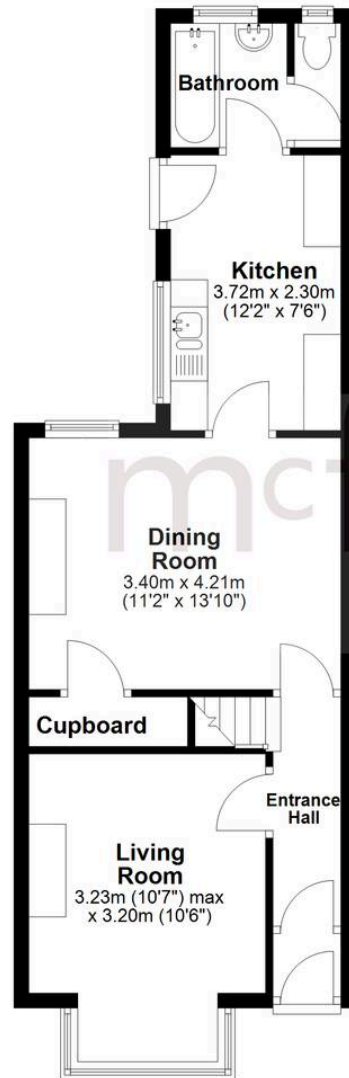

First Floor

Approx. 31.6 sq. metres (339.7 sq. feet)



Total area: approx. 76.8 sq. metres (827.1 sq. feet)

McFarlane Sales & Lettings

McFarlane Sales & Letting Ltd, 28-30 Wood Street – SN1 4AB

01793 296880 • oldtown@mcfarlaneproperty.com • www.mcfarlaneproperty.com/

mcfarlane
property.com