

JOHN DALE

kw POWERED BY
KELLERWILLIAMS



Beachville Court, Brighton Road, BN15 8JU





I(John Dale powered by Keller Williams) I am delighted to offer for sale this LOVELY FIRST FLOOR APARTMENT for the over 60's with views over the WONDERFUL and TRANQUIL COMMUNAL GARDENS. The property is located opposite LANCING's BEAUTIFUL SEAFRONT.

INTERNALLY, entrance hall with built in cupboard and alarm chord. Lounge with dining area and double glazed windows to the rear as well as an alarm chord. Fitted kitchen with space for appliances, double glazed windows to the rear and alarm chord. Bedroom with fitted wardrobes, double glazed windows to the rear and alarm chord. Shower room comprising white suite with step in shower cubicle, wash hand basin, low level WC and alarm chord.

EXTERNALLY, there is a wonderful communal garden to the rear of the building which is shaded and keeps away the direct sunlight and strong winds. To the front of the building is the residents parking area.

ADDITIONALLY, the McCarthy & Stone development offers a communal lounge, laundry room, guest bedroom and onsite manager/s. The resident of Beachville Court arrange weekly activities, meaning you always have something to do if you wish.

Please dial extension 777 to contact John Dale directly.

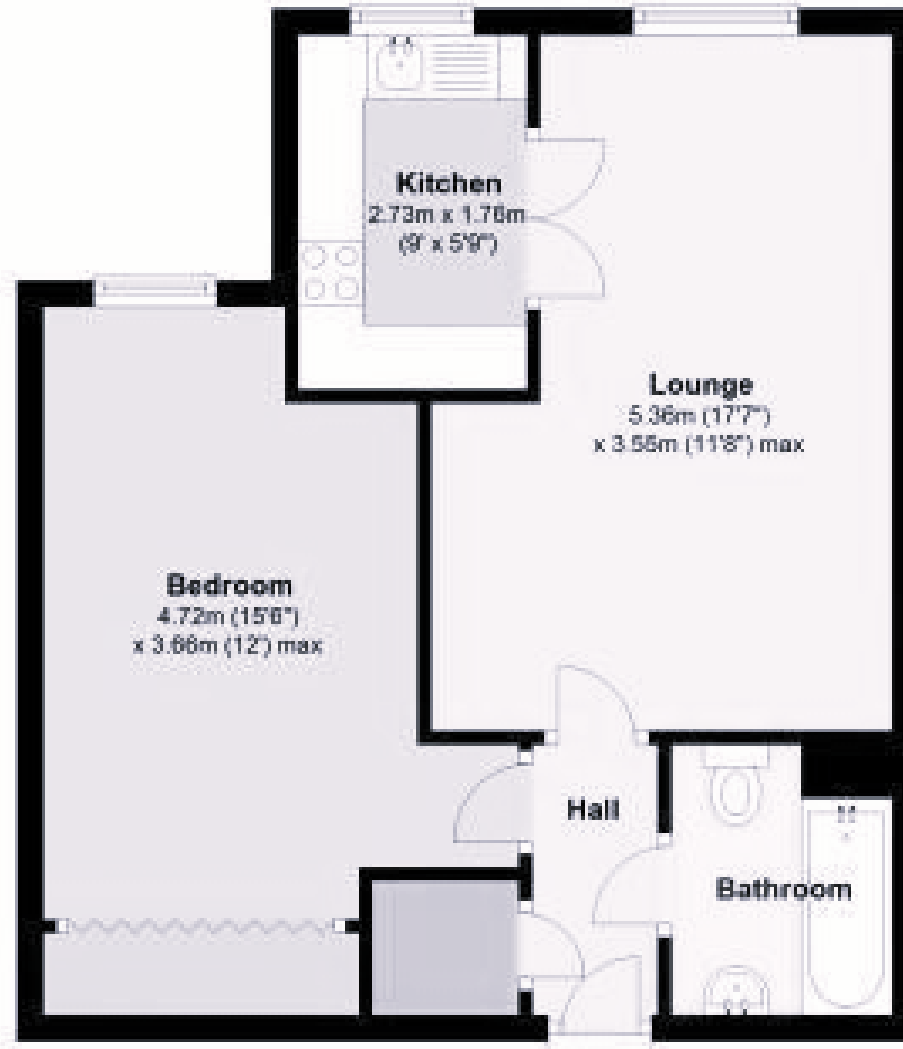

Total area: approx. 45.2 sq. metres (486.1 sq. feet)

JOHN DALE

kw POWERED BY
KELLERWILLIAMS

