



Williams Way, Longwick - HP27 9RP

Offers Over £635,000

 **TIM RUSS**  
& Company





## Williams Way

Longwick, Princes Risborough

- VILLAGE LOCATION
- FAMILY HOME
- FOUR BEDROOMS
- TWO BATHROOMS
- GARAGE & DRIVEWAY PARKING
- MODERN KITCHEN
- LARGE LIVING SPACE & DINING ROOM





# Williams Way

Longwick, Princes Risborough

Positioned towards the end of a cul-de-sac in a popular village is this four bedroom family home with spacious accommodation throughout. This light and airy home features a large living room, conservatory, study and a large outbuilding which can be accessed internally via the garage/store and from the garden. Additionally on the ground floor there is a cloakroom and the modern kitchen.

To the first floor can be the family bathroom with four good sized bedrooms with the largest benefitting from an en-suite.

Outside there is ample parking to the front with a generous rear garden which is laid mainly to lawn and offers a good degree of privacy.

Council Tax band: F

Tenure: Freehold

EPC Energy Efficiency Rating: D

EPC Environmental Impact Rating: E



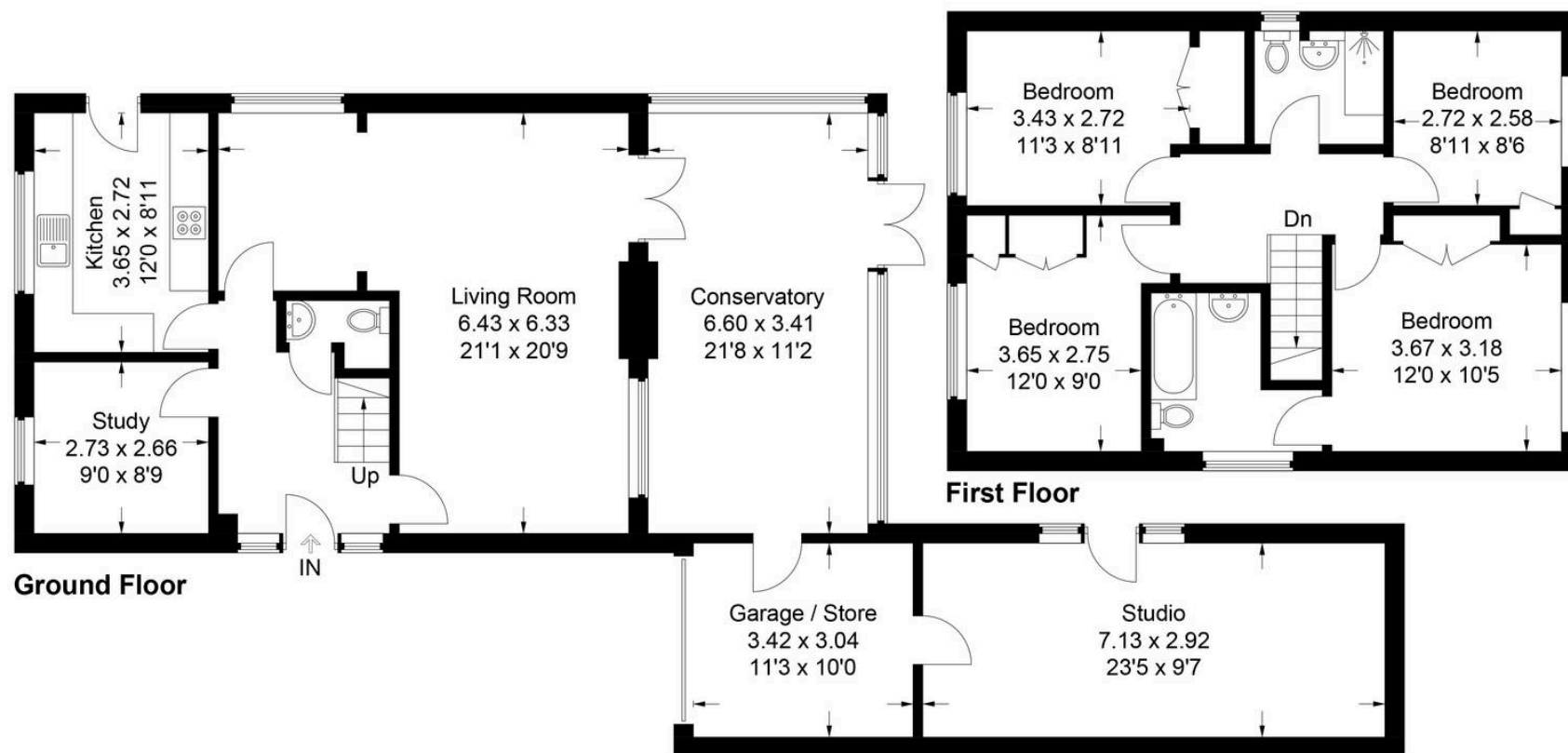

Approximate Gross Internal Area  
 Ground Floor = 114.0 sq m / 1,227 sq ft  
 First Floor = 58.0 sq m / 629 sq ft  
 (Including Garage / Store / Studio )  
 Total = 172.0 sq m / 1,855 sq ft

This plan is for layout guidance only. Not drawn to scale unless stated. Windows and door openings are approximate. Whilst every care is taken in the preparation of this plan, please check all dimensions, shapes and compass bearings before making any decisions reliant upon them.  
 © CJ Property Marketing Ltd Produced for Tim Russ & Company

**Tim Russ and Company**

1 High Street, Princes Risborough - HP27 0AE

01844 275522 • p.risborough@timruss.co.uk • timruss.co.uk/

