



30 Station Road, Ormesby

£585,000 Freehold

Welcome to this exceptional detached home, offering the perfect blend of comfortable and contemporary living. Sitting in the popular village of Ormesby, in close proximity to all local amenities and natural surroundings. On arrival is a grand first impression, with a large driveway and double garage. Its accommodation consists of four reception rooms, a modern bathroom and four double bedrooms, including a luxury principal with an ensuite. This property has the presence of a south-facing garden, perfect for your summertime hosting.

Council Tax band: F

Tenure: Freehold

Welcome to this exceptional detached home, offering the perfect blend of comfortable and contemporary living. Sitting in the popular village of Ormesby, in close proximity to all local amenities and natural surroundings. On arrival is a grand first impression, with a large driveway and double garage. Its accommodation consists of four reception rooms, a modern bathroom and four double bedrooms, including a luxury principal with an ensuite. This property has the presence of a south-facing garden, perfect for your summertime hosting.

Location

Ormesby village is located at the heart of the Trinity Broads, known for sailing, boating and fishing with rich birdlife and natural beauty. There is a wide range of local amenities including small shops, restaurants, pubs, schools and a doctor's surgery - everything you need to enjoy relaxing village life. Access to both Norwich (approx. 20 miles) and Great Yarmouth (approx. 4 miles) is provided by the A47, London and motorways are accessed by the A12 from Great Yarmouth and the A11 from Norwich, within walking distance to the beautiful sandy beaches of both



Welcome to this exceptional detached home, offering the perfect blend of comfortable and contemporary living. Sitting in the popular village of Ormesby, in close proximity to all local amenities and natural surroundings. On arrival is a grand first impression, with a large driveway and double garage. Its accommodation consists of four reception rooms, a modern bathroom and four double bedrooms, including a luxury principal with an ensuite. This property has the presence of a south-facing garden, perfect for your summertime hosting.

Location



Welcome to this exceptional detached home, offering the perfect blend of comfortable and contemporary living. Sitting in the popular village of Ormesby, in close proximity to all local amenities and natural surroundings. On arrival is a grand first impression, with a large driveway and double garage. Its accommodation consists of four reception rooms, a modern bathroom and four double bedrooms, including a luxury principal with an ensuite. This property has the presence of a south-facing garden, perfect for your summertime hosting.

Location

Ormesby village is located at the heart of the Trinity Broads, known for sailing, boating and fishing with rich birdlife and natural beauty. There is a wide range of local amenities including small shops, restaurants, pubs, schools and a doctor's surgery - everything you need to enjoy relaxing village life. Access to both Norwich (approx. 20 miles) and Great Yarmouth (approx. 4 miles) is provided by the A47, London and motorways are accessed by the A12 from Great Yarmouth and the A11 from Norwich, within walking distance to the beautiful sandy beaches of both Caister and Scratby.

Station Road

Upon arrival at this exceptional detached home, there is a grand first impression that continues to impress throughout. The large brickweave driveway provides off-road parking for all family members and visitors, whilst the double garage offers additional parking or additional storage space. Bordering the driveway are a variety of plants and hedging, enhancing the exterior aesthetics, while a small front lawn adds a touch of greenery.

Step inside where you are instantly greeted by a welcoming entrance hall, leading you from the outside world into the sanctum of the home. Located at the front of the property is a spacious sitting room, where you can showcase your most comfortable furniture and decorative items, inviting you to relax and unwind. The dining room can be versatile, to adapt to your own needs. The current owners use it as a beauty room, allowing you to run your business from home.

At the heart of the home lies an incredible open plan kitchen/garden room, ensuring effortless interaction when hosting and the busy family lifestyle. The well-equipped kitchen is fitted with units and appliances to enhance your cooking experience. Seamlessly transitioning over to the garden room, with wonderful views of the exterior, where you can socialise with family and friends. Its complimented by a utility room, for your everyday essentials and laundry goods.

Ascend the staircase to the gallery landing, where you will find four double bedrooms, designed to offer you relaxation and privacy.



GROUND FLOOR

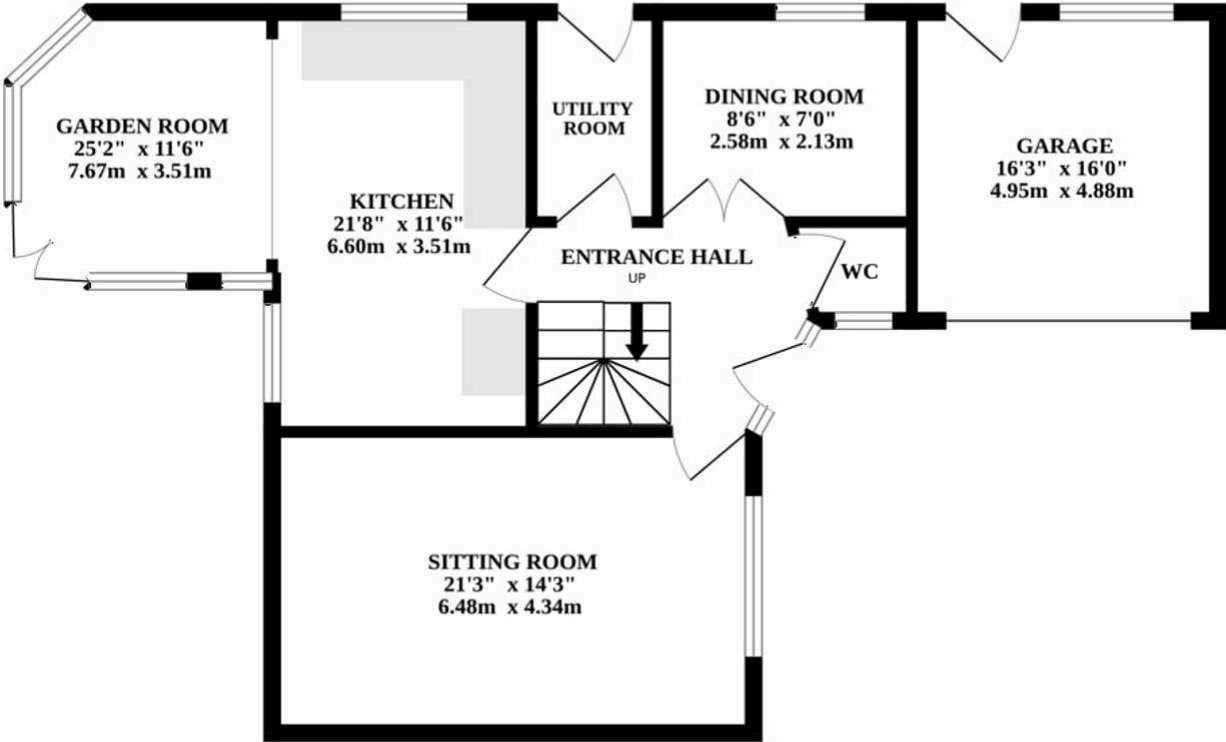

You can include any text here. The text can be modified upon generating your brochure.

