



## 12 Church Row, WARE – SG12 9ER

£175,000 Leasehold

Top floor 1-bed town centre apartment near Ware amenities and train station. Includes storage, living room, bedroom with wardrobe, kitchen, bathroom, double glazing, and parking. No chain.



## Second Floor

Approx. 36.5 sq. metres (392.9 sq. feet)

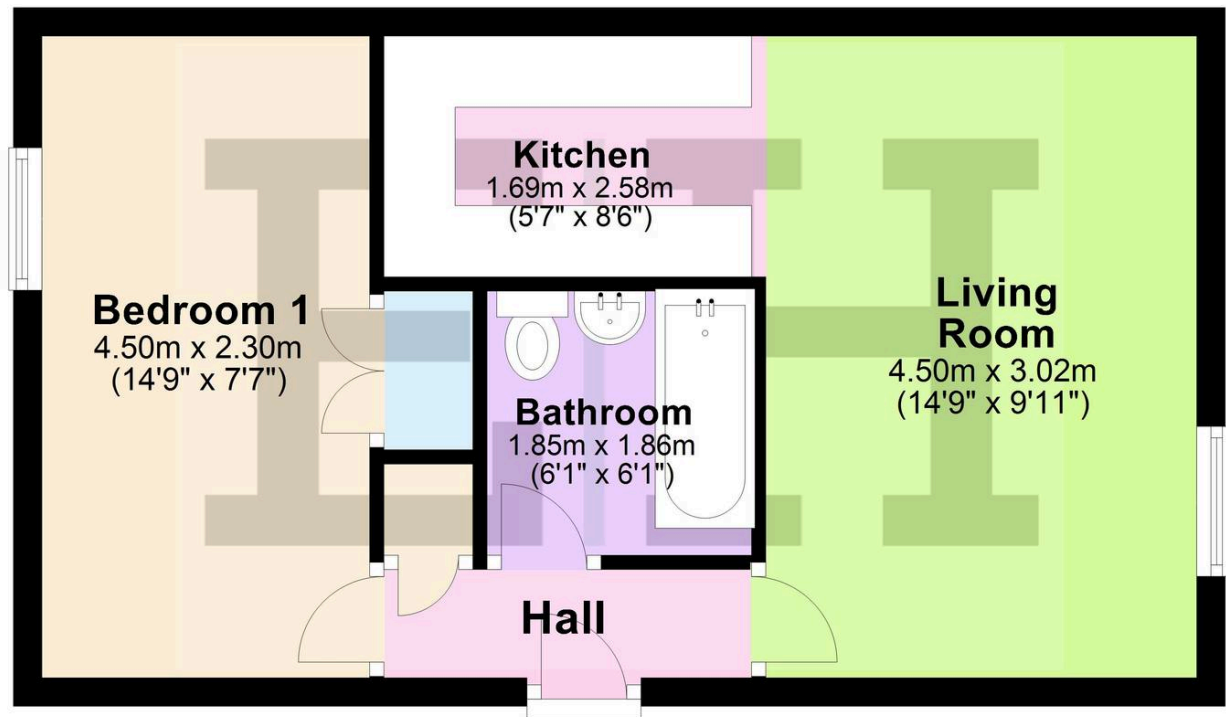

Total area: approx. 36.5 sq. metres (392.9 sq. feet)

Elliot Heath are pleased to offer this top floor one bedroom town centre apartment situated within walking distance of Ware's many amenities & train station which services London's Liverpool Street. The property offers a spacious entrance hall with built in storage, spacious living room, double bedroom with fitted wardrobe cupboard, kitchen, bathroom, double glazing throughout and allocated residents parking. Being offered with no onward chain. Call Elliot Heath on 01920 293333 to arrange your appointment to view.

Council Tax band: B

Tenure: Leasehold