



24 Haven Court Southampton Road, Hythe
£274,000

ANTHONY JAMES
PROPERTIES



24 Haven Court Southampton Road

Hythe, Southampton

This beautifully presented first floor apartment boasts an excellent position within the prestigious McCarthy & Stone development, tailored for the over 60s seeking a fulfilling lifestyle. The development offers a well-presented, peaceful environment including landscaped gardens, a residents' lounge, washing facilities and the option for guests to stay on site within a guest bedroom (subject to availability and charges). There is also the option for car parking on site. Please enquire with the house manager for further information.

The apartment itself features exceptionally spacious accommodation, highlighted by two generous double bedrooms, two shower rooms (one ensuite), and a large lounge/dining room with a separate kitchen, ideal for modern living. Noteworthy attributes include a south-westerly facing 'Juliet' balcony, recent redecoration, new carpets, underfloor heating and large storage cupboards.

Service charge £353.50 per month

Ground rent £495.00 per year

Council Tax band: C

Tenure: Leasehold



1 Southward House
Dibden Purlieu SO45 4PT



T: 02380 844405

info@anthonyjamesproperties.co.uk



GROUND FLOOR

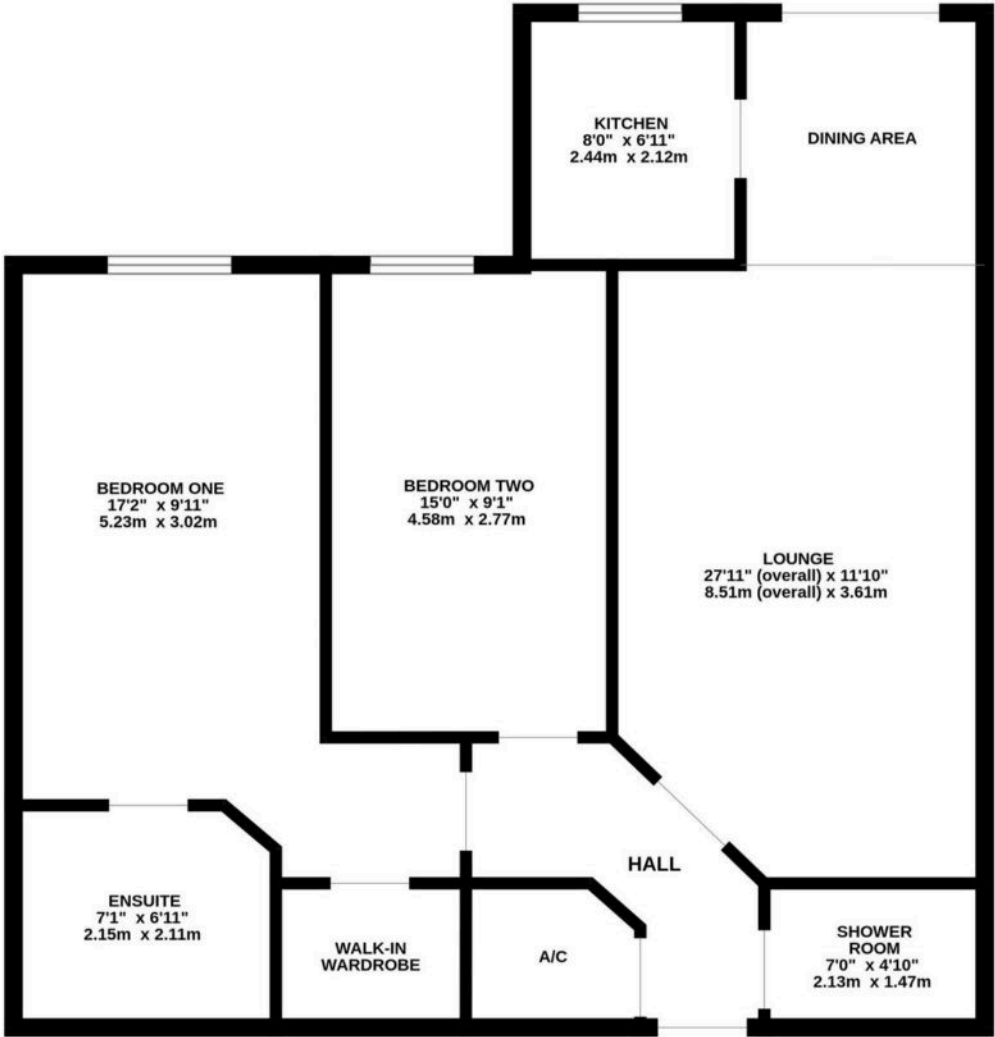

Whilst every attempt has been made to ensure the accuracy of the floorplan contained here, measurements of doors, windows, rooms and any other items are approximate and no responsibility is taken for any error, omission or mis-statement. This plan is for illustrative purposes only and should be used as such by any prospective purchaser. The services, systems and appliances shown have not been tested and no guarantee as to their operability or efficiency can be given.
Made with Metropix ©2025