



Cricklewood Lane, London NW2

£1,850 pcm

Welcome to Cricklewood Lane, a bright and spacious two-bedroom first-floor apartment available to let immediately. Situated in the heart of NW2, this well-proportioned home offers comfortable living in a vibrant and well-connected area. The apartment features two generously sized bedrooms, a spacious living area, a well-equipped kitchen, and a modern bathroom. Offered unfurnished, it provides a blank canvas for tenants to make it their own. Cricklewood is a thriving neighborhood known for its excellent transport links, with Cricklewood Thameslink Station just a short walk away, offering fast connections into Central London. The area is also well-served by numerous bus routes and is within easy reach of Willesden Green and Kilburn Underground stations. Residents will enjoy the convenience of nearby shops, cafes, and restaurants, as well as the green open spaces of Gladstone Park and Hampstead Heath, perfect for outdoor activities. The area also benefits from good local schools and amenities, making it a great choice for professionals, couples, or small families. This fantastic apartment is available now and ready for immediate occupancy. Contact us today to arrange a viewing.

- Two bedroom apartment
- Available now
- Excellent condition
- Unfurnished
- 795 sq ft
- Open-plan kitchen / living area
- Great location
- Viewing recommended
- Bright and airy
- Close to transport

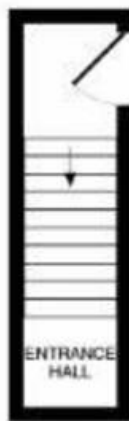

1ST FLOOR
APPROX. FLOOR
AREA 47 SQ.FT.
(4.4 SQ.M.)



2ND FLOOR
APPROX. FLOOR
AREA 748 SQ.FT.
(69.5 SQ.M.)

CRICKLEWOOD LANE NW2
TOTAL APPROX. FLOOR AREA 795 SQ.FT. (73.9 SQ.M.)

Floorplans are for identification and guideline purposes only. Not to scale. Compliant with RICS
code of measuring practice Floor plan supplied by CPN Clerk Limited.
Made with Metaphor 60076

MONEY LAUNDERING REGULATIONS 2003: Intending purchasers will be asked to produce identification documentation at a later stage and we would ask for your co-operation in order that there will be no delay in agreeing the sale.

General: While we endeavour to make our sales particulars fair, accurate and reliable, they are only a general guide to the property and, accordingly, if there is any point which is of particular importance to you, please contact the office and we will be pleased to check the position for you, especially if you are contemplating travelling some distance to view the property.

Measurements: These approximate room sizes are only intended as general guidance. You must verify the dimensions carefully before ordering carpets or any built-in furniture.

Services: Please note we have not tested the services or any of the equipment or appliances in this property, accordingly we strongly advise prospective buyers to commission their own survey or service reports before finalising their offer to purchase.