

Altura Tower, Bridges Wharf

London, SW11 3GZ

PROPERTY SUMMARY

A stunning bright 12th-floor one-bedroom apartment with breathtaking River Thames views. Spacious, with a high-spec kitchen, winter garden, and air conditioning. Set in award-winning Bridges Wharf with 24hr concierge and great transport links. Heating, hot water & water rates included.

1



1



1





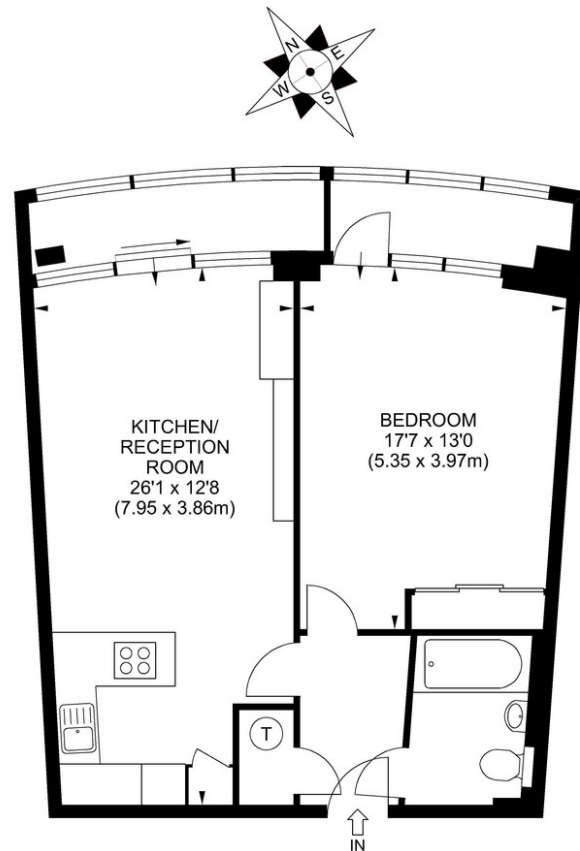

TWELFTH FLOOR

APPROX. GROSS INTERNAL FLOOR AREA 624 SQ FT / 58 SQ M

Illustration for identification purposes only, not to scale
All measurements are maximum, and includes wardrobes and window bays where applicable
Prepared by Pixangle © . Tel 020 8870 2118 www.pixangle.com

LOCAL AUTHORITY
Wandsworth Borough Council

TENURE

COUNCIL TAX BAND
Band E

VIEWINGS
By prior appointment only

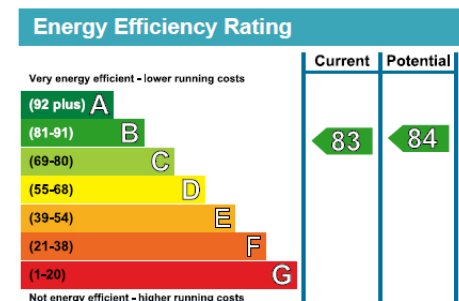

Agents Note: Whilst every care has been taken to prepare these particulars, they are for guidance purposes only. All measurements are approximate and are for general guidance purposes only and whilst every care has been taken to ensure their accuracy, they should not be relied upon and potential buyers/tenants are advised to recheck the measurements



4 Vicentia Court
Bridges Wharf
London
SW11 3GY

02073522455
info@hgproperty.co.uk
www.hgproperty.co.uk